

CERTIFIED RECORD OF LAND CORNER MONUMENTATION

HISTORY OF ORIGINAL CORNER ESTABLISHED:

Corner not previously established

T 1 S R 39 E X-20

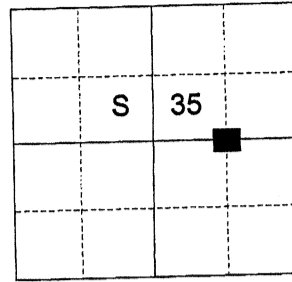

DESCRIPTION OF CORNER EVIDENCE FOUND:

None

SEE SURVEY NUMBER 029-2024

DESCRIPTION OF MONUMENT AND ACCESSORIES I ESTABLISHED TO MONUMENT THE ORIGINAL LOCATION OF THIS CORNER:

At position determined by survey, I set a 5/8" x 30" iron pin, 28" in the ground, with a 2 1/2" aluminum cap, from which:

NEW BEARING OBJECTS:

A 4" Ponderosa Pine bears North 46° East, a dist. of 17.15 ft, marked CE 1/16 S35 BT
A 7" Ponderosa Pine bears North 72° West, a dist. of 10.40 ft, marked CE 1/16 S35 BT

Set steel fencepost 0.5 ft. North

I hereby certify that the corner was monumented on August 13th, 2024.

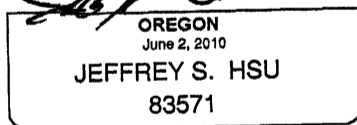
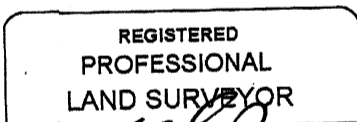
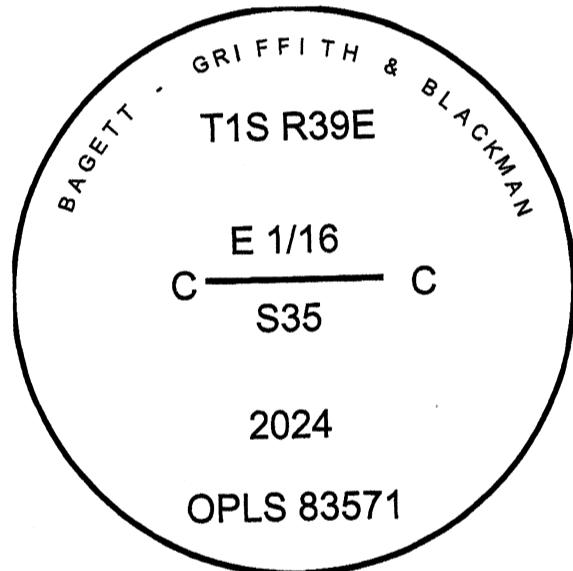

Renewal Date: June 30, 2025

Witnesses: Kyle Tucker,
Adam Gordon

I use a tape and compass in the establishment of the new bearing objects. 14° East was used for declination and measured to a brass washer labeled "OPLS 83571" in the BT blaze at the base of the tree. Distances are to a 60D nail in the right side of the base of the center of the tree.

