

**CERTIFIED RECORD OF LAND CORNER MONUMENTATION**

V-23

**History of original corner establishment:**

Survey was performed by David W. Thompson, Deputy Surveyor, under Contract No. 103, dated Sept. 3, 1863. He states he marked a pine 10" dia. for  $\frac{1}{4}$  sec. cor. mkd.  $\frac{1}{4}$  S on N face from which:

- A pine 8" dia. bears N 27, 17 lks. dist. mkd.  $\frac{1}{4}$  S BT.
- A pine 12" dia. bears S 5 E, 86 lks. dist. mkd.  $\frac{1}{4}$  S BT.

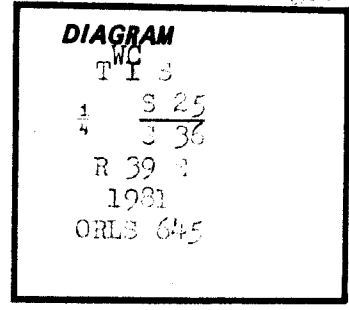

**Description of corner evidence found:**

At the assumed corner location I found a pine 20" (10") dia. with  $\frac{1}{4}$  S mkd. on the N face. Tree is alive and in good condition. Also I found both bearing trees alive and in good condition, however there is some discrepancy in the CLO notes for the tree in section 36.

- A pine 14" (8") dia. bears N 02 E, 11.22' (17 lks.) dist. (horiz. dist.) scribed  $\frac{1}{4}$  S BT.
- A pine 19" (12") dia. bears S 15 E (S 5 E), 62.18' (94 lks.) rather than 86 lks.) Horiz. dist.).

**Description of monument and accessories I established to perpetuate the original location of this corner:**

Since the  $\frac{1}{4}$  corner is a pine tree alive and in good condition, I set a Witness Corner along the east-west line on a bearing of S 89 24 E, 5.0' from the center of the existing tree. The witness corner being a 2 $\frac{1}{2}$ " brass cap on a 30" galv. iron pipe 6" above the ground surface, with a large mound of rocky soil around and covering the monument on a 25% side slope. I did not set new bearing trees; I only measured the bearings and distances to the existing bearing trees. From witness corner to existing bearing trees;

- A pine 14" (8") dia. bears N 20 W, 12.2' (horiz. dist.); original scribing is  $\frac{1}{4}$  S BT.
  - A pine 19" (12") dia. bears S 12 E, 61.30' (horiz. dist.); original scribing is  $\frac{1}{4}$  S BT.
- Bearings and distances are measured to face of bearing trees as was done in the original survey.

REGISTERED  
PROFESSIONAL  
LAND SURVEYOR

*James H. Hambleton*  
4-29-81

OREGON  
JULY 10, 1964  
JAMES H. HAMBLETON  
645

Office of..... County of.....  
State of..... I hereby certify that the within instrument was filed in this office  
for record on the..... day of....., 19.....

..... by .....  
(COUNTY OFFICIAL) (DEPUTY)

**UNION COUNTY  
SURVEYOR**

---

Date Received \_\_\_\_\_  
☆ GPO-798-276

Date Filed \_\_\_\_\_

By \_\_\_\_\_

File No. 115-84 R

**UNION COUNTY SURVEYOR**

**CERTIFIED RECORD OF LAND CORNER MONUMENTATION**

**HISTORY OF ORIGINAL CORNER ESTABLISHMENT:**

Corner originally established by J. Kimbrell under special instructions dated June 16, 1888. Surveyor General records states:  
Scribed 1/4S on the North face of a 10" Pine for the quarter corner between sections 25 and 36. From which a 8" Pine bears N2°E 171lks marked 1/4S B.T. And a 12" Pine bears S5°E 86lks marked 1/4S B.T.

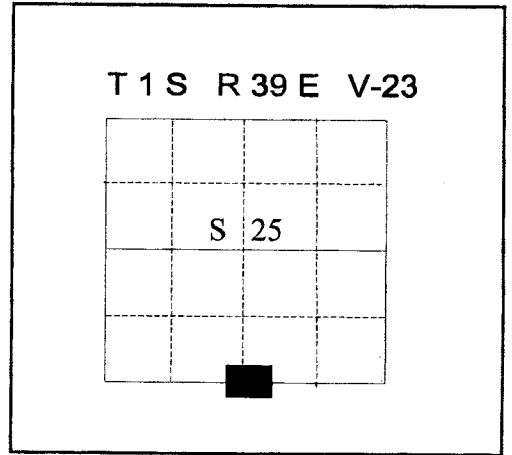

**DESCRIPTION OF CORNER EVIDENCE FOUND:**

18 1/2" Pine stump with 1/4S on North face for corner. Also a 16" Pine with visible scribes, dead and down bearing N2°E a distance of 171lks and a 18" Pine snag standing visible scribes a distance of 86lks.

**DESCRIPTION OF MONUMENT AND ACCESSORIES I ESTABLISHED TO PERPETUATE THE ORIGINAL LOCATION OF THIS CORNER:**

I set a 2 1/2 x 30" aluminum accessory marked as shown below for a reference monument 6.22 feet West of the existing corner (stump) from which;

**NEW BEARING OBJECTS:**

- A 6" Ponderosa Pine N89°E, 30.25 feet, marked X BT.
- A 7" Douglas Fir bears S13°W, 30.30 feet, marked 1/4 S36 BT.
- A 7" Ponderosa Pine bears S83°W, 38.65 feet, marked X BT.
- A 12" Douglas Fir bears N5°W, 25.20 feet, marked 1/4 S25 BT.

I hereby certify that the corner was monumented on June 16, 2000.  
Witness: Gregory T. Blackman and Greg T. Blackman Jr.

REGISTERED  
PROFESSIONAL  
LAND SURVEYOR

OREGON  
JULY 13, 1973  
**GREGORY T. BLACKMAN**  
991

Renewal Date: Dec. 31, 2001

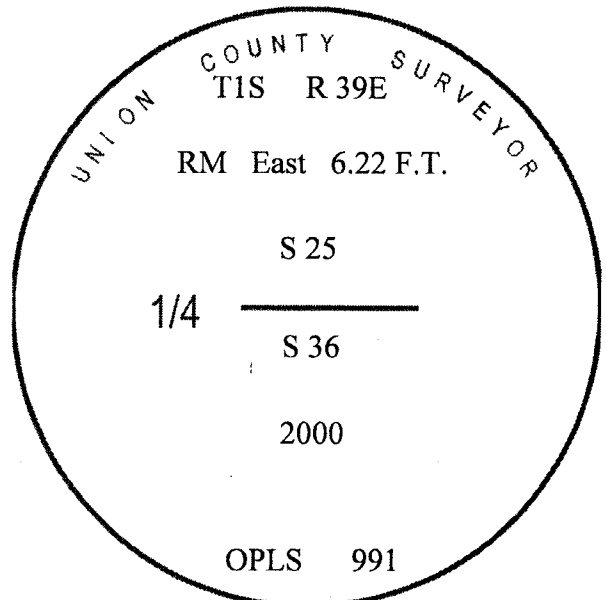

**UNION COUNTY SURVEYOR**

Date Received 7/13/00

Date Filed 7/15/00

Filed By R. Robinson, Deputy

File Number 004-2000R

I used a steel tape and magnetic compass in the establishment of the new accessories. I used 19° East declination, the distances are to a 60d spike driven into the right side of the root crown of the bearing tree.

**UNION COUNTY SURVEYOR**

**CERTIFIED RECORD OF LAND CORNER MONUMENTATION**

**HISTORY OF ORIGINAL CORNER ESTABLISHMENT:**

Corner originally established by J. Kimbrell under special instructions dated June 16, 1888. Surveyor General records states:  
Scribed 1/4S on the North face of a 10" Pine for the quarter corner between sections 25 and 36. From which a 8" Pine bears N2°E 17lks marked 1/4S B.T. And a 12" Pine bears S5°E 86lks marked 1/4S B.T.

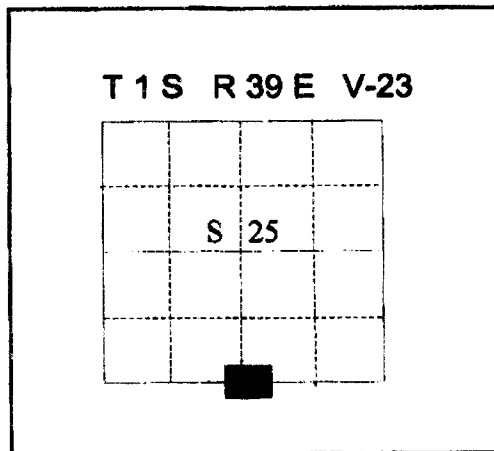

**DESCRIPTION OF CORNER EVIDENCE FOUND:**

18 1/2" Pine stump with 1/4S on North face for corner. Also a 16" Pine with visible scribes, dead and down bearing N2°E a distance of 17lks and a 18" Pine snag standing visible scribes a distance of 86lks.

**DESCRIPTION OF MONUMENT AND ACCESSORIES I ESTABLISHED TO PERPETUATE THE ORIGINAL LOCATION OF THIS CORNER:**

I set a 2 1/2 x 30" aluminum accessory marked as shown below for a reference monument 6.22 feet West of the existing corner (stump) from which;

**NEW BEARING OBJECTS:**

- A 6" Ponderosa Pine N89°E, 30.25 feet, marked X BT.
- A 7" Douglas Fir bears S13°W, 30.30 feet, marked 1/4 S36 BT.
- A 7" Ponderosa Pine bears S83°W, 38.65 feet, marked X BT.
- A 12" Douglas Fir bears N5°W, 25.20 feet, marked 1/4 S25 BT.

I hereby certify that the corner was monumented on June 16, 2000.  
Witness: Gregory T. Blackman and Greg T. Blackman Jr.

REGISTERED  
PROFESSIONAL  
LAND SURVEYOR

*Gregory T. Blackman*

OREGON  
JULY 12, 1973  
GREGORY T. BLACKMAN  
991

Renewal Date: Dec. 31, 2001

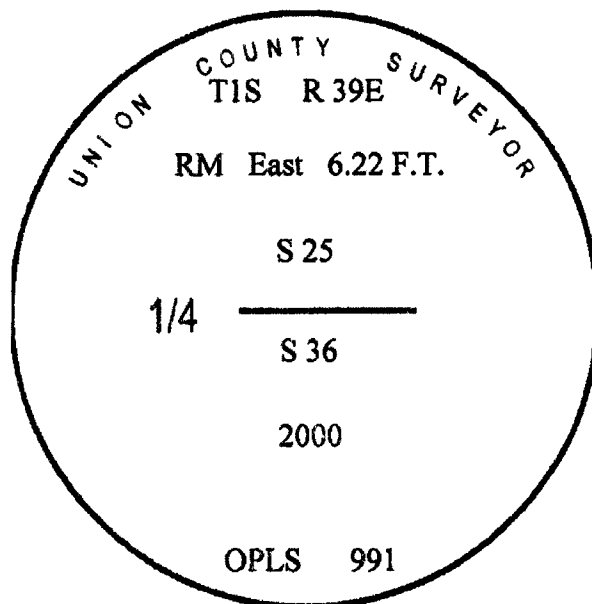

UNION COUNTY  
SURVEYOR

Date Received 8/24/2000

Date Filed 8/24/2000

Filed By R. ROBINSON, Deputy

File Number 016-2000R

I used a steel tape and magnetic compass in the establishment of the new accessories. I used 19° East declination, the distances are to a 60d spike driven into the right side of the root crown of the bearing tree.