

**CERTIFIED RECORD OF LAND CORNER MONUMENTATION**

**HISTORY OF ORIGINAL CORNER ESTABLISHED:**

Corner originally established by David P. Thompson under GLO Contract Number 103, dated July 3rd, 1863. Surveyor General Field Notes state:

Set post for corner to sec 34,35,26, and 27 in mound of stone

In 1976, as noted on Union County Survey #74-76, James Voelz found tag on tree and mound of stone

T 1 S R 39 E V-17

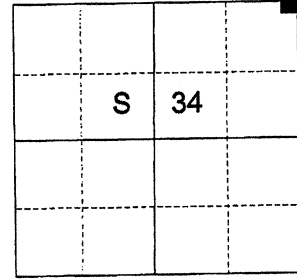

**DESCRIPTION OF CORNER EVIDENCE FOUND:**

Found Oregon Board of Forestry loc. tag marked "sec. cor. 15' W" on Ponderosa Pine initialed by forester Knowles on March 31<sup>st</sup> 1954. Found 3 ft. diam. mound of stone with orange painted center at noted location on forestry tag.

SEE SURVEY NUMBER 019-2023

**DESCRIPTION OF MONUMENT AND ACCESSORIES I ESTABLISHED TO MONUMENT THE ORIGINAL LOCATION OF THIS CORNER:**

At center of found mound of stone I set a 2 1/2" x 30" aluminum pipe, 22 inches in the ground, with 3" aluminum cap marked as shown in 3 ft. diam. mound of stone

**NEW BEARING OBJECTS:**

A 5/8" x 15" iron pin bears North 15°45' East, a dist. of 60.58 feet, with 1 1/2" aluminum cap marked BGB SURVEY MARKER NE RP

A 2'x5'x5' rock outcrop bears South 41° East, a dist. of 21.40 feet, marked X BO

A 5/8" x 15" iron pin bears South 30°42' West, a dist. of 53.15 feet, with 1 1/2" aluminum cap marked BGB SURVEY MARKER SW RP

A 5/8" x 15" iron pin bears North 44°29' West, a dist. of 24.53 feet, with 1 1/2" aluminum cap marked BGB SURVEY MARKER NW RP

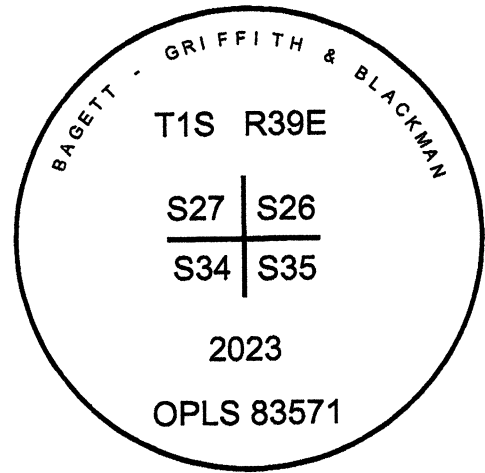

I hereby certify that the corner was monumented on August 1st, 2023.

Witness: Kyle Tucker, Adam Gordon

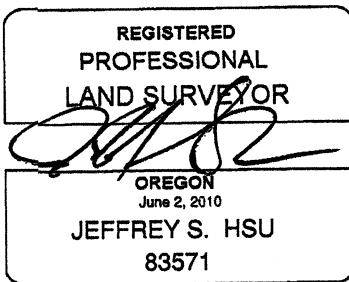

Renewal Date: June 30, 2025

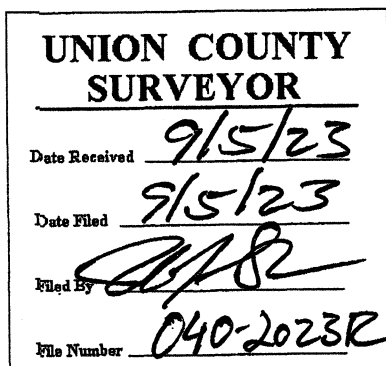

I used a tape and compass in the establishment of the stone outcrop accessory. Bearing and distance is measured to the center of the chiseled X using a magnetic declination of 14° East. Bearing and distances to the iron pin accessories were measured using a Leica GS 18 with RTK and are measured to the center of the aluminum caps.