

CERTIFIED RECORD OF LAND CORNER MONUMENTATION

HISTORY OF ORIGINAL CORNER ESTABLISHED:

Corner originally established by David P. Thompson under GLO Contract Number 103, dated July 3rd, 1863. Surveyor General Field Notes state:

Set post for 1/4 sec cor in mound of stone

In Survey Number 10, Voelz found the original 1/4 corner.

T 1 S R 39 E T-17

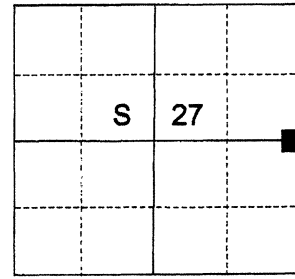

DESCRIPTION OF CORNER EVIDENCE FOUND:

None. Position falls on side slope of forest road.

SEE SURVEY NUMBER 019-2023

DESCRIPTION OF MONUMENT AND ACCESSORIES I ESTABLISHED TO MONUMENT THE ORIGINAL LOCATION OF THIS CORNER:

At proportionate position, I set a 5/8" x 15" iron pin with 1 1/2" aluminum cap, 15 inches in the ground marked as shown below, from which:

NEW BEARING OBJECTS:

- A 10" Ponderosa Pine bears North, a dist. of 23.60 feet, marked 1/4 S26 BT
- A 17" Ponderosa Pine bears South 48° East, a dist. of 60.95 feet, marked 1/4 S26 BT
- A 6" Ponderosa Pine bears South 56° West, a dist. of 43.55 feet, marked 1/4 S27 BT
- A 8" Ponderosa Pine bears North 64° West, a dist. of 27.00 feet, marked 1/4 S27 BT

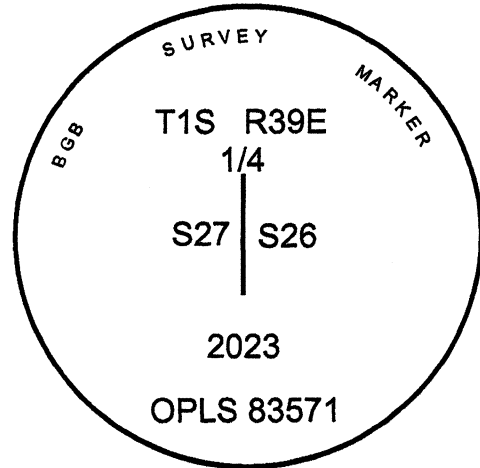

I hereby certify that the corner was monumented on August 1st, 2023.

Witness: Kyle Tucker, Adam Gordon

REGISTERED
PROFESSIONAL
LAND SURVEYOR

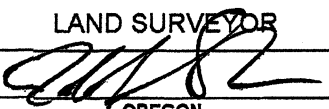

OREGON
June 2, 2010
JEFFREY S. HSU
83571

Renewal Date: June 30, 2025

I used a tape and compass in the establishment of the new accessories. Bearing is measured to a brass washer labeled OPLS 83571 located at the center of BT blaze, with a declination of 14° East. Distance is measured to a 60d spike nailed to the right side base of tree.

UNION COUNTY
SURVEYOR

Date Received 9/5/23

Date Filed 9/5/23

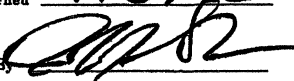
Filed By 

File Number 038-2023R