

**CERTIFIED RECORD OF LAND CORNER MONUMENTATION**

**HISTORY OF ORIGINAL CORNER ESTABLISHED:**

Corner originally established by David P. Thompson under GLO Contract Number 103, dated July 3rd, 1863. Surveyor General Field Notes state:

Set post for 1/4 sec corner from which:

- A Pine 24 in. diam bears S38°W 64 lks dist
- A Pine 10 in. diam bears S43°E 43 lks dist

T 1 S R 39 E P-21

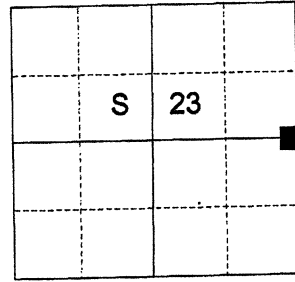

**DESCRIPTION OF CORNER EVIDENCE FOUND:**

None. Found Boise Cascade K tag adjacent tree.

SEE SURVEY NUMBER 019-2023

**DESCRIPTION OF MONUMENT AND ACCESSORIES I ESTABLISHED TO MONUMENT THE ORIGINAL LOCATION OF THIS CORNER:**

At proportionate position, I set a 2 1/2" aluminum pipe, 20" in the ground, with 3" aluminum cap in a mound of stone 2' in diameter, from which:

**NEW BEARING OBJECTS:**

- A 14" Ponderosa Pine bears North 38° East, a dist. of 5.75 feet, marked 1/4 S24 BT
- A 10" Douglas Fir bears South 41° East, a distance of 15.05 feet, marked 1/4 S24 BT
- A 6" Western Larch bears South 80° West, a dist. of 7.70 feet, marked 1/5 S23 BT
- A 8" Douglas Fir bears North 37° West, a distance of 16.60 feet, marked 1/4 S23 BT

North/South fence runs 15 ft East of corner monument

I hereby certify that the corner was monumented on August 10th, 2023.

Witness: Adam Gordon

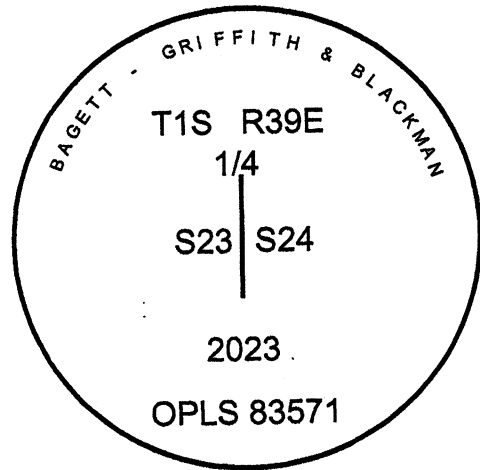

Renewal Date: June 30, 2025

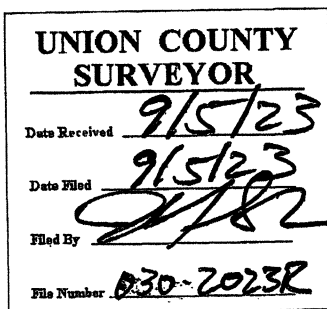

I used a tape and compass in the establishment of new the accessories. Bearing is measured to a brass washer labeled OPLS 83571 located at the center of BT blaze, with a declination of 14° East. Distance is measured to a 60d spike nailed to the right side base of tree.