

UNION COUNTY SURVEYOR

CERTIFIED RECORD OF LAND CORNER MONUMENTATION

HISTORY OF ORIGINAL CORNER ESTABLISHMENT:

Corner originally monumented by David P. Thompson on GLO Contract number 103 dated September 3, 1863. Surveyor General record states:

Set post for 1/4 sec corner in mound of earth with pits, trench and charred stake as per instructions

Survey Number 62 recorded in Old Survey Book on pages 130-132 by J.W.Kimbrell states: 40.25 ch-Set stone 6x9x16 for 1/4 sec cor bet secs 19&20.

No record of subsequent monumentation found in UNION COUNTY survey records.

T 1 S R 39 E P-05

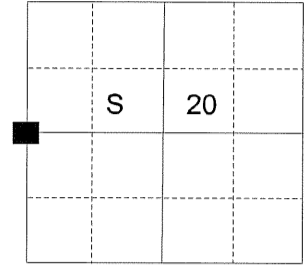

DESCRIPTION OF CORNER EVIDENCE FOUND:

No evidence of the original corner or it's accessories were found. Established the corner position at the intersection of the centerline of Dry Creek Road (County Road Number 39), and an existing North-South fenceline.

See Survey Number 037-2006.

DESCRIPTION OF MONUMENT AND ACCESSORIES I ESTABLISHED TO PERPETUATE THE ORIGINAL LOCATION OF THIS CORNER:

At the position described above, I set a 5/8"x30" "copper clad" iron pin with 2 1/2" brass cap marked as shown below, 33" in the ground, from which:

NEW BEARING OBJECTS:

A 5/8"x30" iron pin with 1 1/2" aluminum cap marked "BGB SURVEY MARKER NE RP" bears N 44°49'52" E, a distance of 20.04 feet.

A 5/8"x30" iron pin with 1 1/2" aluminum cap marked "BGB SURVEY MARKER SE RP" bears S 44°45'23" E, a distance of 20.12 feet.

A 5/8"x30" iron pin with 1 1/2" aluminum cap marked "BGB SURVEY MARKER SW RP" bears S 44°52'47" W, a distance of 20.09 feet.

A 5/8"x30" iron pin with 1 1/2" aluminum cap marked "BGB SURVEY MARKER NW RP" bears N 44°55'45" W, a distance of 20.07 feet.

I hereby certify that the corner was monumented on November 16, 2006. Witness: Jeff Hsu and Leo Castillo.

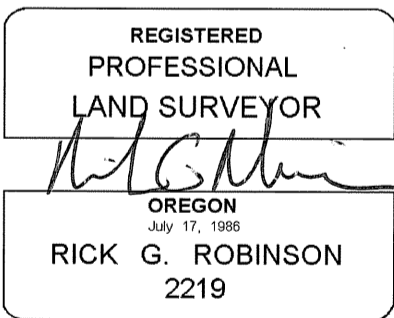

Renewal Date: December 31, 2008

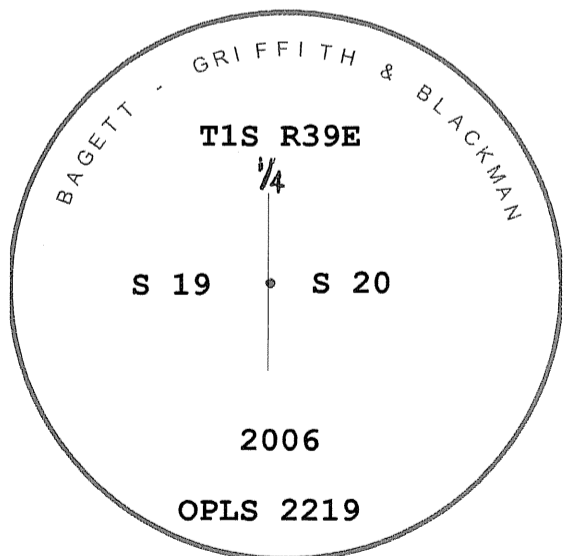

UNION COUNTY SURVEYOR

Date Received 11/30/06

Date Filed 1/14/07

Filed By [Signature]

File Number 003-2007R

I used a Leica System 500 GPS unit in the establishment of new accessories. The basis of bearing is that of survey number 037-2006. The distance to the bearing objects is to the center of the aluminum cap.

HORIZONTAL CONTROL DATA
UNION COUNTY, OREGON
OREGON STATE PLANE, NORTH ZONE (3601)

STA NAME: 200703

1/4 SECTION CORNER COMMON TO SECTIONS 19 and 20

TWP. 1 S. RGE. 39 E.

GEODETIC COORD: NAD 83(91)

DATE TIED: February 7, 2007

LAT: 45 ° 27 ' 50.68443 " N

SURVEYOR: RICK G. ROBINSON
OPLS 2219

LONG: 117 ° 58 ' 22.81011 " W

FIRM: BAGETT, GRIFFITH, & BLACKMAN
2006 Adams Avenue
La Grande, OR 97850
(541) 963-6092

SP. COOR: NAD 83(91)

N: 665428.545 INT FT.

E: 8850329.148 INT FT.

TYPE: GPS

THETA: 1 ° 47 ' 31.599862 "

ORDER: SECOND CLASS: 1

SCALE FACTOR: 0.9999078467

ELEV: 2750.17 US FT.

ELEV: DATUM: NGVD 29

COMMENTS:

Corner is a 5/8"x30" "copper clad" iron pin
with 2 1/2" brass cap marked:

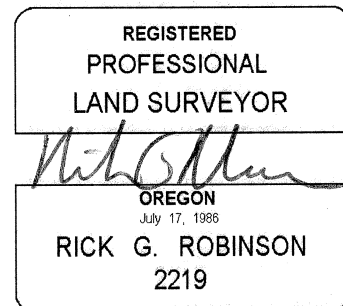
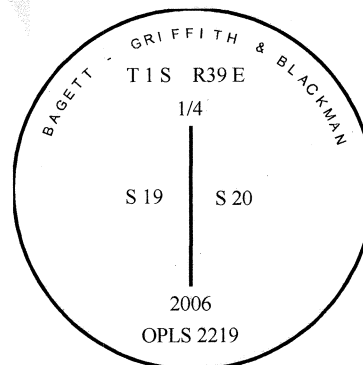

Renewal Date: December 31, 2008

1 METER = 3.280833333... US FEET = 39.37 INCHES

1 METER = 3.280839895 INT'L FEET OR 1 INCH = 2.54 CM

TO CALCULATE ELEVATION FACTOR (IN THE NORTH AMERICAN CONTINENT)

DIVIDE 20,906,000 BY (20,906,000 + ELLIPSOID ELEV. IN FEET)