

**CERTIFIED RECORD OF LAND CORNER MONUMENTATION**

**HISTORY OF ORIGINAL CORNER ESTABLISHED:**

Corner originally established by David P. Thompson under GLO Contract Number 103, dated July 3rd, 1863. Surveyor General Field Notes state:

Set post for 1/4 sec corner from which  
A Pine 8 in. diam bears N70°E 75 lks dist  
A Pine 15 in. diam bears S10°E 29 lks dist

T 1 S R 39 E N-23

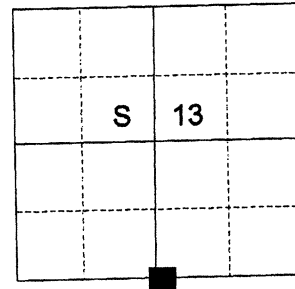

**DESCRIPTION OF CORNER EVIDENCE FOUND:**

None

Boise Cascade loc. tag found on adjacent tree

SEE SURVEY NUMBER 019-2023

**DESCRIPTION OF MONUMENT AND ACCESSORIES I ESTABLISHED TO MONUMENT THE ORIGINAL LOCATION OF THIS CORNER:**

At proportionate position I set a 2 1/2" by 30" aluminum pipe, 25 inches in the ground, with 3" aluminum cap marked as shown below, in a mound of stone 2 feet in diam., from which:

**NEW BEARING OBJECTS:**

- A 6" White Fir bears North 27° East, a dist. of 11.55 feet, marked 1/4 S13 BT
- A 16" Douglas Fir bears South 32° East, a dist. of 26.90 feet, marked 1/4 S24 BT.
- A 6" Douglas Fir bears South 24° West, a dist. of 7.15 feet, marked 1/4 S24 BT.
- A 15" Douglas Fir bears North 55° West, a dist. of 17.50 feet, marked 1/4 S13 BT.

Set steel fence post approx. 1.5 feet West of monument.

I hereby certify that the corner was monumented on August 14th, 2023.

Witness: Adam Gordon

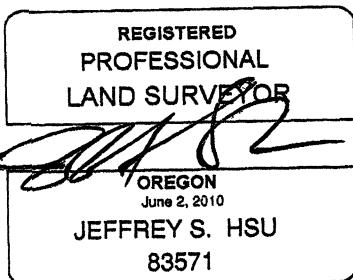
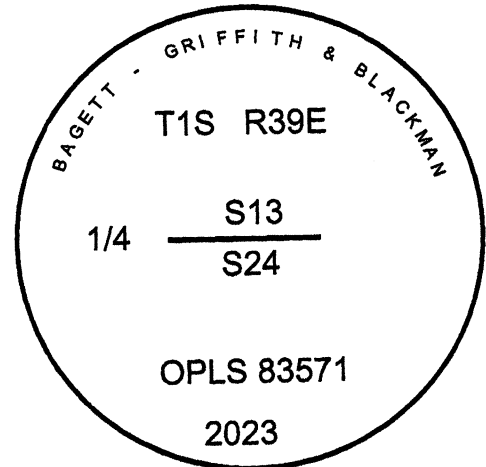

Renewal Date: June 30, 2025

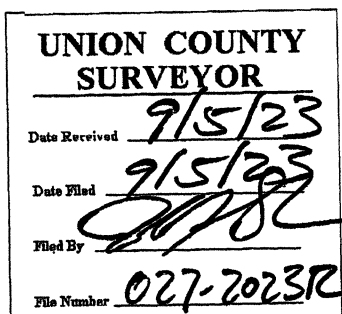

I used a tape and compass in the establishment of the new accessories. Bearing is measured to a brass washer labeled OPLS 83571 located at the center of BT blaze, with a declination of 14° East. Distance is measured to a 60d spike nailed to the right side base of tree.