

CERTIFIED RECORD OF LAND CORNER MONUMENTATION

HISTORY OF ORIGINAL CORNER ESTABLISHMENT:

Corner originally monumented by David P. Thompson on GLO Contract number 103 dated September 3, 1863. Surveyor General record states: Set post for 1/4 sec corner in mound of earth with pits, trench and charred stake as per instructions

T 1 S R 39 E N-07

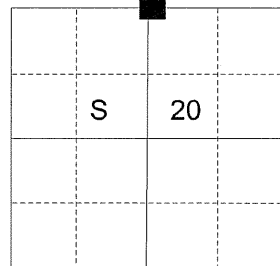

Survey Number 62 recorded in Old Survey Book on pages 130-132 by J.W.Kimbrell states: 40.17 ch-Set stone 6x8x18 for 1/4 Sec corner bet Secs 17&20.

No record of subsequent monumentation found in UNION COUNTY survey records.

DESCRIPTION OF CORNER EVIDENCE FOUND:

No evidence of the original corner or it's accessories were found. Established the corner position at the intersection of the centerline of Brooks Road (County Road Number 35), and at record North-South position as called by the plat of W.A.Laidlaw Apple Orchard.

See Survey Number 037-2006.

DESCRIPTION OF MONUMENT AND ACCESSORIES I ESTABLISHED TO PERPETUATE THE ORIGINAL LOCATION OF THIS CORNER:

At the position described above, I set a 5/8"x30" "copper clad" iron pin with 2 1/2" brass cap marked as shown below, 32" in the ground, from which:

NEW BEARING OBJECTS:

A 5/8"x30" iron pin with 1 1/2" aluminum cap marked "BGB SURVEY MARKER NE RP" bears N 45°03'04" E, a distance of 20.02 feet.

A nail set in the South side of utility pole #028205102 bears S 35°50'05" E, a distance of 47.03 feet.

A 16" diameter apple tree bears S 34° W, a distance of 88.12 feet marked "1/4 S20 BT".

A 5/8"x30" iron pin with 1 1/2" aluminum cap marked "BGB SURVEY MARKER NW RP" bears N 45°08'55" W, a distance of 29.99 feet.

I hereby certify that the corner was monumented on November 16, 2006. Witness: Jeff Hsu and Leo Castillo.

REGISTERED
PROFESSIONAL
LAND SURVEYOR

OREGON
July 17, 1986
RICK G. ROBINSON
2219

Renewal Date: December 31, 2008

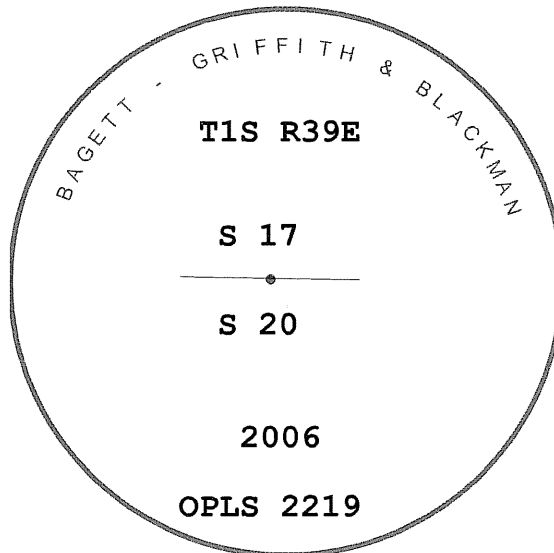

I used a Leica System 500 GPS unit in the establishment of the NE, SE and NW accessories. The basis of bearing is that of survey number 037-2006. The distance to the bearing objects is to the center of the aluminum cap, and the nail set in the power pole. I used a steel tape and magnetic compass in the establishment of the Southwest bearing tree. The magnetic declination is 18° East, and the distance is to a 50d nail driven in the right side of the root crown. I attached a brass washer marked OPLS 2219 at the top of the BT blaze.

UNION COUNTY SURVEYOR

Date Received 4/30/06

Date Filed 4/14/07

Filed By Agg T. Black

File Number 002-2007R

HORIZONTAL CONTROL DATA

UNION COUNTY, OREGON

OREGON STATE PLANE, NORTH ZONE (3601)

STA NAME: 200702

1/4 SECTION CORNER COMMON TO SECTIONS 17 and 20

TWP. 1 S. RGE. 39 E.

GEODETIC COORD: NAD 83(91)

DATE TIED: February 7, 2007

LAT: 45 ° 28 ' 16.85110 " N

SURVEYOR: RICK G. ROBINSON
OPLS 2219

LONG: 117 ° 57 ' 45.76215 " W

FIRM: BAGETT, GRIFFITH, & BLACKMAN
2006 Adams Avenue
La Grande, OR 97850
(541) 963-6092

SP. COOR: NAD 83(91)

N: 668160.095 INT FT.

E: 8852884.956 INT FT.

TYPE: GPS

THETA: 1 ° 47 ' 57.8737567 "

ORDER: SECOND CLASS: 1

SCALE FACTOR: 0.9999085082

ELEV: 2734.39 US FT.

ELEV: DATUM: NGVD 29

COMMENTS:

Corner is a 5/8"x30" "copper clad" iron pin
with 2 1/2" brass cap marked:

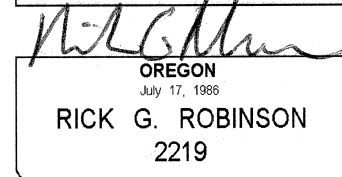
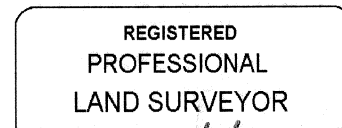
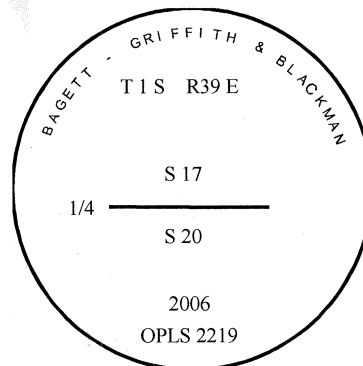

Renewal Date: December 31, 2008

1 METER = 3.2808333333... US FEET = 39.37 INCHES

1 METER = 3.280839895 INT'L FEET OR 1 INCH = 2.54 CM

TO CALCULATE ELEVATION FACTOR (IN THE NORTH AMERICAN CONTINENT)

DIVIDE 20,906,000 BY (20,906,000 + ELLIPSOID ELEV. IN FEET)