

CERTIFIED RECORD OF LAND CORNER MONUMENTATION

HISTORY OF ORIGINAL CORNER ESTABLISHED:

Corner originally established by David P. Thompson under GLO contract 103, dated September 3rd, 1863. Surveyor General field notes state:

Set post for 1/4 sec. corner in mound of earth with charred stake, pits, trench, as per instructions.

Corner monumented in Union County old book Survey 200. Record states: @ 40.06 chains South of the corner to sec. 5-6-7-8 Set stone 5x14x23 for 1/4 sec. corner.

Corner found in Union County old book Survey-Kimbrell 094, Page 130. Record states: The 1/4 sec. corner bet. sec. 7 & 8.

Corner found in Union County Survey 064-1976. Record states: Found conc. mon.

T 1 S R 39 E G-5

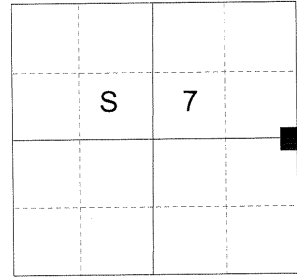

DESCRIPTION OF CORNER EVIDENCE FOUND:

Found 5/8" iron pin, drilled into concrete and 2" below the road surface of East/West running Courtney Ln.

DESCRIPTION OF MONUMENT AND ACCESSORIES I ESTABLISHED TO PERPETUATE THE ORIGINAL LOCATION OF THIS CORNER:

At the position of the found iron pin, I add a 2 1/2" aluminum cap marked as shown below, from which:

NEW BEARING OBJECTS:

- A Power pole bears North 2° East a dist. of 51.25 ft., marked K2075540KS 028080152
- A Power pole bears South 73° East a dist. of 88.20 ft., marked 028079854
- A 5/8" x 30" iron pin bears South 2° West a dist. of 20.10 ft., with 1 1/2" aluminum cap marked SW RP.
- A 5/8" x 30" iron pin bears North 73° West a dist. of 73.80 ft., with 1 1/2" aluminum cap marked NW RP.

Falls in the centerline of Courtney Ln.

I hereby certify that the corner was perpetuated on March 9, 2020.
Witness: Kyle A. Tucker

REGISTERED
PROFESSIONAL
LAND SURVEYOR

OREGON
June 2, 2010
JEFFREY S. HSU
83571

Renewal Date: June 30, 2021

**UNION COUNTY
SURVEYOR**

Date Received 3/17/20

Date Filed 3/17/20

Filed By [Signature]

File Number 005-2020R

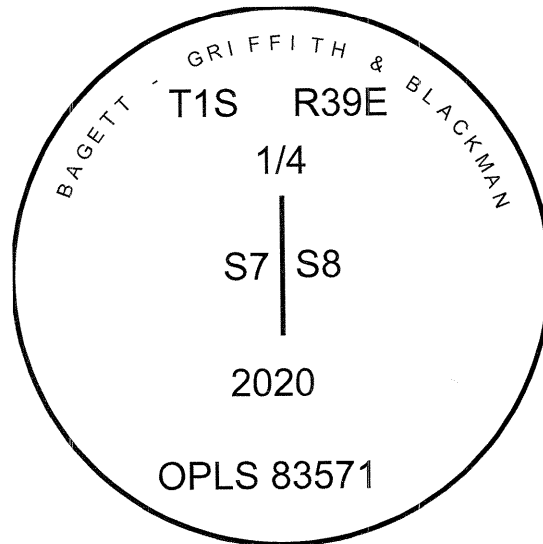

I used a Leica GS 18 in the establishment of the new accessories. Basis of Bearing is as per Union County Survey 064-1976. The distances and bearings are to the center of the aluminum caps or the center of the power poles.

HORIZONTAL CONTROL DATA
UNION COUNTY, OREGON
OREGON STATE PLANE, NORTH ZONE (3601)

STA NAME: 2020014

1/4 SECTION CORNER COMMON TO SECTIONS 7 AND 8

TWP. 1 S RGE. 39 E.

GEODETIC COORD: NAD 83(91)

DATE TIED: March 9, 2020

LAT: 45 ° 29 ' 35.35631 " N

SURVEYOR: RICK G. ROBINSON
OPLS 2219

LONG: 117 ° 58 ' 23.54083 " W

FIRM: BAGETT, GRIFFITH, & BLACKMAN
2006 ADAMS AVENUE
LAGRANDE, OR 97850
(541) 963-6092

SP. COOR: NAD 83(91)

N: 676022.759 INT FT.

E: 8849945.596 INT FT.

TYPE: GPS

THETA: 1 ° 47 ' 31.0816444 "

ORDER: SECOND CLASS: 1

SCALE FACTOR: 0.9999105895

ELEV: 2704.76 US FT.

ELEV: DATUM: NGVD 29

COMMENTS:

5/8" iron pin with 2 1/2" aluminum cap
marked as shown

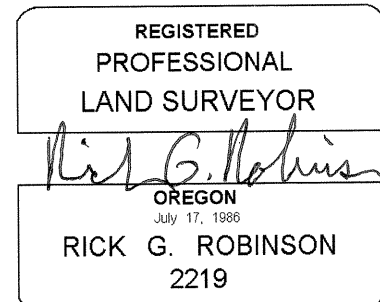
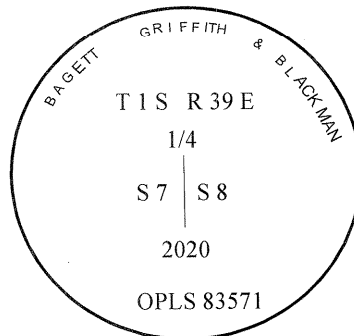

Renewal Date: December 31, 2020

1 METER = 3.280833333... US FEET = 39.37 INCHES

1 METER = 3.280839895 INT'L FEET OR 1 INCH = 2.54 CM

TO CALCULATE ELEVATION FACTOR (IN THE NORTH AMERICAN CONTINENT)

DIVIDE 20,906,000 BY (20,906,000 + ELLIPSOID ELEV. IN FEET)