

**CERTIFIED RECORD OF LAND CORNER MONUMENTATION**

**HISTORY OF ORIGINAL CORNER ESTABLISHMENT:**

Corner originally established by David T. Thompson under GLO contract Number 120, dated Sept. 3, 1863. Surveyor General record states:

Set post for corner to Township 1 South, Ranges 38 & 39 South.  
Raised mound of rock.

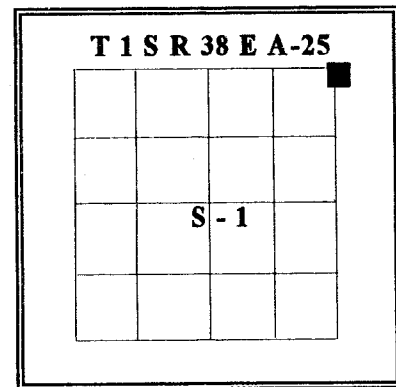

No record of subsequent monumentation found in the Union County Survey records.

**DESCRIPTION OF CORNER EVIDENCE FOUND:**

Found fence corner, fences running south and west.

See Map of Survey Number 022-1997.

**DESCRIPTION OF MONUMENT AND ACCESSORIES I ESTABLISHED TO PERPETUATE THE ORIGINAL LOCATION OF THIS CORNER:**

At the fence corner I set 2-1/2 inch by 30 inch aluminum pipe with aluminum cap marked as shown, 26 inches in the ground.

From which, reference objects;

- A 5/8" by 30" rebar bears N 47°E, 7.96 feet, with 1-1/2" aluminum cap marked "UCS NE RP".
- A 5/8" by 30" rebar bears S 50°E, 6.89 feet, with 1-1/2" aluminum cap marked "UCS SE RP".
- A 5/8" by 30" rebar bears S 35°W, 6.87 feet, with 1-1/2" aluminum cap marked "UCS SW RP".
- A 5/8" by 30" rebar bears N 34°W, 6.07 feet, with 1-1/2" aluminum cap marked "UCS NW RP".

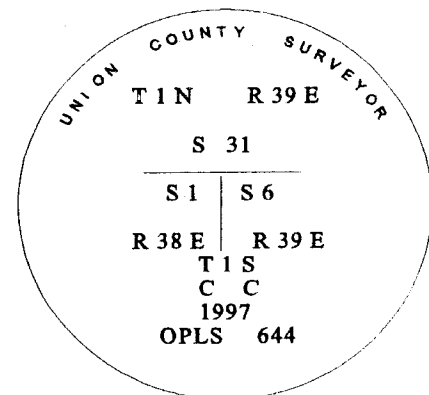

Raised mound of stone, 4 foot base to top of cap.

I hereby certify that the above corner point was perpetuated as hereon described on July 30, 1997.

Witnessed by: Jeff Petersen  
Jeff Madsen

I used a steel tape and magnetic compass in the establishment of new accessories. I used 18° east declination and the measurement was taken to the center of the aluminum cap on the rebar.



*Renewal Date July 30, 1999*

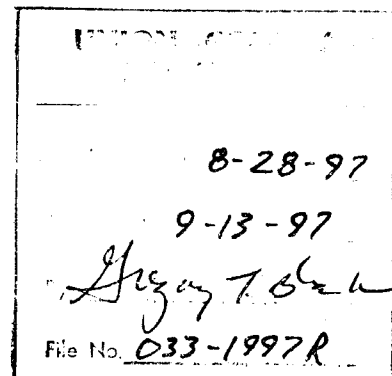

# HORIZONTAL CONTROL DATA

## UNION COUNTY, OREGON

### OREGON STATE PLANE, NORTH ZONE (3601)

STA NAME: 201513

SECTION CORNER COMMON TO SECTIONS 1 AND 6 ONLY

TWP. 1 S. RGE. 38 & 39 E.

GEODETIC COORD: NAD 83(91)

DATE TIED: February 19, 2015

LAT: 45 ° 30 ' 53.23641 " N

SURVEYOR: RICK G. ROBINSON  
OPLS 2219

LONG: 117 ° 59 ' 37.23983 " W

FIRM: BAGETT, GRIFFITH, & BLACKMAN  
2006 ADAMS AVENUE  
LAGRANDE, OR 97850  
(541) 963-6092

SP. COOR: NAD 83(91)

N: 683743.115 INT FT.

E: 8844453.822 INT FT.

TYPE: GPS

THETA: 1 ° 46 ' 38.8153433 "

ORDER: SECOND CLASS: 1

SCALE FACTOR: 0.9999127978

ELEV: 3023.55 US FT.

ELEV: DATUM: NGVD 29

COMMENTS:

2 ½" Aluminum monument in  
mound of stone

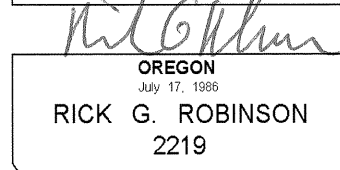
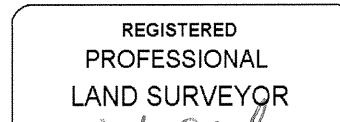
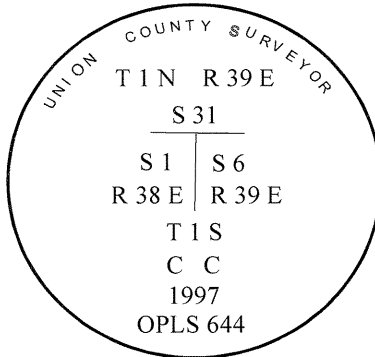

Renewal Date: December 31, 2016

1 METER = 3.280833333... US FEET = 39.37 INCHES

1 METER = 3.280839895 INT'L FEET OR 1 INCH = 2.54 CM

TO CALCULATE ELEVATION FACTOR ( IN THE NORTH AMERICAN CONTINENT)

DIVIDE 20,906,000 BY (20,906,000 + ELLIPSOID ELEV. IN FEET)