

UNION COUNTY SURVEYOR

CERTIFIED RECORD OF LAND CORNER MONUMENTATION

HISTORY OF ORIGINAL CORNER ESTABLISHMENT:

Corner originally established by David P. Thompson under GLO contract Number 103, dated September 3, 1863. Surveyor General record states:
Set post for 1/4 sec cor in mound of earth with charred stake, pits, trench as per instructions

T 1 S R 38 E X-17

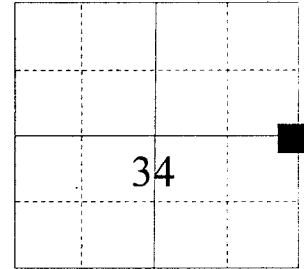

Survey No. 37-74 states "stone found at E 1/4 corner"

No record of subsequent monumentation found in Union County survey records.

DESCRIPTION OF CORNER EVIDENCE FOUND:

Found stone 14x12x6 with faint marks visible. Stone loose on west side of irrigation ditch.

DESCRIPTION OF MONUMENT AND ACCESSORIES I ESTABLISHED

TO PERPETUATE THE ORIGINAL LOCATION OF THIS CORNER:

I reestablished the corner position at the record position of survey no. 37-74. As described above, the position falls on the bank of an irrigation ditch. I therefore set a 2½" x 30" aluminum pipe with aluminum cap marked as shown below, 36" in the ground for a reference monument.

- New Bearing Objects: (Bearing and distance are to the TRUE corner position)
- A 5/8 x 30 inch iron rebar with aluminum cap bears N38°E, a distance of 17.65 feet, marked NE RP.
 - A 5/8 x 30 inch iron rebar with aluminum cap bears S41°E, a distance of 18.54 feet, marked SE RP.
 - A 2½ inch aluminum cap bears S76°W, a distance of 12.95 feet, marked as shown below.
 - A 5/8 x 30 inch iron rebar with aluminum cap bears N35°W, a distance of 17.53 feet, marked NW RP.

I hereby certify that the corner was monumented on October 28, 1998.
Witness: Norbert Volny, Greg Blackman Jr.

REGISTERED
PROFESSIONAL
LAND SURVEYOR

Rick G. Robinson

OREGON
July 17, 1986
RICK G. ROBINSON
2219

Renewal Date December 31, 1998

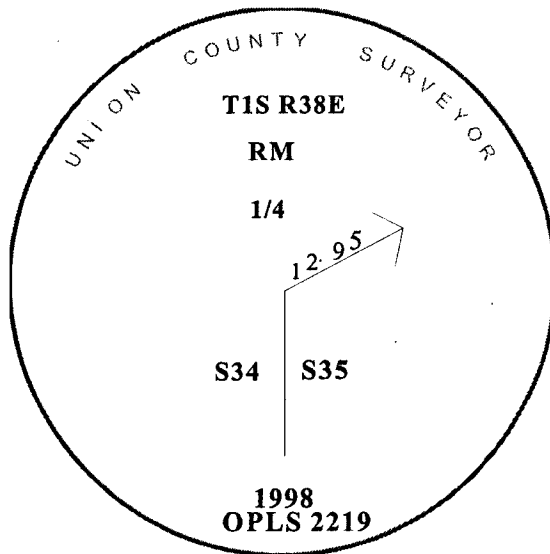

UNION COUNTY SURVEYOR

Date Received 11/30/98

Date Filed 12/18/98

Filed By *Greg T. Blackman*

File Number 182-1998R

I used the Leica TCA 1100 total station in the establishment of the new accessories. The basis of bearing is the same as survey no. 047-1998.