

UNION COUNTY SURVEYOR

CERTIFIED RECORD OF LAND CORNER MONUMENTATION

HISTORY OF ORIGINAL CORNER ESTABLISHMENT:

Corner originally monumented by David P. Thompson on GLO Contract number 103 dated January 20, 1863. Surveyor General record states:

Set post for 1/4 sec corner in mound of earth with charred stake pits trench as per instructions.

No record of subsequent monumentation found in UNION COUNTY survey records.

T 1 S R 38 E V-19

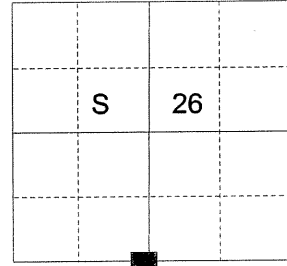

DESCRIPTION OF CORNER EVIDENCE FOUND:

No evidence of the original corner or it's accessories were found.

See Survey Number 003-2004.

DESCRIPTION OF MONUMENT AND ACCESSORIES I ESTABLISHED TO PERPETUATE THE ORIGINAL LOCATION OF THIS CORNER:

At the proportioned position, I set a 2 1/2 inch brass cap in the center line of Woodell Lane on the westerly edge of existing bridge, from which:

NEW BEARING OBJECTS:

A 4"X4" railroad rail set in concrete bears north 1°East, a distance of 38.48 feet.

A 4"X4" railroad rail set in concrete bears south 23°East, a distance of 44.31 feet.

A 5/8"x30" iron pin with a 1 1/2" aluminum cap marked SW RP bears S 61°W, a distance of 34.98 feet.

A 5/8"x30" iron pin with a 1 1/2" aluminum cap marked NW RP bears N 64° W, a distance of 36.10 feet.

I hereby certify that the corner was monumented on April 5, 2004. Witness: Gregory T. Blackman Jr.

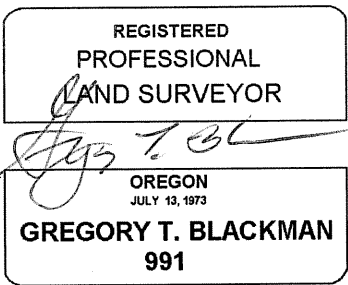
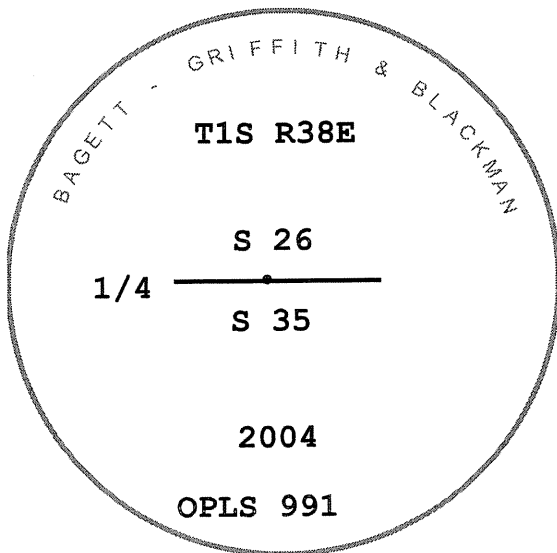

UNION COUNTY SURVEYOR

Date Received 12/30/04

Date Filed 12/30/04

Filed By R. ROBINSON, DEPUTY

File Number 013-2004R

I used a Leica GPS-500 in the establishment of new accessories. The basis of bearings is the same as that on survey number 003-2004. The distances are to the center of a 5/8" rebar with a 1 1/2" the aluminum cap, and corner of 4"X4" R.R. tie.

HORIZONTAL CONTROL DATA

UNION COUNTY, OREGON

OREGON STATE PLANE, NORTH ZONE (3601)

STA NAME: 200527

1/4 SECTION CORNER COMMON TO SECTIONS 26 and 35

TWP. 1 S. RGE. 38 E.

GEODETIC COORD: NAD 83(91)

DATE TIED: August 16, 2005

LAT: 45 ° 26 ' 31.47988 " N

SURVEYOR: GREGORY T. BLACKMAN
OPLS 991

LONG: 118 ° 1 ' 28.31828 " W

FIRM: BAGETT, GRIFFITH, & BLACKMAN
2006 Adams Avenue
La Grande, OR 97850
(541) 963-6092

SP. COOR: NAD 83(91)

N: 657001.395 INT FT.

E: 8837360.506 INT FT.

TYPE: GPS

THETA: 1 ° 45 ' 20.0400646 "

ORDER: SECOND CLASS: 1

SCALE FACTOR: 0.9999059426

ELEV: 2710.12 US FT.

ELEV: DATUM: NGVD 29

COMMENTS:

2 1/2" Brass cap marked:
Corner is set on the Westerly edge of a
bridge in the center line of Woodell Lane

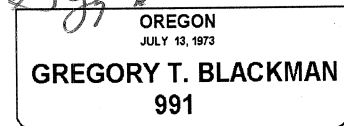
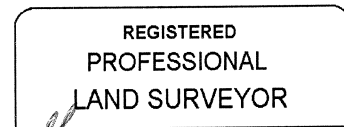
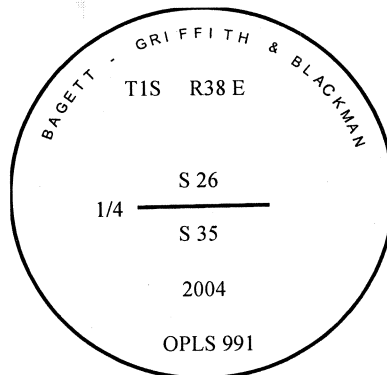

Renewal Date: December 31, 2005

1 METER = 3.2808333333... US FEET = 39.37 INCHES

1 METER = 3.280839895 INT'L FEET OR 1 INCH = 2.54 CM

TO CALCULATE ELEVATION FACTOR (IN THE NORTH AMERICAN CONTINENT)

DIVIDE 20,906,000 BY (20,906,000 + ELLIPSOID ELEV. IN FEET)