

UNION COUNTY SURVEYOR

CERTIFIED RECORD OF LAND CORNER MONUMENTATION

HISTORY OF ORIGINAL CORNER ESTABLISHMENT:

Corner originally established by D. Thompson, under GLO contract Number 103, dated July 20, 1863. Surveyor General record states:

Set post corner to sections 27, 26, 34 & 35 made mound of earth and deposited charred stake as per instructions.

No record of subsequent monumentation found in Union County survey records.

DESCRIPTION OF CORNER EVIDENCE FOUND:

Intersection of the centerline of Woodell Road and existing fence line to the north.

T 1 S R 38 E V - 17

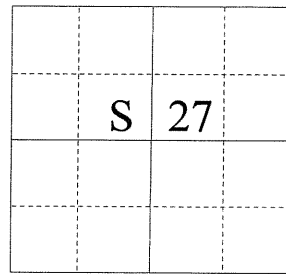

See Survey #003-2004

DESCRIPTION OF MONUMENT AND ACCESSORIES I ESTABLISHED

TO PERPETUATE THE ORIGINAL LOCATION OF THIS CORNER:

At fence corner, I set a 2½" x 30" aluminum pipe with aluminum cap marked as shown below, 24" in the ground with a mound of stone 3 feet from base to top of cap from which:

NEW BEARING OBJECTS:

- A 4"X 4" Iron railroad fence post bears N44°17'E, a distance of 54.76 feet.
- A 4"X 4" Iron railroad fence post bears S24°34'E, a distance of 43.68 feet.
- A 4"X 4" Iron railroad fence post bears S29°09'W, a distance of 45.95 feet.
- A 4"X 4" Iron railroad fence post bears N07°41'W, a distance of 38.55 feet.

I hereby certify that the corner was monumented on February 4, 2004.
Witness: Ty Robinson, Gregory T. Blackman Jr.

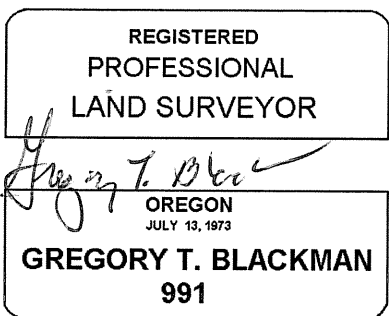

Renewal Date: December 31, 2005

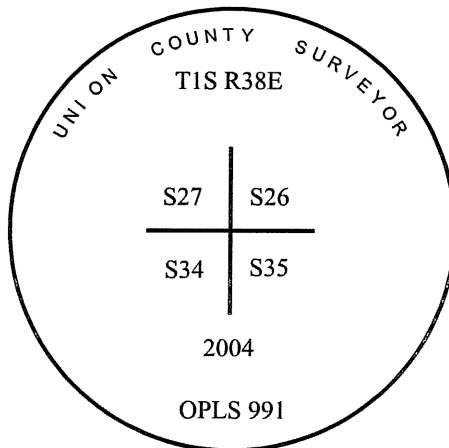

I used a Leica GPS-500 Receiver in the establishment of the new accessories. The Basis of Bearings is the same as that on survey number 003-2004. The distances are to a 4"X4" Railroad iron fencepost.

UNION COUNTY SURVEYOR

Date Received 12/30/04

Date Filed 12/30/04

Filed By R. Robinson, Deputy

File Number 019-2004R

HORIZONTAL CONTROL DATA

UNION COUNTY, OREGON

OREGON STATE PLANE, NORTH ZONE (3601)

STA NAME: 200525

SECTION CORNER COMMON TO SECTIONS: 26, 27, 34 and 35

TWP. 1 S. RGE. 38 E.

GEODETIC COORD: NAD 83(91)

DATE TIED: August 16, 2005

LAT: 45 ° 26 ' 31.25103 " N

SURVEYOR: GREGORY T. BLACKMAN
OPLS 991

LONG: 118 ° 2 ' 5.56253 " W

FIRM: BAGETT, GRIFFITH, & BLACKMAN
2006 ADAMS AVENUE
LAGRANDE, OR 97850
(541) 963-6092

SP. COOR: NAD 83(91)

N: 656897.051 INT FT.

E: 8834707.118 INT FT.

TYPE: GPS

THETA: 1 ° 44 ' 53.6269652 "

ORDER: SECOND CLASS: 1

SCALE FACTOR: 0.9999059373

ELEV: 2714.71 US FT.

ELEV: DATUM: NGVD 29

COMMENTS:

Corner is 2 1/2" aluminum monument
marked as shown:

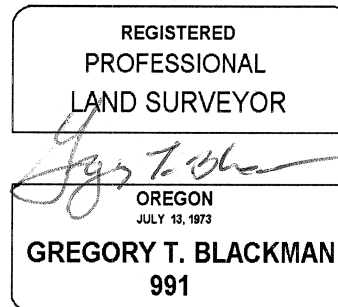
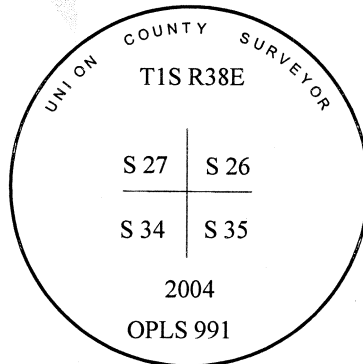

Renewal Date: December 31, 2005

1 METER = 3.280833333... US FEET = 39.37 INCHES

1 METER = 3.280839895 INT'L FEET OR 1 INCH = 2.54 CM

TO CALCULATE ELEVATION FACTOR (IN THE NORTH AMERICAN CONTINENT)

DIVIDE 20,906,000 BY (20,906,000 + ELLIPSOID ELEV. IN FEET)