

UNION COUNTY SURVEYOR

CERTIFIED RECORD OF LAND CORNER MONUMENTATION

HISTORY OF ORIGINAL CORNER ESTABLISHMENT:

Corner originally established by D. Thompson under GLO contract Number 103, dated July 20, 1863. Surveyor General record states:

Set post cor for Sections 23, 24, 26, 25 made mound of earth and deposited charred stake as per instructions.

No record of subsequent monumentation found in Union County survey records.

DESCRIPTION OF CORNER EVIDENCE FOUND:

See Survey #003-2004

DESCRIPTION OF MONUMENT AND ACCESSORIES I ESTABLISHED TO PERPETUATE THE ORIGINAL LOCATION OF THIS CORNER:

At the proportioned position, I set a 2½" x 30" aluminum pipe with aluminum cap marked as shown below, 45" from which:

NEW BEARING OBJECTS:

A 5/8" x 30" rebar with 1 ½" aluminum cap bears N43°59'E, a distance of 11.51 feet, marked "BGB SURVEY MARKER NE RP", 15" below surface.

A 5/8" x 30" rebar with 1 ½" aluminum cap bears S33°12'E, a distance of 13.15 feet, marked "BGB SURVEY MARKER SE RP", 15" below surface.

A 4" Irrigation riser, bears S65° 16' West, 38.18 feet.

A 4" irrigation riser, bears N39°40' west, 54.94 feet.

I hereby certify that the corner was monumented on March 18, 2004.
Witness: Gregory T. Blackman Jr.

T 1 S R 38 E R-21

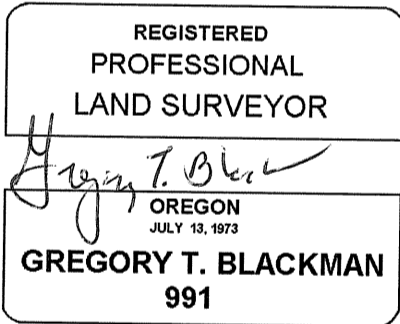
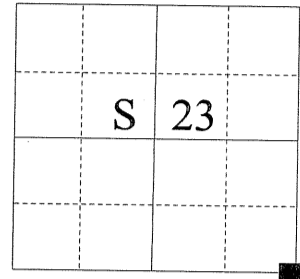

Renewal Date: December 31, 2005

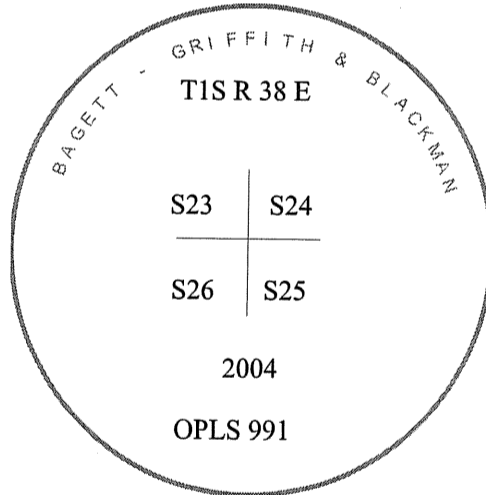

UNION COUNTY SURVEYOR

Date Received 12/30/04

Date Filed 12/30/04

Filed By R. Robinson, Deputy

File Number 023-2004R

I used a Leica GPS 500 receiver in the establishment of the new accessories. The basis of bearings is the same as that on Survey number 003-2004. The distances are to the center of a 5/8" rebar with a 1 ½" aluminum cap. And center of a 4" irrigation riser.

R-21

HORIZONTAL CONTROL DATA

UNION COUNTY, OREGON

OREGON STATE PLANE, NORTH ZONE (3601)

STA NAME: 200906

SECTION CORNER COMMON TO SECTIONS 23, 24, 25 and 26

TWP. 1 S. RGE. 38 E.

GEODETIC COORD: NAD 83(91)

DATE TIED: February 12, 2009

LAT: 45 ° 27 ' 24.14568 " N

SURVEYOR: RICK G. ROBINSON
OPLS 2219

LONG: 118 ° 0 ' 51.64365 " W

FIRM: BAGETT, GRIFFITH, & BLACKMAN
2006 Adams Avenue
La Grande, OR 97850
(541) 963-6092

SP. COOR: NAD 83(91)

N: 662413.019 INT FT.

E: 8839809.920 INT FT.

TYPE: GPS

THETA: 1 ° 45 ' 46.0491977 "

ORDER: SECOND CLASS: 1

SCALE FACTOR: 0.9999071922

ELEV: 2698.08 US FT.

ELEV: DATUM: NGVD 29

COMMENTS:

Corner is a 2 1/2"x30" aluminum pipe
with 2 1/2" aluminum cap marked:
Monument is set 15" below the ground

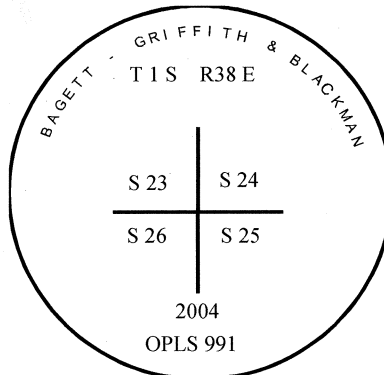

REGISTERED
PROFESSIONAL
LAND SURVEYOR

OREGON
July 17, 1986
RICK G. ROBINSON
2219

Renewal Date: December 31, 2010

1 METER = 3.2808333333... US FEET = 39.37 INCHES

1 METER = 3.280839895 INT'L FEET OR 1 INCH = 2.54 CM

TO CALCULATE ELEVATION FACTOR (IN THE NORTH AMERICAN CONTINENT)

DIVIDE 20,906,000 BY (20,906,000 + ELLIPSOID ELEV. IN FEET)