

**UNION COUNTY SURVEYOR**

**CERTIFIED RECORD OF LAND CORNER MONUMENTATION**

**HISTORY OF ORIGINAL CORNER ESTABLISHMENT:**

Corner originally established by D. Thompson under GLO contract Number 103, dated July 20, 1863. Surveyor General record states:

Set post corner to Secs 22, 23, 27, 26 in mound of earth with charred stake pits trench as per instructions.

No record of subsequent monumentation found in Union County survey records.

**DESCRIPTION OF CORNER EVIDENCE FOUND:**

Intersection of the proportioned section line and existing east west fence line.

T 1 S R38 E R-17

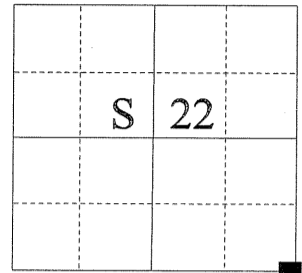

See Survey #003-2004

**DESCRIPTION OF MONUMENT AND ACCESSORIES I ESTABLISHED**

**TO PERPETUATE THE ORIGINAL LOCATION OF THIS CORNER:**

At the proportioned position, I set a 2½" x 30" aluminum monument, marked as shown below, 26" in the ground from which:

**NEW BEARING OBJECTS:**

A 5/8" x 30" rebar with 1 ½" aluminum cap bears N89°0'E, a distance of 12.99 feet, marked NE RP.

A 5/8" x 30" rebar with 1 ½" aluminum cap bears S49°29'E, a distance of 16.21 feet, marked SE RP.

A 5/8" x 30" rebar with 1 ½" aluminum cap bears S48°30'W, a distance of 14.16 feet, marked SW RP".

A 5/8" x 30" rebar with 1 ½" aluminum cap bears N89°02'W, a distance of 18.22 feet, marked NW RP.

I hereby certify that the corner was monumented on February 3, 2004.

Witness: Ty Robinson, Gregory T. Blackman Jr. East West fence line is 1 foot north of monument and irrigation ditch is 3 feet south of monument.

REGISTERED  
PROFESSIONAL  
LAND SURVEYOR

*Gregory T. Black*

OREGON  
JULY 13, 1973  
**GREGORY T. BLACKMAN**  
991

Renewal Date: December 31, 2005

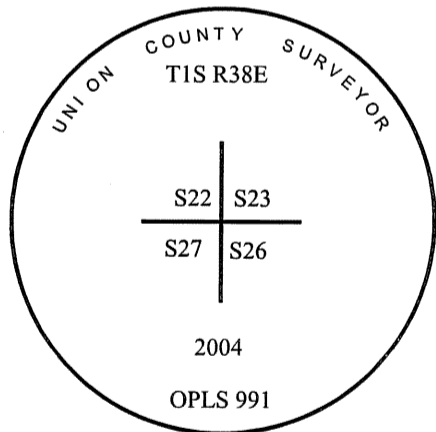

I used a Leica GPS-500 Receiver in the establishment of the new accessories. The basis of bearing is the same as that on survey No. 003-2004. The distances are to the center of a 5/8" rebar with a 1 ½" aluminum cap.

R-17

**UNION COUNTY  
SURVEYOR**

Date Received 12/30/04

Date Filed 12/30/04

Filed By R. Robinson, Deputy

File Number 020-2004R

# HORIZONTAL CONTROL DATA

## UNION COUNTY, OREGON

### OREGON STATE PLANE, NORTH ZONE (3601)

STA NAME: 200717

SECTION CORNER COMMON TO SECTIONS: 22, 23, 26 and 27

TWP. 1 S. RGE. 38 E.

GEODETIC COORD: NAD 83(91)

DATE TIED: March 21, 2007

LAT: 45 ° 27 ' 23.70991 " N

SURVEYOR: RICK G. ROBINSON  
OPLS 2219

LONG: 118 ° 2 ' 5.79969 " W

FIRM: BAGETT, GRIFFITH, & BLACKMAN  
2006 ADAMS AVENUE  
LAGRANDE, OR 97850  
(541) 963-6092

SP. COOR: NAD 83(91)

N: 662206.985 INT FT.

E: 8834528.137 INT FT.

TYPE: GPS

THETA: 1 ° 44 ' 53.458774 "

ORDER: SECOND CLASS: 1

SCALE FACTOR: 0.9999071816

ELEV: 2710.21 US FT.

ELEV: DATUM: NGVD 29

**COMMENTS:**

Corner is 2 1/2"x30" aluminum pipe with  
2 1/2" aluminum cap marked as shown:

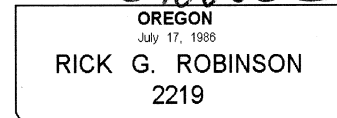
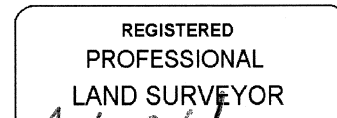
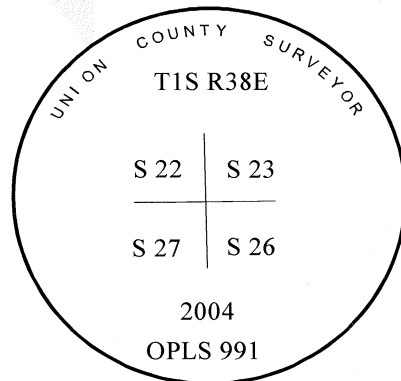

Renewal Date: December 31, 2008

1 METER = 3.2808333333... US FEET = 39.37 INCHES

1 METER = 3.280839895 INT'L FEET OR 1 INCH = 2.54 CM

TO CALCULATE ELEVATION FACTOR ( IN THE NORTH AMERICAN CONTINENT)

DIVIDE 20,906,000 BY (20,906,000 + ELLIPSOID ELEV. IN FEET)