

UNION COUNTY SURVEYOR

CERTIFIED RECORD OF LAND CORNER MONUMENTATION

HISTORY OF ORIGINAL CORNER ESTABLISHMENT:

Corner originally established by D. Thompson under GLO contract Number 103, dated September 3, 1863. Surveyor General record states:

Set post for 1/4 sec corner with mound of earth as per instructions.

No record of subsequent monumentation found in Union County survey records.

DESCRIPTION OF CORNER EVIDENCE FOUND:

No original evidence found

See Survey #003-2004

DESCRIPTION OF MONUMENT AND ACCESSORIES I ESTABLISHED

TO PERPETUATE THE ORIGINAL LOCATION OF THIS CORNER:

At proportionate position I set a 2½" x 30" aluminum pipe with aluminum cap marked as shown below, from which:

T 1 S R 38 E P - 17

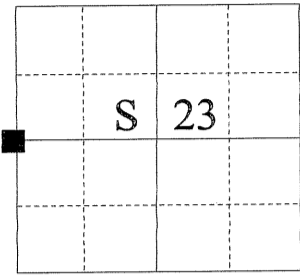

NEW BEARING OBJECTS:

A 5/8" x 30" rebar with 1 ½" aluminum cap bears N13°00'E, a distance of 29.15 feet, marked "BGB SURVEY MARKER NE RP".

A 5/8" x 30" rebar with 1 ½" aluminum cap bears S56°23'E, a distance of 36.12 feet, marked "BGB SURVEY MARKER SE RP".

A 5/8" x 30" rebar with 1 ½" aluminum cap bears S62°51'W, a distance of 30.22 feet, marked "BGB SURVEY MARKER SW RP".

A 5/8" x 30" rebar with 1 ½" aluminum cap bears N56°21'W, a distance of 50.82 feet, marked "BGB SURVEY MARKER NW RP".

I hereby certify that the corner was monumented on February 3, 2004.
Witness: Ty Robinson.

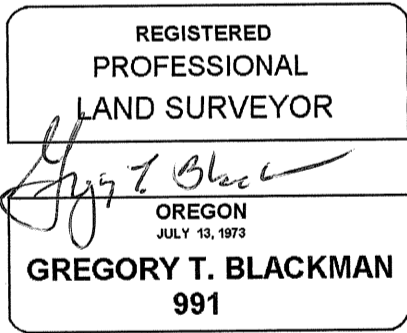

Renewal Date: December 31, 2005

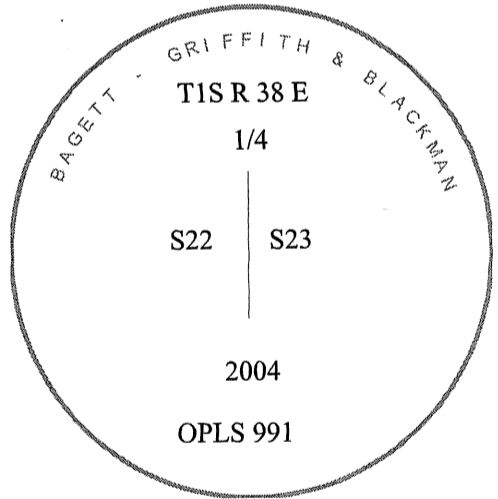

UNION COUNTY SURVEYOR

Date Received 12/30/04

Date Filed 12/30/04

Filed By R. Robinson Deputy

File Number 017-2004R

I used a Leica GPS-500 receiver in the establishment of the new accessories. The Basis of bearings is the same as that on survey number 003-2004. The distances are to the center of a 5/8" rebar with a 1½" aluminum cap.

HORIZONTAL CONTROL DATA
UNION COUNTY, OREGON
OREGON STATE PLANE, NORTH ZONE (3601)

STA NAME: 200716

1/4 SECTION CORNER COMMON TO SECTIONS 22 and 23

TWP. 1 S. RGE. 38 E.

GEODETIC COORD: NAD 83(91)

DATE TIED: March 21, 2007

LAT: 45 ° 27 ' 50.03112 " N

SURVEYOR: RICK G. ROBINSON
OPLS 2219

LONG: 118 ° 2 ' 5.80587 " W

FIRM: BAGETT, GRIFFITH, & BLACKMAN
2006 Adams Avenue
La Grande, OR 97850
(541) 963-6092

SP. COOR: NAD 83(91)

N: 664871.495 INT FT.

E: 8834446.372 INT FT.

TYPE: GPS

THETA: 1 ° 44 ' 53.4543882 "

ORDER: SECOND CLASS: 1

SCALE FACTOR: 0.9999078304

ELEV: 2724.32 US FT.

ELEV: DATUM: NGVD 29

COMMENTS:

Corner is a 2 1/2"x30" aluminum pipe
with 2 1/2" aluminum cap marked:

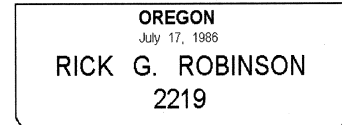
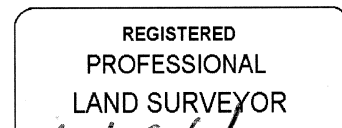
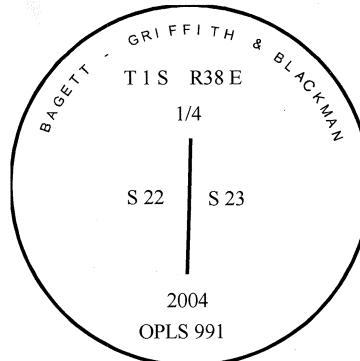

Renewal Date: December 31, 2008

1 METER = 3.2808333333... US FEET = 39.37 INCHES

1 METER = 3.280839895 INT'L FEET OR 1 INCH = 2.54 CM

TO CALCULATE ELEVATION FACTOR (IN THE NORTH AMERICAN CONTINENT)

DIVIDE 20,906,000 BY (20,906,000 + ELLIPSOID ELEV. IN FEET)