

CERTIFIED RECORD OF LAND CORNER MONUMENTATION

HISTORY OF ORIGINAL CORNER ESTABLISHMENT:

Corner not previously established

No record of subsequent monumentation found in UNION COUNTY survey records.

DESCRIPTION OF CORNER EVIDENCE FOUND:

NONE

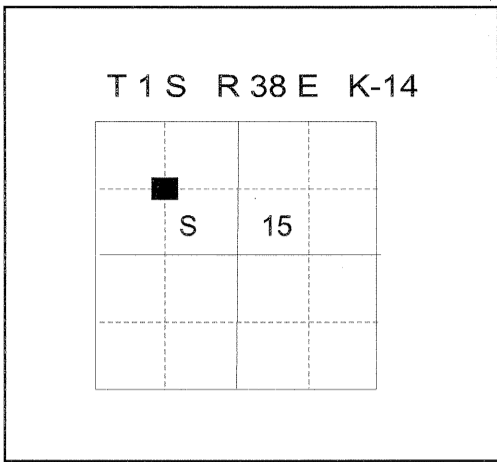

See Survey Number 004-2008.

DESCRIPTION OF MONUMENT AND ACCESSORIES I ESTABLISHED TO PERPETUATE THE ORIGINAL LOCATION OF THIS CORNER:

At position determined by survey, I set a 5/8" x 30" iron pin with 2 1/2" aluminum cap marked as shown below, 4" below gravel road surface, from which:

NEW BEARING OBJECTS:

A 22" Ponderosa Pine bears S. 88° E., a distance of 3.35 feet, marked NW 1/16 S15 BT.

A 28" Ponderosa Pine bears S. 15° E., a distance of 6.40 feet, marked X BT.

I hereby certify that the corner was monumented on February 29, 2008.

Witness: Gregory T. Blackman Jr., Jeff Hsu

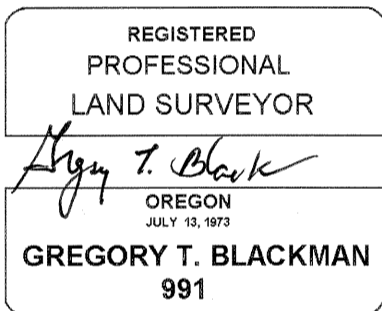

Renewal Date: Dec. 31, 2009

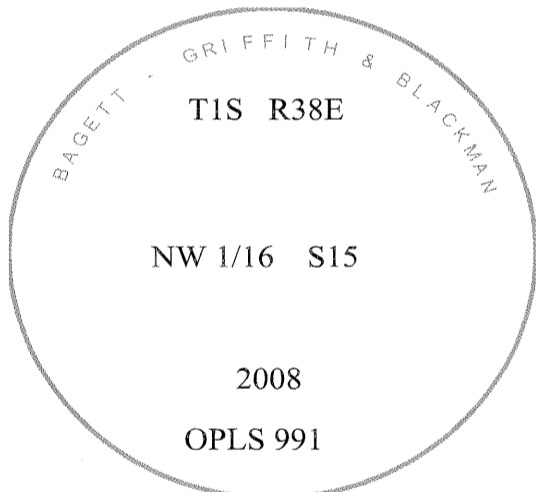

**UNION COUNTY
SURVEYOR**

Date Received 3/4/08

Date Filed 4/5/08

Filed By R. ROBINSON DEPUTY

File Number 004-2008 R

I used a steel tape and magnetic compass in the establishment of new bearing trees. The magnetic declination used was 18° East. The distance to the bearing tree is to a 50d spike driven on the right side of the tree at the root crown. I attached a brass washer marked OPLS 991 to the BT blaze.