

CERTIFIED RECORD OF LAND CORNER MONUMENTATION

HISTORY OF ORIGINAL CORNER ESTABLISHED:

Corner originally established by David P. Thompson under GLO contract 103, dated September 3rd, 1863. Surveyor General field notes state:

Set post for 1/4 sec. corner, earth, pits, trench, charred stake as per instructions.

Corner found in Union County Old Book Survey 357. Record states: 1/4 cor. in place.

Corner found in Union County Survey 112-73. Record states: Found shaft.

Corner found in Union County Survey 064-76. Record states: Found bolt at corner.

Corner found in Union County Survey 093-78. Record states: Found 5/8" iron pin.

Corner found in Union County Survey 098-79. Record states: Found 5/8" iron pin.

Corner found in Union County Survey 038-2019. Record states: Found 5/8" iron pin, 8" below gravel road surface.

T 1 S R 38 E E-23

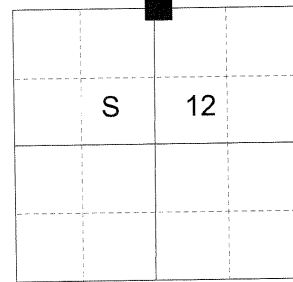

DESCRIPTION OF CORNER EVIDENCE FOUND:

Found 3/4" x 20" iron pin, 12" below the road surface of a North/South/West intersection.

DESCRIPTION OF MONUMENT AND ACCESSORIES I ESTABLISHED TO MONUMENT THE ORIGINAL LOCATION OF THIS CORNER:

At the position of the found iron pin, I remove the said pin and replace it with a 5/8" x 30" iron pin, 8" below the road surface, with a 2 1/2" aluminum cap marked as shown below, from which:

NEW BEARING OBJECTS:

- A 6" x 6" x 30" telecomm junction box bears North 15° East a dist. of 76.65 ft.
- A 5/8" x 30" iron pin bears South 55° East a dist. of 20.00 ft., with 1 1/2" aluminum cap marked SE RP.
- A 5/8" x 30" iron pin bears South 55° West a dist. of 30.80 ft., with 1 1/2" aluminum cap marked SW RP.
- A 6" x 6" x 30" telecomm junction box bears North 44° West a dist. of 45.30 ft.

Falls in the intersection of Behrens Ln. and Myers Rd.

I hereby certify that the corner was monumented on March 9, 2020.

Witness: Kyle A. Tucker

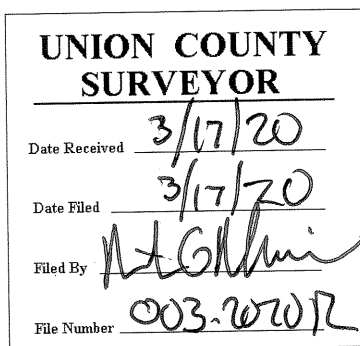
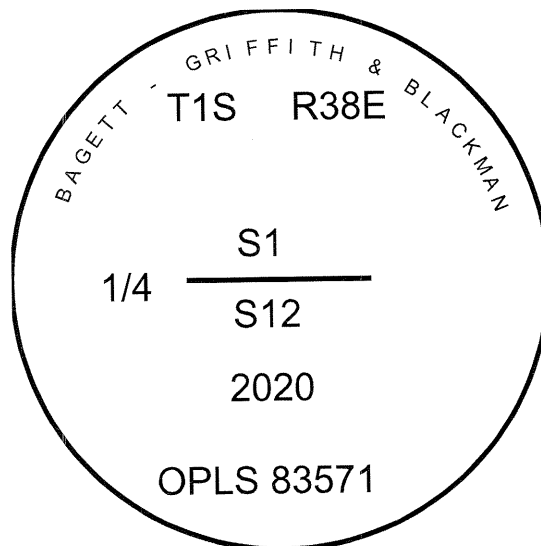
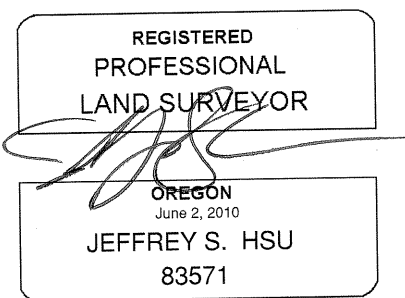

I used a Leica GS 18 in the establishment of the new accessories. Basis of Bearing is as per Union County Survey 038-2019. The distances and bearings are to the center of the aluminum caps or the center of the telecomm boxes.

HORIZONTAL CONTROL DATA

UNION COUNTY, OREGON

OREGON STATE PLANE, NORTH ZONE (3601)

STA NAME: 2020012

1/4 SECTION CORNER COMMON TO SECTIONS 1 AND 12

TWP. 1 S RGE. 38 E.

GEODETIC COORD: NAD 83(91)

DATE TIED: March 9, 2020

LAT: 45 ° 30 ' 1.69647 " N

SURVEYOR: RICK G. ROBINSON
OPLS 2219

LONG: 118 ° 0 ' 14.14814 " W

FIRM: BAGETT, GRIFFITH, & BLACKMAN
2006 ADAMS AVENUE
LAGRANDE, OR 97850
(541) 963-6092

SP. COOR: NAD 83(91)

N: 678444.321 INT FT.

E: 8841988.307 INT FT.

TYPE: GPS

THETA: 1 ° 46 ' 12.6404928 "

ORDER: SECOND CLASS: 1

SCALE FACTOR: 0.9999113204

ELEV: 2739.11 US FT.

ELEV: DATUM: NGVD 29

COMMENTS:

5/8" iron pin with 2 1/2" aluminum cap
marked as shown

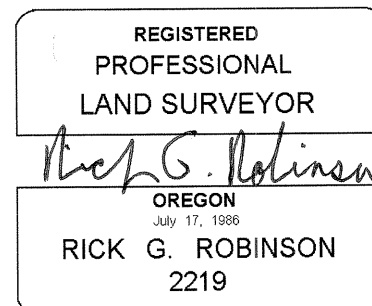
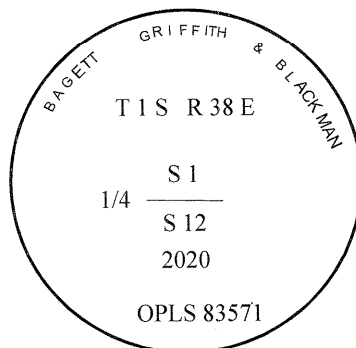

Renewal Date: December 31, 2020

1 METER = 3.280833333... US FEET = 39.37 INCHES

1 METER = 3.280839895 INT'L FEET OR 1 INCH = 2.54 CM

TO CALCULATE ELEVATION FACTOR (IN THE NORTH AMERICAN CONTINENT)

DIVIDE 20,906,000 BY (20,906,000 + ELLIPSOID ELEV. IN FEET)