

Index _____
 File No. A-9
 T 25 R. 36E R.D. LAGRANDE County UNION State OREGON
 Merid. Will N.F. W-W

CORNER RECORD (SEARCH)

(Ref. FSM 7151.4)

Tract or Survey No. _____ Cor. No. _____

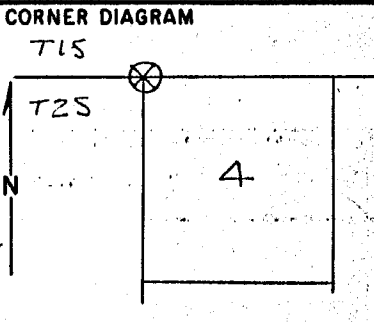

DESCRIBE CORNER MONUMENT FOUND
NONE

DESCRIBE BEARING TREES OR OTHER OFFICIAL ACCESSORIES FOUND
18" LARCH, STANDING, DEAD, SCRIBING USABLE IN GOOD CONDITION IN SEC 5
28" P.P. LIVE, GOOD COND. USABLE SCRIBING IN S4
14" LARCH DEAD & DOWN SCRIBING USABLE

PHOTO IDENTIFICATION DATA 7/8/68
 Photo No. ENW 4-188
 Filed At. _____
 Object Ident. _____
 Ident. By pin haly
Signature

DESCRIBE CORNER LOCATION RELATIVE TO NEAR-BY FEATURES, ALSO HOW TO REACH CORNER

PLANE COORDINATE POSITION DATA
 State _____ Zone _____
 X _____
 Y _____
 Estab. By _____
Agency

Signature D. K. [unclear] Title CET Division _____ Headquarters _____ Date 5-12-73 7100-52 (3/68)

UNION COUNTY SURVEYOR

Not Received _____

Date Filed 12-16-87

By G. LANGLITZ, DEPUTY

File No. 174-87R

A-9

CERTIFIED RECORD OF LAND CORNER MONUMENTATION

HISTORY OF ORIGINAL CORNER ESTABLISHMENT:

Corner originally established by John A. Hurlburt under GLO Contract Number 201, dated August 5, 1873. Surveyor General record states:

Set a pine post, 4 ft. long, 4 ins. square, 2 ft. in ground for cor to Sec 4, 5, 32 and 33.
Tamarack 12 in. dia. N30°W 16 lks.
Tamarack 18 in. dia. S34°W 30 lks.
Pine 18 in. dia. S69°E 13 lks.
Tamarack 24 in. dia. N82°E 35 lks.

T 1 S R 36 E Z-09

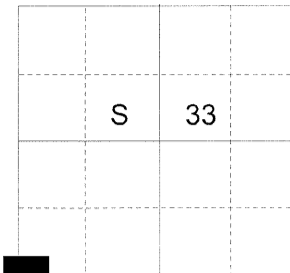

Union County monumentation record 174-87R is a Forest Service corner record. Record states:
18" Larch, Standing, Dead scribing visible in good condition in Sec 5
28" P.P Live, good conditions, visable scribing in S4.
14" Larch dead and down scribing visible.

DESCRIPTION OF CORNER EVIDENCE FOUND:

Found a steel fence post with BLM K-tag, from which:

A 30 inch pine stump bears South 69° East, a distance of 8.58 feet, no scribe marks visible.
A downed log with BT tag attached falls in the Northwest quadrant, no scribe marks visible, location indeterminate.

DESCRIPTION OF MONUMENT AND ACCESSORIES I ESTABLISHED TO PERPETUATE THE ORIGINAL LOCATION OF THIS CORNER:

At the record bearing and distance from the pine stump, I set a 2 1/2" x 30" aluminum pipe with 2 1/2" aluminum cap, marked as shown below, 26 inches in the ground, from which:

An 8 inch White Fir bears North 18° East, a distance of 10.50 feet, marked T1S R36E S33 BT.
An 8 inch Ponderosa Pine bears South 43° East, a distance of 59.35 feet, marked T2S R36 S4 BT.
A 4 inch Ponderosa Pine bears South 42° West, a distance of 25.00 feet, marked X BT.
An 11 inch White Fir bears North 79° West, a distance of 22.50 feet, marked T1S R36E S32 BT.

I set a steel fencepost 1 foot East of the corner monument.
I hereby certify that the corner was perpetuated on October 30, 2012.

Witness: Rick Robinson

REGISTERED
PROFESSIONAL
LAND SURVEYOR

Jeffery S. Hsu
OREGON
June 2, 2010
JEFFERY S. HSU
83571

Renewal Date: June 30, 2013

UNION COUNTY
SURVEYOR
Date Received 11/12/12
Date Filed 11/12/12
Filed By P. ROBINSON, DEPUTY
File Number 074-2012R

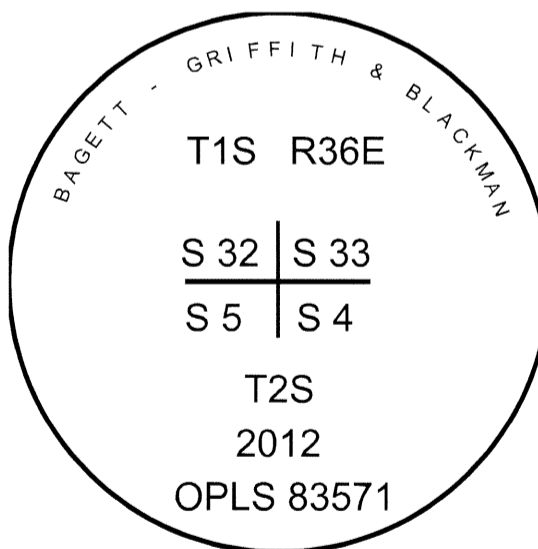

I used a steel tape and magnetic compass in the recovery of the bearing tree and establishment of new trees. I used 16° East magnetic declination and the bearings and distances are to the center of root crown on old bearing tree. Distance is to a 60d spike in the right hand side of the new trees. Bearing is to a brass washer marked OPLS 83571 in the lower BT blaze.