

*222*

USDA-FOREST SERVICE GPO 940-117

Index

File No. Z-1

**CORNER RECORD (SEARCH)**

(Ref. FSM 7151.4)

Tract or

Survey No. \_\_\_\_\_

Cor.

No. \_\_\_\_\_

T 1n

R. 416

R.D. Union

County Union

Merid. \_\_\_\_\_

N.F. W-W

State OR

**CORNER DIAGRAM**

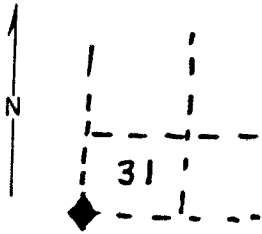

**DESCRIBE CORNER MONUMENT FOUND**

*None Found*

**DESCRIBE BEARING TREES OR OTHER OFFICIAL ACCESSORIES FOUND**

*20" PP stump*

**PHOTO IDENTIFICATION DATA**

Photo No. UBM-0 8-5-60

Filed At. 315 23 s/pa.

Object Ident. \_\_\_\_\_

Ident. By \_\_\_\_\_

*Signature*

**PLANE COORDINATE POSITION DATA**

State \_\_\_\_\_ Zone \_\_\_\_\_

X \_\_\_\_\_

Y \_\_\_\_\_

Estab. By \_\_\_\_\_

*Agency*

Signature

Title

Division

Headquarters

Date

7100-52 (3/68)

*10-9-63*

**UNION COUNTY SURVEYOR**

Date \_\_\_\_\_

Date \_\_\_\_\_

By \_\_\_\_\_

File No. 28-87R

*2-1*

UNION COUNTY  
 CERTIFIED RECORD OF LAND CORNER MONUMENTATION

**History of original corner establishment:**

Corner originally established by Timothy W. Davenport under GLO Contract Number 102, dated July 20, 1863. Surveyor General record states: Set post for cor. to secs. 31 & 36 Township 1 North Ranges 40 & 41 East from which:

A Red Fir 24 inch in dia bears N25°W 37 lks dist

A Pine 20 inch in dia bears N20°E 9 lks dist

A Pine 20 inch in dia bears S65°W 72 lks dist

Corner remonumented by Wayne L. Rogers, under BLM Group No. 350, Survey dated May 8-10, 1973. His record states:

The cor of Tps 1 N, Rs 40 and 41 E, determined at record bearing and distance from the remains of the original bearing trees; A

Pine snag, size indeterminate, bears N20°E, 9 lks dist, with

fragmentary scribe marks visible on open blaze. A Pine snag, 24 ins diam, bears S65°W, 79

lks dist no marks visible on open burned blaze (Record 72 lks). A Fir root crown, bears

N25°W, 37 lks dist, no marks visible. At the corner point set an iron post 28 ins long 2½

ins diam 24 ins in the ground with brass cap marked (see markings below) from which new

bearing trees; A Fir, 10 ins diam bears N55°E, 55 lks dist mkd T1N R41E S31 BT. A Fir 14

ins diam bears N56°W, 126 lks dist mkd T1N R40E S36 BT.

No record of subsequent monumentation found in Union County survey records.

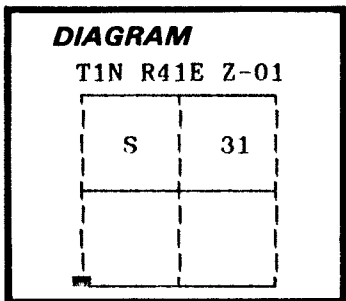

**Description of corner evidence found:**

Found 2½ inch diameter BLM brass cap marked as shown below.

**BLM Bearing Trees:**

Found a 12 inch diameter Douglas Fir N55°E, 55 lks live and vigorous with scribes visible.

Found a 16 inch diameter Douglas Fir N56°W, 126 lks live and vigorous with scribes visible.

Found the remains of the original GLO bearing trees as called in the BLM notes of Mr. Rogers.

T1N		R41E
R40E		R41E
S 36		S 31
S 6		
T1S R41E		
1973		

See Union County Map of Survey Number 059 - 1991.

**Description of monument and accessories I established to perpetuate the original location of this corner:**

NO ADDITIONAL REHABILITATION WAS DONE AT THIS CORNER

This monumentation sheet prepared to provide documentation of the existing corner monument and accessories.

I hereby certify that the above corner point was witnessed as hereon described on November 19, 1991.

Witnesses: Rick Robinson and Jeff Petersen

I used a steel tape and magnetic compass in the verification of the existing accessories. I used 20° East magnetic declination.

REGISTERED  
 PROFESSIONAL  
 LAND SURVEYOR

*Gregory I. Blackman*

OREGON  
 JULY 13, 1913  
 GREGORY I. BLACKMAN  
 991

UNION COUNTY  
 SURVEYOR

---

Witnessed 11/21/91  
 on 11/21/91  
 by R. ROBINSON, DEPUTY  
 File No. 033-1991E

## T. 1 S., R. 41 E., Willamette Meridian, Oregon

## CHAINS

The following field notes describe the remonumentation of certain original corner points, township 1 south, range 41 east, of the Willamette meridian, Oregon, as provided for in the General Special Instructions, Group 350, Oregon, dated May 3, 1957, "Investigation of Collateral or Physical Evidence of Corner Positions and Accessories, Followed by Remonumentation of Corner Points with New Accessories when Needed."

The remonumentations of the original corner points was made at the request of the United States Forest Service, Wallowa-Whitman National Forest, in conjunction with their Land Line Location Program.

The mean magnetic declination is 20° E.

North Boundary, T. 1 S., R. 41 E.  
(Willamette Base Line)  
Willamette Meridian, Oregon

(Remonumenting a corner established by Henry Meldrum, Deputy Surveyor, in 1862, and rehabilitated by Alonzo Gesner, Deputy Surveyor, in 1896)

The closing cor. of Tps. 1 S., Rs. 40 and 41 E., determined at record bearing and distance from the remains of the original bearing trees:

A fir, 10 ins. diam., bears N. 45° E.,  
24 lks. dist., with healed upper blaze  
and no marks visible on opened lower blaze.

and remains of the bearing trees mkd. by Alonzo Gesner, in 1896

A tamarack, 20 ins. diam., bears S. 34 $\frac{1}{2}$ ° W.,  
56 lks. dist., with scribe marks T1S R40E  
S1 visible on open blaze.

At the corner point

Set an iron post, 28 ins. long, 2 $\frac{1}{2}$  ins. diam., 20 ins. in the ground, with brass cap mkd.

T 1 N R 40 E  
S 36  
S 1 S 6  
R 40 E R 41 E  
T 1 S  
C C  
1973

from which new bearing trees

A fir, 15 ins. diam., bears S. 47° E.,  
110 lks. dist., mkd. T1S R41E S6 CC BT.

A fir, 10 ins. diam., bears S. 5 $\frac{1}{2}$ ° W.,  
61 lks. dist., mkd. T1S R40E S1 CC BT.

(Remonumenting a corner established by Timothy W. Davenport, Deputy Surveyor, in 1863 and rehabilitated by Henry Meldrum, Deputy Surveyor, in 1862)

The cor. of Tps. 1 N., Rs. 40 and 41 E., determined at

**UNION COUNTY  
SURVEYOR**

Date Received 3/15/13

Date Filed 3/15/13

By [Signature] DEPUTY

File No. 295-2013R

Remonumentation of Certain Original Corner Points,  
T. 1 S., R. 41 E., Willamette Meridian, Oregon

CHAINS

record bearing and distance, from the remains of the original bearing trees:

- A pine snag, size indeterminate, bears N. 20° E., 9 lks. dist., with fragmentary scribe marks visible on opened blaze.
- A pine snag, 24 ins. diam., bears S. 65° W., 79 lks. dist., no marks visible on open burned blaze. (Record, 72 lks.)
- A fir root crown, size indeterminate, bears N. 25° W., 37 lks. dist., no marks visible.

At the corner point

Set an iron post, 28 ins. long, 2½ ins. diam., 24 ins. in the ground, with brass cap mkd.

T I N  
R 40 E R 41 E  
S 36 S 31  
S 6  
T 1 S R 41 E  
1973

TIN 41201

from which new bearing trees

- A fir, 10 ins. diam., bears N. 55° E., 55 lks. dist., mkd. TIN R41E S31 BT.
- A fir, 14 ins. diam., bears N. 56° W., 126 lks. dist., mkd. TIN R40E S36 BT.

(Remonumenting a corner established by Henry Meldrum, Deputy Surveyor, in 1882)

The ¼ sec. cor. of sec. 31 only, on S. bdy. T. 1 N., R. 41 E., determined at record bearing and distance, from the remains of the original bearing trees

- A white fir, 35 ins. diam., bears N. 10° E., 14 lks. dist., with scribe marks ¼ S 31 BT visible on open double blaze.

At the corner point

Set an iron post, 28 ins. long, 2½ ins. diam., 24 ins. in the ground, with brass cap mkd.

T I N R 41 E  
S 31  
1973

TIN 41203

from which a new bearing tree

- A fir, 16 ins. diam., bears N. 82° W., 49 lks. dist., mkd. ¼ S 31 BT.

The corner is located in fence line extends E. and W.

(Remonumenting corners established by William R. Odell, Deputy Surveyor, in 1866, reestablished by Henry Meldrum, Deputy Surveyor, in 1882, and rehabilitated by Lonzo Gesner, Deputy Surveyor, in 1890)

<b>UNION COUNTY SURVEYOR</b>	
Date Received	3/15/13
Date Filed	3/15/13
By	<i>[Signature]</i> DEPUTY
File No.	295-2013R