

CERTIFIED RECORD OF LAND CORNER MONUMENTATION

History of original corner establishment:

Corner was never established.

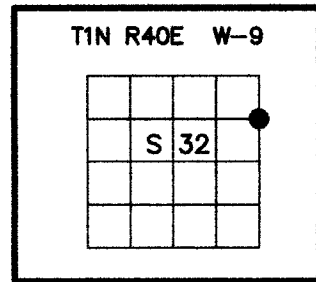

Description of corner evidence found:

Description of monument and accessories I established to perpetuate original location of this corner:

At the position determined by survey, Union County Survey No. 045-2002;

Set a 3 1/4 in. dia. alum. cap on a 5/8 in. dia. by 30 in. long iron rod, buried 17 ins. in the ground, the bottom 5 in. being in a 5/8 in. drill hole and secured with Rockite cement, surrounded by rock mound built to top of monument cap with t-post set 0.7 ft. easterly.

Marked as shown:

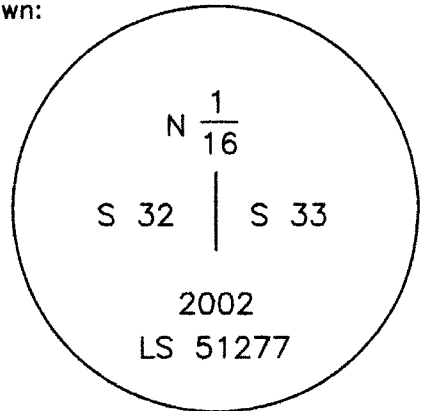

From which:

A 5/8 in. dia. by 30 in. long iron rod with yellow plastic cap mkd: ELDER LS 51277, bears N 89° E, 15.6 ft. dist. with rock collar and silver DEEP-1 magnet buried alongside at base.

A 5/8 in. dia. by 30 in. long iron rod with yellow plastic cap mkd: ELDER LS 51277, set in center of a found rock mound (apparent unrecorded 1/16 cor.), 5 ft. dia. and 20 ins. high, bears S 44° W, 13.0 ft. dist. with blue DEEP-1 magnet buried alongside at base.

I hereby certify that the corner was monumented as described and accessories were taken on Oct. 21, 2002, with a hand compass set at 18 1/2° E. declination and steel tape.

Witness: Peter C. Elder

REGISTERED
PROFESSIONAL
LAND SURVEYOR

OREGON
JULY 13, 1999
PETER C. ELDER
51277

Renewal Date: Dec. 31, 2003

UNION COUNTY
SURVEYOR

Date Received 12/02/02

Date Filed 12/31/02

By [Signature]

No. 051-2002R