

RECOVERY NOTES  
BOISE CASCADE CORP.  
PROPERTY CORNER INVESTIGATION

V-21  
LOCATION

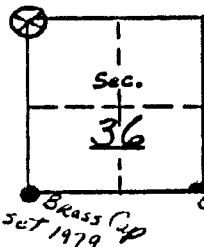

T. 1 N R. 40 E  
Mer. W/M State OR  
Forest Dist. Elgin  
Compartment or Tract MT HARRIS

LEGEND  
○ Corner searched-no evidence  
⊗ Corner or accessory found  
● Corner marked by perm. mon.

DESCRIPTION OF FOUND CORNER

MATERIAL: \_\_\_\_\_ SIZE: \_\_\_\_\_  
HEIGHT ABOVE GROUND: \_\_\_\_\_ CONDITION: \_\_\_\_\_  
MARKINGS: \_\_\_\_\_

DESCRIPTION OF FOUND ACCESSORIES

Pine 9 in dia N15E 25.1 FT  
(App 17" 1983) Scribing (S25) visible  
Pine 8 in dia S70E 71.3 FT - Stump hole  
SW & NW BT's not found.

Note: Indicate full investigative details on back of form and where  
cruise tag placed in reference to corner.

PHOTO IDENTIFICATION

Symbol & date 1977 Line or Roll 16-10 Exposure \_\_\_\_\_  
How Identified \_\_\_\_\_ Where filed \_\_\_\_\_

RECOVERED BY: R. McVey

DATE: 2-3-83 TITLE: Forest Tech

There is a chip/scribing laying  
on the Stump hole in SE quadrant  
but I do not feel that it belongs  
there..

<b>UNION COUNTY SURVEYOR</b>	
Date Received	<u>1-4-88</u>
Date Filed	<u>1-7-88</u>
By	<u>G. LANGLITZ, DEPUTY</u>
File No.	<u>34-88R</u>

V-21

**CERTIFIED RECORD OF LAND CORNER MONUMENTATION**

**HISTORY OF ORIGINAL CORNER ESTABLISHMENT:**

Corner originally established by William H. Odell & Joseph Gray under Joint GLO Contract Number 120, dated May 27, 1867. Surveyor General record states:

Set post for cor. to secs. 25, 26, 35 and 36 FROM WHICH:

- A Pine 9" diameter , bears N 15° E, 38 lks dist, marked T1N R 40 E S25 BT.
- A Pine 8" diameter, bears S 70° E, 108 lks. dist. marked T1N R 40E S 36 BT.
- A Pine 14" diameter, bears S 25° W, 213 lks. dist. marked T1N R 40E, S 35 BT
- A Pine 12" diameter, bears N 70 W, 140 lks. dist. marked T1N R 40E S 26 BT.

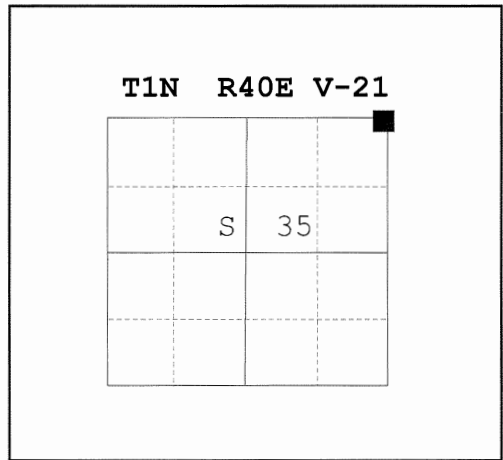

No record of subsequent monumentation found in Union County survey records

**DESCRIPTION OF CORNER EVIDENCE FOUND:**

- NE BT.  
Found an 18" Ponderosa Pine Snag, dead and standing with scribes visible.
- SE BT.  
Found Stump hole at the record position of the SE BT.

**DESCRIPTION OF MONUMENT AND ACCESSORIES I ESTABLISHED TO PERPETUATE THE ORIGINAL LOCATION OF THIS CORNER:**

At the record bearing and distance from the found bearing tree, I set a 2½ x 30 " aluminum pipe with aluminum cap marked as shown, 24 inches in the ground from which;

**New Bearing Trees:**

- A 16 inch diameter Douglas Fir Bears N 45°E, a distance of 45.57 feet, marked T1N R40E S 25 BT.
- A 13 inch diameter Ponderosa Pine bears S 40°E a distance of 75.56 feet, marked T1N R40E S 36 BT.
- A 9 inch diameter Ponderosa Pine bears S 49°W, a distance of 12.48 feet, marked T1N R40E S 35 BT.
- A 13 inch diameter Douglas Fir bears N 46°W, a distance of 21.15 feet, marked T1N R40E S 26 BT. I placed the spike on the left of the root crown for measurement.

NOTE: This monumentation record was not filed at the time of monumentation. This documentation was found in our records. I am filing this to document the monumentation of this corner in 1991.

I hereby certify that the above corner point was perpetuated as hereon described on July 17, 1991.

REGISTERED  
PROFESSIONAL  
LAND SURVEYOR

Witness: Jim Bennett & John Osterman

*Gregory T. Blackman*  
OREGON  
JULY 13, 1973  
GREGORY T. BLACKMAN  
991

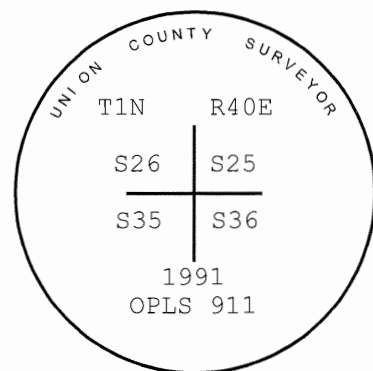

Renewal Date: Dec. 31, 2017

I used a steel tape and magnetic compass in the establishment of the new accessories. I used 17° East declination, the distances are to a 50d spike driven in the right side of the root crown, except as stated above. I attached a brass washer marked OPLS 991 to the bearing tree blaze.

UNION COUNTY  
SURVEYOR  
Date Received 10/4/16  
Date Filed 10/4/16  
Filed By *[Signature]*  
File Number 039-201612