

**CERTIFIED RECORD OF LAND CORNER MONUMENTATION**

**HISTORY OF ORIGINAL CORNER ESTABLISHMENT:**

Corner originally established by William H. Odell deputy surveyor under joint contract with Joseph G. Gray, contract no. 120 dated May 27, 1867.

Surveyor's record states: Set post  
 14" Pine bears N85E, 100 lks.  
 12" Pine bears N5W, 60 lks.  
 14" Pine bears S30E, 80 lks.

Survey 049-1992 calls finding the original bearing trees.

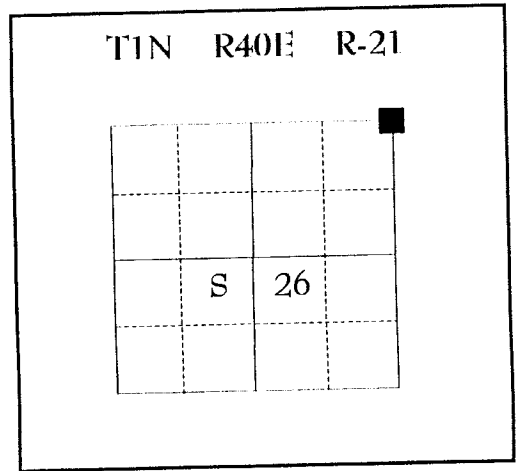

No record of subsequent monumentation found in Union County survey records  
**DESCRIPTION OF CORNER EVIDENCE FOUND:**

- Found 48" Ponderosa Pine bearing N85E, 100 lks. Alive and vigorous with blaze evident.
  - Found 46" Ponderosa Pine bearing N5W, 60 lks. Alive and vigorous with blaze evident.
  - Found 18" Ponderosa Pine stump bearing S30E, 80 lks. Scribes visible.
- A 60d nail was found at the record bearings and distances from the bearing trees, nail is believed to be from survey 049-1992.

See survey 017-1995

**DESCRIPTION OF MONUMENT AND ACCESSORIES I ESTABLISHED TO PERPETUATE THE ORIGINAL LOCATION OF THIS CORNER:**

At record bearings and distances from the found bearing trees and at the position of the 60d nail a 2 1/2" x 30" aluminum pipe monument with 2 1/2" cap marked as shown below was set 26" in the ground with a mound of stone 3 feet at the base raised around the pipe.

**NEW BEARING TREE AND REFERENCE:**

A 10" Ponderosa Pine bears S46W, 134.22 feet, marked T1N R40E S26 BT.  
 A 5/8" x 30" iron pin (rebar) bears S47E, 8.29 feet, with 1 1/2" aluminum cap marked "UNION COUNTY SURVEYOR SE RP".

I hereby certify that the above corner point was perpetuated as hereon described on May 22, 1995.

Witness: Jeff Petersen, Peter Crabtree

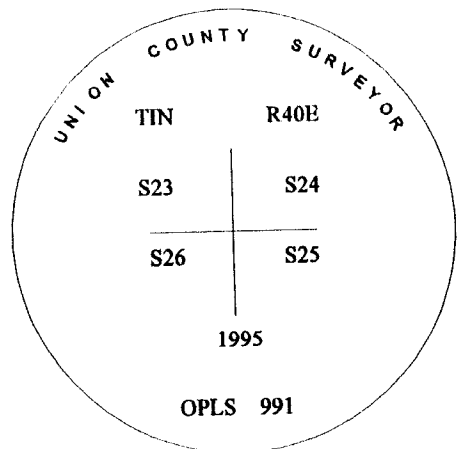

REGISTERED  
 PROFESSIONAL  
 LAND SURVEYOR

*Gregory T. Blackman*  
 OREGON  
 JULY 13, 1973  
**GREGORY T. BLACKMAN**  
 991

*Renewal Date: December, 31 1995*

**UNION COUNTY  
 SURVEYOR**

Date Received 6-1-95  
 Date Filed 6-1-95  
 Filed By J. Petersen, Deputy  
 File Number 008-1995R

I used a steel tape and magnetic compass in the establishment of the new accessories. I used 18° East declination, the distances are to a 50d spike driven in the right side of the root crown, or to the center of the aluminum cap, (on rebars). I attached a brass washer marked OPLS 991 to the bearing tree blaze.