

CERTIFIED RECORD OF LAND CORNER MONUMENTATION

History of original corner establishment:

Corner established by Odell and Gray in 1867 under GLO contract number 120, dated February 7, 1868.

Record states:

Set sec cor for secs 21, 22, 27, 28. Drove charred stake, and raised stone mound as per instructions.

Township 1 North, Range 40 East
R-13

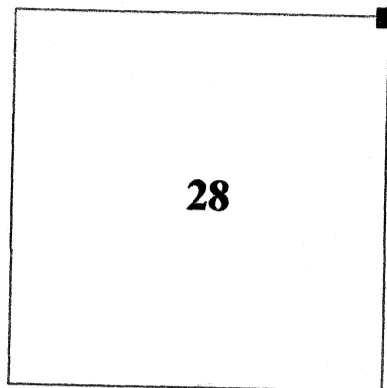

Subsequent survey:

Corner recovered in 1992 as per CS NO. 042-1992 by James H. Hambleton, PLS 645 as filed in the Union County Surveyor's office.

Record states:

Found mound of stone at an existing four-way fence corner that fits the GLO notes. Billy Hindman local long-time rancher told me this was a section corner and also a corner of his property. I accepted the position as a valid corner.

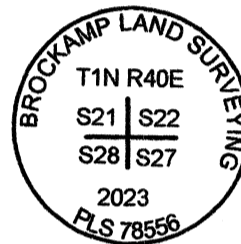

Description of evidence found:

Found four-way fence corner

Description of monument and accessories established to perpetuate the location of this corner.

Set an aluminum pipe, 2 1/2 ins. diam., firmly set, projecting 4 ins. above the ground in a collar of stone, with 3 1/4 ins. aluminum cap mkd. as shown.

New Accessories:

A basalt stone, 1 ft. by 1 ft. by 2 ft., bears N. 63° E., 9.2 ft. dist., marked XBO 1.

A basalt stone, 1 ft. by 2 ft. by 1 ft., bears S. 2° E., 20.9 ft. dist., marked XBO 2.

A ponderosa pine, 25 ins. diam., bears S. 39° W., 57.6 ft. dist., marked T 1 N R 40 E S 28 BT on a single blaze.

An iron rod, 3/8 ins. diam., 30 ins. long, with aluminum cap, 2 ins. diam. marked RM1, bears N. 55° W., 14.4 ft. dist.

Bearings are made with a hand compass, magnetic declination = 15°E.

I hereby certify that the above corner point was perpetuated as herein described on 8/29/2023.

Witnessed by:

Matt Brockamp, LS
Austin Brockamp

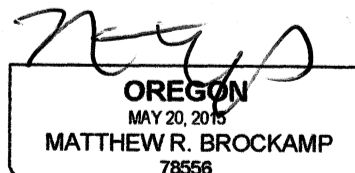
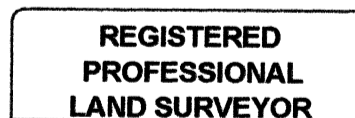

Registration expires 12/31/2023

UNION COUNTY SURVEYOR	
Date Received	9/18/23
Date Filed	9/18/23
Filed By	
File Number	043-2023R

BROCKAMP LAND SURVEYING, LLC
www.brockamplandsurveying.com
Matt Brockamp, PLS
541-398-0384
matt@brockamplandsurveying.com
PO. Box 553
Wallowa, OR 97385
Full Service Land Survey Firm