

CERTIFIED RECORD OF LAND CORNER MONUMENTATION

HISTORY OF ORIGINAL CORNER ESTABLISHMENT:

Corner not previously established.

No record of monumentation found in Union County survey records.

DESCRIPTION OF CORNER EVIDENCE FOUND:

NONE

See Survey Number 033-2004

DESCRIPTION OF MONUMENT AND ACCESSORIES I ESTABLISHED TO PERPETUATE THE ORIGINAL LOCATION OF THIS CORNER:

At position determined by survey, I set a 5/8" x 30" iron pin with 2 1/2" aluminum cap, marked as shown, 26 inches in the ground from which:

NEW BEARING OBJECTS:

A 5/8 inch iron pin with 2 inch aluminum cap marked "BGB SURVEY MARKER SE RP" bears S 71°03' E, a distance of 41.79 feet.

A 5/8 inch iron pin with 2 inch aluminum cap marked "BGB SURVEY MARKER NW RP" bears N 6°05' W, a distance of 22.48 feet.

Raised mound of stone around monument, 2 ft. base to top of cap. Set steel fence post approximately 1 ft. North of corner monument.

I hereby certify that the corner was monumented on October 13, 2004.

T 1 N R 39 E N-10

	S	21

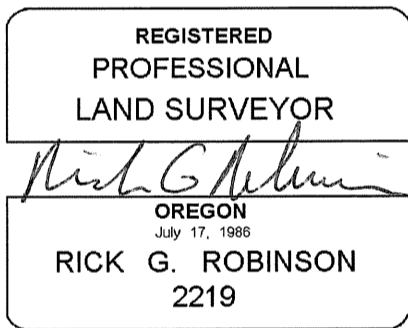

Renewal Date December 31, 2004

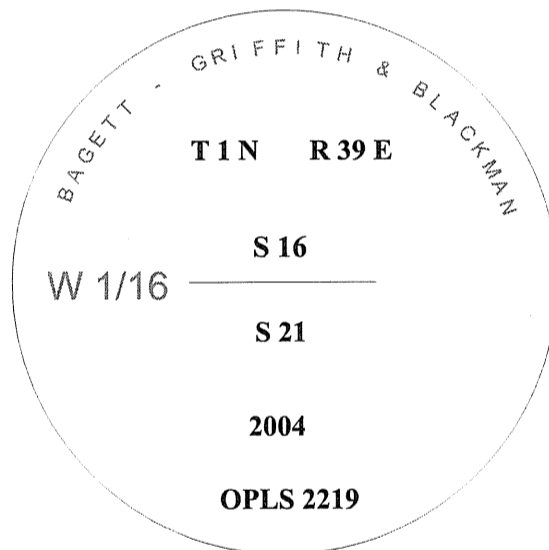

**UNION COUNTY SURVEYOR**

Date Received 11/15/04

Date Filed 11/16/04

Filed By [Signature]

File Number 046-2004R

I used Leica GPS System 530 in the establishment of the new bearing objects. The basis of bearing is that of survey number 033-2004. Distances are to the center of the bearing objects.