

CERTIFIED RECORD OF LAND CORNER MONUMENTATION

N-5

History of original corner establishment:

Corner originally established by John W. Kimbrell under GLO contract number 579 dated June 22, 1891.

Surveyor General record states:

Set post corner for sections 17, 18, 19 + 20, deposited marked stone, and raised stone mound as per instructions

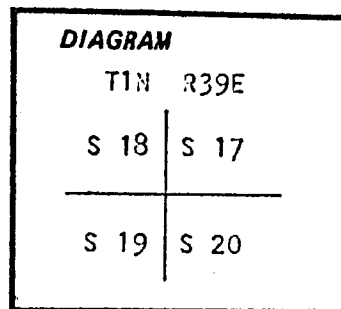

Description of corner evidence found:

Found stone 20x10x10 inches with faint marks, in mound of stone

This corner was used and position proved in Survey number 111-78

Description of monument and accessories established to perpetuate the original location of this corner:

In place of marked stone, I set a 2 1/2 inch x 30 inch galvanized iron pipe with brass cap marked as shown, 14 inches in the ground,

Buried stone East and alongside monument

Raised mound of stone around monument

Set steel fence post approximately 5 feet North of monument with 54-4 sign and Bearing Tree sign attached

No bearing trees available

Witness: Rick Robinson
Corner set on August 25, 1983

See map of survey number 30-83

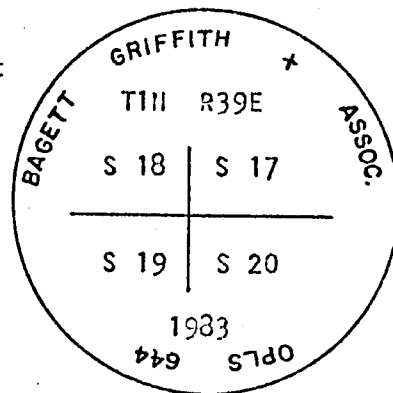

REGISTERED
PROFESSIONAL
LAND SURVEYOR

Duane I. Griffith

OREGON
JULY 10, 1904
DUANE I. GRIFFITH
644

Office of..... County of.....

State of....., I hereby certify that the within instrument was filed in this office for record on the..... day of....., 19.....

..... by
(COUNTY OFFICIAL) (DEPUTY)

UNION COUNTY SURVEYOR
Date Received <u>8-31-83</u>
Date Filed <u>9-12-83</u>
By <u>G. LANGLITZ, DEPUTY</u>
File No. <u>327-83 R</u>

CERTIFIED RECORD OF LAND CORNER MONUMENTATION

HISTORY OF ORIGINAL CORNER ESTABLISHED:

Corner originally established by John W. Kimbrell under GLO Contract Number 579, dated June 22, 1891. Surveyor General Record states:
Set post corner for sections 17, 18, 19 + 20, deposited marked stone, and raised stone mound as per instructions.

In 1983, Duane Griffith monumented this corner from found original evidence. Union County Monumentation Record 327-83R states:

Found stone 20x10x10 inches with faint marks, in mound of stone.

In place of marked stone, I set a 2 ½ inch x 30 inch galvanized iron pipe with brass cap marked as shown, 14 inches in the ground.

Buried stone East and alongside monument. Raised mound of stone around monument.

T 1 N R 39 E N-05

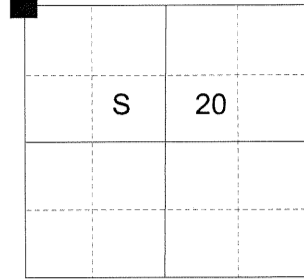

DESCRIPTION OF CORNER EVIDENCE FOUND:

Found a 2 ½" iron pipe with a 2 ½" brass cap, marked as shown below, 24" above ground in a mound of stone 3 feet in diameter. I find this monument leaning and mound of stone falling apart. With no bearing objects to aid, I stand this monument upright, and rebuild mound to be 3.5 feet diameter from base to the top of cap. I then add new accessories.

DESCRIPTION OF MONUMENT AND ACCESSORIES I ESTABLISHED TO PERPETUATE THE ORIGINAL LOCATION OF THIS CORNER:

From the iron pipe monument

NEW BEARING OBJECTS:

- A 5/8" X 15" iron pin bears North 81° East, a distance of 13.80 feet, with a 1 ½" aluminum cap marked UNION COUNTY SURVEYOR E RP.
- A 5/8" X 15" iron pin bears North 87° East, a distance of 19.20 feet, with a 1 ½" aluminum cap marked UNION COUNTY SURVEYOR N RP.
- A 5/8" X 15" iron pin bears South 2° West, a distance of 17.20 feet, with a 1 ½" aluminum cap marked UNION COUNTY SURVEYOR S RP.
- A 5/8" X 15" iron pin bears North 88° West, a distance of 16.85 feet, with a 1 ½" aluminum cap marked UNION COUNTY SURVEYOR W RP.

I found a steel fencepost approximately 5 foot Northeast of corner monument.

I hereby certify that the corner was perpetuated on September 16, 2015.

Witness: Thomas J. Kopp

REGISTERED
PROFESSIONAL
LAND SURVEYOR

Rick G. Robinson

OREGON
July 17, 1986
RICK G. ROBINSON
2219

Renewal Date: December 31, 2016

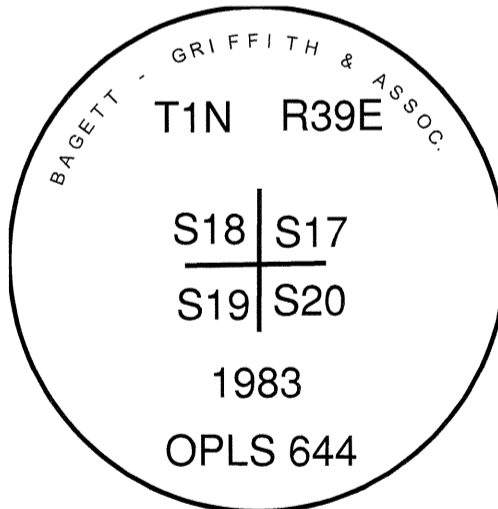

UNION COUNTY SURVEYOR

Date Received 9/22/15

Date Filed 9/22/15

Filed By *J. J. [Signature]*

File Number 136-2015R

I used a steel tape and magnetic compass in the establishment of the new accessories. I used 15° East declination.

HORIZONTAL CONTROL DATA

UNION COUNTY, OREGON

OREGON STATE PLANE, NORTH ZONE (3601)

STA NAME: 201527

SECTION CORNER COMMON TO SECTIONS 17, 18, 19 AND 20

TWP. 1 N. RGE. 39 E.

GEODETIC COORD: NAD 83(91)

DATE TIED: September 16, 2015

LAT: 45 ° 33 ' 29.43601 " N

SURVEYOR: RICK G. ROBINSON
OPLS 2219

LONG: 117 ° 58 ' 26.04212 " W

FIRM: BAGETT, GRIFFITH, & BLACKMAN
2006 ADAMS AVENUE
LAGRANDE, OR 97850
(541) 963-6092

SP. COOR: NAD 83(91)

N: 699713.187 INT FT.

E: 8849026.366 INT FT.

TYPE: GPS

THETA: 1 ° 47 ' 29.3077654 "

ORDER: SECOND CLASS: 1

SCALE FACTOR: 0.9999176579

ELEV: 3272.93 US FT.

ELEV: DATUM: NGVD 29

COMMENTS:

2 ½" brass cap monument marked
as shown in a mound of stone

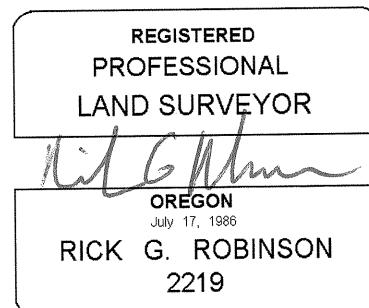
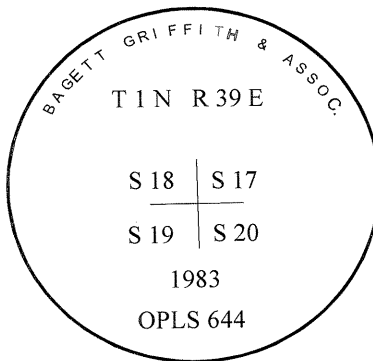

Renewal Date: December 31, 2016

1 METER = 3.2808333333... US FEET = 39.37 INCHES

1 METER = 3.280839895 INT'L FEET OR 1 INCH = 2.54 CM

TO CALCULATE ELEVATION FACTOR (IN THE NORTH AMERICAN CONTINENT)

DIVIDE 20,906,000 BY (20,906,000 + ELLIPSOID ELEV. IN FEET)