

CERTIFIED RECORD OF LAND CORNER MONUMENTATION

HISTORY OF ORIGINAL CORNER ESTABLISHED:

Corner originally established by Timothy Davenport in GLO contract no. 102, dated July 20, 1863. Surveyor General field notes state:

Set gr. Sec. post. Made mound of earth and drove charred stake as per inst.

Union County road petition 412 (currently Palmer Junction Road and a portion of Gordon Creek Road) calls to the South line of Section 32. No specific mention of monument at quarter corner position.

In Survey Number 108-77, James Hambleton uses the position of the intersection of a North/South fence line and the centerline of the county road for the quarter corner position. No monument set.

T 2 N R 39 E Z-15

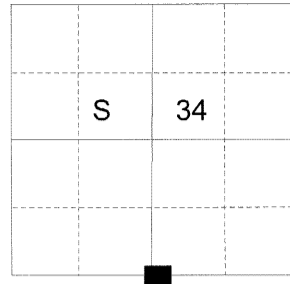

DESCRIPTION OF CORNER EVIDENCE FOUND:

No remains of the original corner could be found. I find the intersection of a fenceline to the South and the centerline of Gordon Creek road to be harmonious with GLO distances and accept this as the position of corner, as per survey number 108-77.

SEE SURVEY NUMBER 025-2014

DESCRIPTION OF MONUMENT AND ACCESSORIES I ESTABLISHED

TO PERPETUATE THE ORIGINAL LOCATION OF THIS CORNER:

At a point N0°08'33"W, 30.00 feet from the position as established above, I set a 2 1/2" x 30" aluminum pipe with 2 1/2" aluminum cap marked as shown below, 24" in the ground, in a collar of stone, 2 ft. diam., from which:

- A 5/8" iron pin bears North 19° East, a distance of 22.27 feet, with 1 1/2" aluminum cap marked BGB SURVEY MARKER NE RP.
- A 5/8" iron pin bears South 26° East, a distance of 60.85 feet, with 1 1/2" aluminum cap marked BGB SURVEY MARKER SE RP.
- A Power pole bears South 2° West, a distance of 56.20, with tag marked "#022034897"
- A 5/8" iron pin bears North 31° West, a distance of 24.20 feet, with 1 1/2" aluminum cap marked BGB SURVEY MARKER NW RP.

Witness corner falls North of Gordon Creek Road.
Set a steel fencepost approximately 1 ft North of corner monument.

I hereby certify that the corner was monumented on August 29, 2014.

Witness: Thomas J. Kopp

UNION COUNTY SURVEYOR

Date Received 9/9/14

Date Filed 9/9/14

Filed By [Signature]

File Number 050-20AR

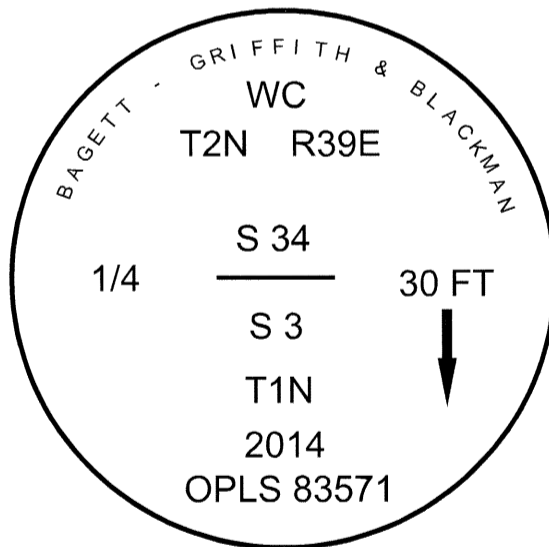

REGISTERED PROFESSIONAL LAND SURVEYOR

[Signature]

OREGON
June 2, 2010

JEFFREY S. HSU
83571

Renewal Date: June 30, 2015

I used a steel tape and magnetic compass in the establishment of the new accessories. I used 16° East declination. Bearings and distances are to the center of the aluminum cap and to the center of the power pole. Distances to the power pole are to a 60d spike in the right hand side of the pole.

HORIZONTAL CONTROL DATA

UNION COUNTY, OREGON

OREGON STATE PLANE, NORTH ZONE (3601)

STA NAME: 201528

WITNESS TO 1/4 SECTION CORNER COMMON TO SECTIONS 3 AND 34

TWP. 1 & 2N RGE. 39 E.

GEODETIC COORD: NAD 83(91)

DATE TIED: September 16, 2015

LAT: 45 ° 36 ' 7.25210 " N

SURVEYOR: RICK G. ROBINSON
OPLS 2219

LONG: 117 ° 55 ' 18.52839 " W

FIRM: BAGETT, GRIFFITH, & BLACKMAN
2006 ADAMS AVENUE
LAGRANDE, OR 97850
(541) 963-6092

SP. COOR: NAD 83(91)

N: 716110.296 INT FT.

E: 8861851.260 INT FT.

TYPE: GPS

THETA: 1 ° 49 ' 42.2898843 "

ORDER: SECOND CLASS: 1

SCALE FACTOR: 0.9999231527

ELEV: 2775.67 US FT.

ELEV: DATUM: NGVD 29

COMMENTS:

2 1/2" aluminum cap monument marked as shown. Corner is a Witness Corner set N0°08'33"W, 30.00 ft. from true corner position

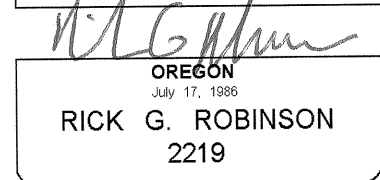
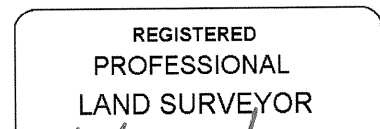
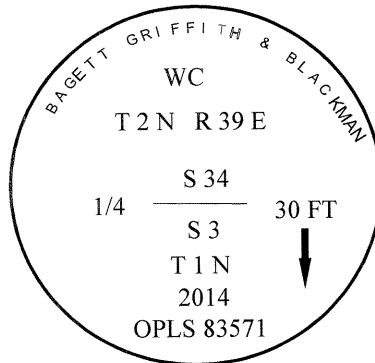

Renewal Date: December 31, 2016

1 METER = 3.2808333333... US FEET = 39.37 INCHES

1 METER = 3.280839895 INT'L FEET OR 1 INCH = 2.54 CM

TO CALCULATE ELEVATION FACTOR (IN THE NORTH AMERICAN CONTINENT)

DIVIDE 20,906,000 BY (20,906,000 + ELLIPSOID ELEV. IN FEET)