

CERTIFIED RECORD OF LAND CORNER MONUMENTATION

History of original corner establishment:

Original General Land Office Survey by  
Timothy W. Davenport, Contract No. 102, 1863, states:

Set a post by side of road, from which:

- A Pine 30" bears N 48° E 259 links,
- A Pine 24" bears N 67° E 405 links.

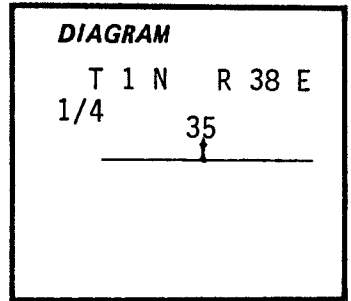

Description of corner evidence found:

No evidence found.

Refer to Union County Survey No. 35-87

Description of monument and accessories I established to perpetuate the original location of this corner:

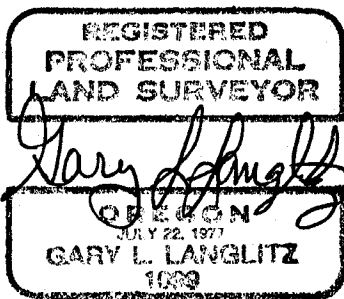

November 15, 1987  
Gary L. Langlitz, Deputy County Surveyor  
Jeff Langlitz

**UNION COUNTY  
SURVEYOR**

---

Date Received 12-8-87

Date Filed 12-8-87

By G. LANGLITZ, DEPUTY

File No. 169-87 R

Office of..... County of.....  
 State of..... I hereby certify that the within instrument was filed in this office  
 for record on the..... day of....., 19.....  
 ..... by .....

(COUNTY OFFICIAL) (DEPUTY)

**CERTIFIED RECORD OF LAND CORNER MONUMENTATION**

**HISTORY OF ORIGINAL CORNER ESTABLISHMENT:**

Corner was set in the original survey of the Base Line by Timothy W. Davenport under General Land Office contract number 102, dated July 20, 1863.

GLO notes state;

Set post for quarter section corner, from which;

A pine 30 in. dia. bears N 48°E, 259 lks. dist.

A pine 24 in. dia. bears N 67°E, 405 lks. dist.

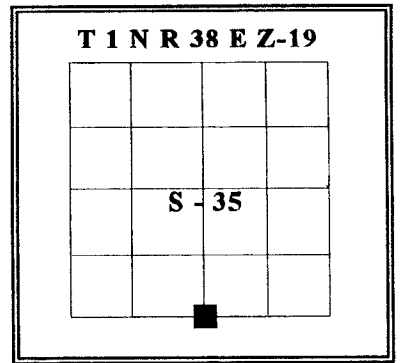

No record of subsequent monumentation found in the Union County Survey records.

**DESCRIPTION OF CORNER EVIDENCE FOUND:**

None. Area is under cultivation .

See Map of Survey Number 022-1997.

**DESCRIPTION OF MONUMENT AND ACCESSORIES I ESTABLISHED TO PERPETUATE THE ORIGINAL LOCATION OF THIS CORNER:**

At the position of an old fence corner, in an existing E-W fence line, I set 2-1/2 inch by 30 inch aluminum pipe with aluminum cap marked as shown, 30 inches in the ground.

From which, new B Os;

- A 5/8" by 30" rebar bears N 56°E, 11.83 feet, with 1-1/2" aluminum cap marked "UCS NE RP".
- A 5/8" by 30" rebar bears S 57°E, 6.06 feet, with 1-1/2" aluminum cap marked "UCS SE RP".
- A 5/8" by 30" rebar bears S 57°W, 7.32 feet, with 1-1/2" aluminum cap marked "UCS SW RP".
- A 5/8" by 30" rebar bears N 53°W, 10.34 feet, with 1-1/2" aluminum cap marked "UCS NW RP".

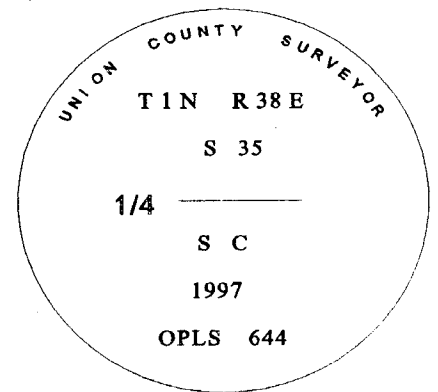

I hereby certify that the above corner point was perpetuated as hereon described on July 23, 1997.

Witnessed by: Jeff Madsen  
Greg Blackman Jr.

I used a steel tape and magnetic compass in the establishment of new accessories. I used 18° east declination and the measurement was taken to the center of the aluminum cap on the rebar.



*Renewal Date July 30, 1999*

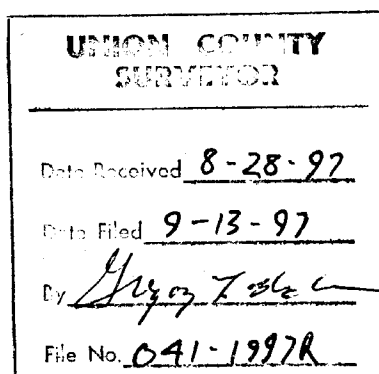

# HORIZONTAL CONTROL DATA

## UNION COUNTY, OREGON

### OREGON STATE PLANE, NORTH ZONE (3601)

STA NAME: 201512

1/4 SECTION CORNER COMMON TO SECTION 35 ONLY

TWP. 1 N. RGE. 38 E.

GEODETIC COORD: NAD 83(91)

DATE TIED: February 19, 2015

LAT: 45 ° 30 ' 53.17661 " N

SURVEYOR: RICK G. ROBINSON  
OPLS 2219

LONG: 118 ° 0 ' 17.16729 " W

FIRM: BAGETT, GRIFFITH, & BLACKMAN  
2006 ADAMS AVENUE  
LAGRANDE, OR 97850  
(541) 963-6092

SP. COOR: NAD 83(91)

N: 683649.074 INT FT.

E: 8841612.374 INT FT.

TYPE: GPS

THETA: 1 ° 46 ' 10.4993487 "

ORDER: SECOND CLASS: 1

SCALE FACTOR: 0.9999127961

ELEV: 2885.32 US FT.

ELEV: DATUM: NGVD 29

COMMENTS:

2 ½" Aluminum monument in  
East-West fenceline

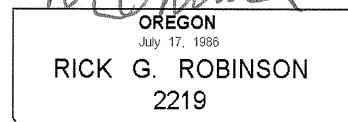
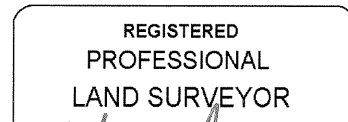
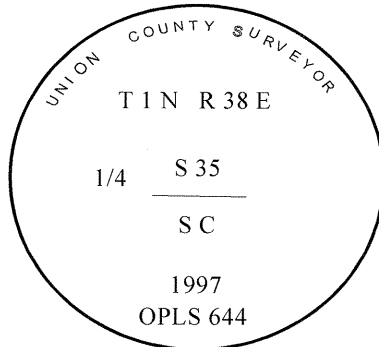

Renewal Date: December 31, 2016

1 METER = 3.2808333333... US FEET = 39.37 INCHES

1 METER = 3.280839895 INT'L FEET OR 1 INCH = 2.54 CM

TO CALCULATE ELEVATION FACTOR ( IN THE NORTH AMERICAN CONTINENT)

DIVIDE 20,906,000 BY (20,906,000 + ELLIPSOID ELEV. IN FEET)