

CERTIFIED RECORD OF LAND CORNER MONUMENTATION

HISTORY OF ORIGINAL CORNER ESTABLISHMENT:

Corner originally established by Joseph G. Gray on a joint venture with O'Dell under GLO contract Number 120, dated May 27, 1867. Surveyor General record states:

Set post for quarter section corner from which:
 A pine 36 in. dia. bears S 15°W, 57 lks.
 A pine 12 in. dia. bears N 45°E, 128 lks.

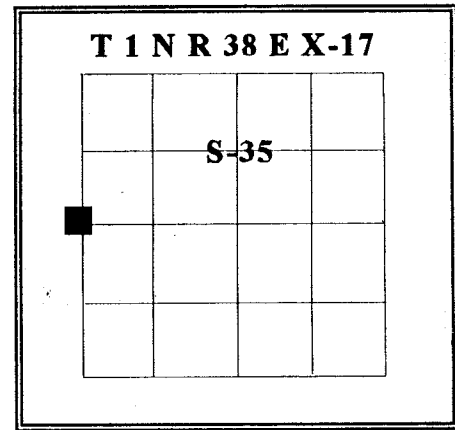

No record of subsequent monumentation found in the Union County Survey records.

DESCRIPTION OF CORNER EVIDENCE FOUND:

NONE.

The position is on the north edge of the county road right of way.

See Map of Survey Number 022-1997.

DESCRIPTION OF MONUMENT AND ACCESSORIES I ESTABLISHED TO PERPETUATE THE ORIGINAL LOCATION OF THIS CORNER:

At proportionate position I set a 2-1/2 inch by 30 inch aluminum pipe with aluminum cap marked as shown, 27 inches in the ground.

From which, New B O;

- A 5/8" by 30" rebar bears N 14°E, 11.00 feet, with 1-1/2" aluminum cap marked "UCS NE RP".
- A PK nail in the west side of a power pole bears S 44°E, 20.20 feet.
- A PK nail in the north side of a power pole bears S 20°W, 3.93 feet.
- A 5/8" by 30" rebar bears N 48°W, 3.07 feet, with 1-1/2" aluminum cap marked "UCS NW RP".

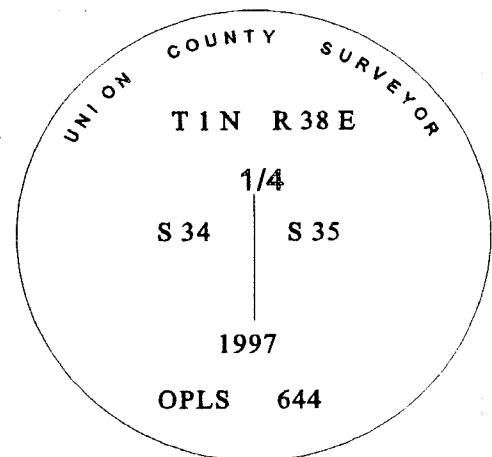

I hereby certify that the above corner point was perpetuated as hereon described on July 7, 1997.

Witnessed by: Jeff Madsen
 Greg Blackman Jr.



Renewal Date July 30, 1999

I used a steel tape and magnetic compass in the establishment of new accessories. I used 18° east declination and the measurement was taken to the center of the aluminum cap on the rebar.

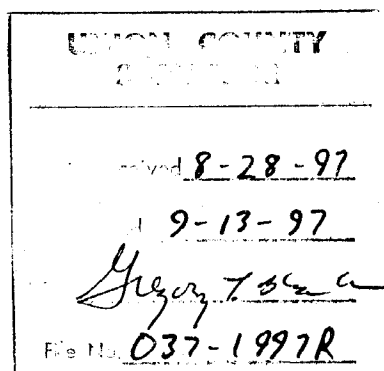

GEODETTIC CONTROL DATA

**OREGON STATE PLANE, NORTH ZONE (3601)
UNION COUNTY, OREGON**

STA. NAME: 9906

QUARTER CORNER: GEODETTIC COOR: NAD 83(91)
SEC 34 | 35

TWP.1 N. RGE.38 E LAT: 45°31'19.30294" N

UNION COUNTY, OREGON LONG: 118°02'08.89304" W

DATE TIED: JULY, 1999 SP. COOR: NAD 83(91)

SURVEYOR: WALTER L. CASWELL PLS 737 N: 686049.777 INT.FT

FIRM: EAGLE GPS SURVEY CORP E: 8833580.097 INT.FT.
6110 SW LOMBARD AVE.

BEAVERTON, OR. 97008-4736 THETA: 1°44'51.265"
(503) 643-1073

TYPE: GPS SCALE FACTOR: 0.999913569

ORDER: SECOND CLASS: 1 ELEV: 2841.61 U.S.FT.

ELEV. DATUM: NGVD 1929(1947)

DIRECTIONS "TO REACH":

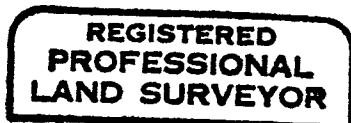

EXPIRES: 06/30/01

1 METER = 3.280833... U.S. FEET = 39.37 INCHES EXACTLY
1 METER = 3.280839895 INTL. FEET OR 1 INCH = 2.54CM. EXACTLY
TO CALCULATE ELEVATION FACTOR (IN THE NORTH AMERICAN CONTINENT)
DIVIDE 20,906,000 BY (20,906,000 + ELLIPSOID ELEV. IN FEET)

JOB 99-005
SHEET 27 OF 63