

CERTIFIED RECORD OF LAND CORNER MONUMENTATION

HISTORY OF ORIGINAL CORNER ESTABLISHMENT:

Corner originally established by Joseph G. Gray on a joint venture with O'Dell under GLO contract Number 120, dated May 27, 1867. Surveyor General record states:

I set post for section corner of secs 25, 26, 35 and 36 from which:

- A pine 20 in. Dia. Bears S 89°W, 130 lks.
- A pine 15 in. Dia. Bears N 17°W, 203 lks.
- A pine 15 in. Dia. Bears S 78°E, 320 lks.

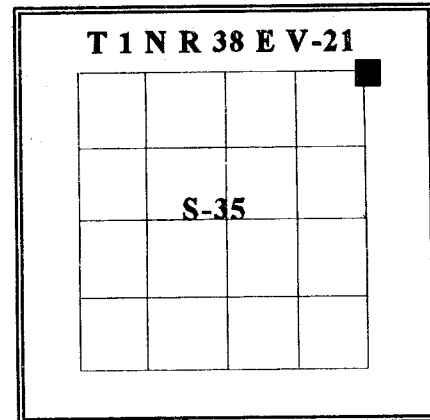

No record of subsequent monumentation was found in the Union County Survey records.
DESCRIPTION OF CORNER EVIDENCE FOUND:

NONE. The area is under cultivation.

See Map of Survey Number 022-1997.

DESCRIPTION OF MONUMENT AND ACCESSORIES I ESTABLISHED TO PERPETUATE THE ORIGINAL LOCATION OF THIS CORNER:

At the double proportionate position as determined by survey I set 2-1/2 inch by 30 inch aluminum pipe with aluminum cap marked as shown, 42 inches in the ground. Set in a field 12 inches below the surface, 50± feet south of an existing east - west fence.

From which, new B Os;

- A 5/8" by 30" rebar bears N 15°E, 55.00 feet, with 1-1/2" aluminum cap marked "UCS NE RP".
- A 5/8" by 30" rebar bears S 54°E, 8.94 feet, with 1-1/2" aluminum cap marked "UCS SE RP".
- A 5/8" by 30" rebar bears S 40°W, 6.35 feet, with 1-1/2" aluminum cap marked "UCS SW RP".
- A 5/8" by 30" rebar bears N 26°W, 55.45 feet, with 1-1/2" aluminum cap marked "UCS NW RP".

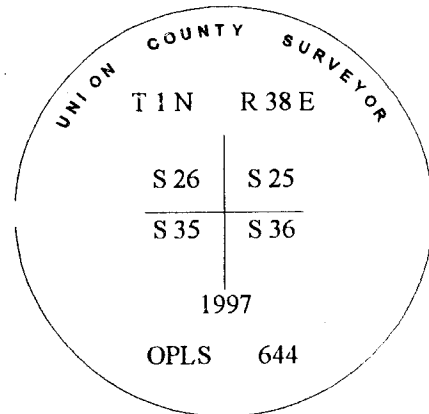

I hereby certify that the above corner point was perpetuated as hereon described on July 7, 1997.

Witnessed by: Greg Blackman Jr.
 Jeff Madsen

I used a steel tape and magnetic compass in the establishment of new accessories. I used 18° east declination and the measurement was taken to the center of the aluminum cap on the rebar.



Renewal Date July 30, 1993

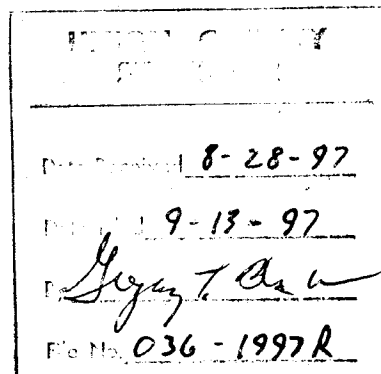

GEODETIC CONTROL DATA

**OREGON STATE PLANE, NORTH ZONE (3601)
UNION COUNTY, OREGON**

STA. NAME: 9902

SECTION CORNER:

SEC. 26 | 25

SEC. 35 | 36 TWP.1 N. RGE.38 E

UNION COUNTY, OREGON

DATE TIED: JULY, 1999

GEODETIC COOR: NAD 83(91)

LAT: 45:31'45.25101" N

LONG: 118:00'54.86122" W

SURVEYOR: WALTER L. CASWELL
PLS 737

SP. COOR: NAD 83(91)

N: 688837.961 INT.FT

FIRM: EAGLE GPS SURVEY CORP
6110 SW LOMBARD AVE.
BEAVERTON, OR. 97008-4736
(503) 643-1073

E: 8838767.505 INT.FT.

THETA: 1:45'43.767"

TYPE: GPS

SCALE FACTOR: 0.999914352

ORDER: SECOND CLASS: 1

ELEV: 2988.21 U.S.FT.

ELEV. DATUM: NGVD 1929(1947)

DIRECTIONS "TO REACH":



Albert Hertel 10-14-99
OREGON
JULY 18, 1960
ALBERT HERTEL
1896

EXPIRES: 06/30/01

1 METER = 3.280833... U.S. FEET = 39.37 INCHES EXACTLY
1 METER = 3.280839895 INTL. FEET OR 1 INCH = 2.54CM. EXACTLY
TO CALCULATE ELEVATION FACTOR (IN THE NORTH AMERICAN CONTINENT)
DIVIDE 20,906,000 BY (20,906,000 + ELLIPSOID ELEV. IN FEET)

JOB 99-005
SHEET 22 OF 63