

CERTIFIED RECORD OF LAND CORNER MONUMENTATION

HISTORY OF ORIGINAL CORNER ESTABLISHED:

Corner not originally established.

T 1 N R 38 E S-11

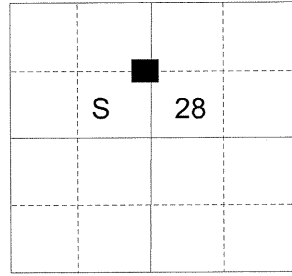

DESCRIPTION OF CORNER EVIDENCE FOUND:

None

SEE SURVEY NUMBER 031-2014

DESCRIPTION OF MONUMENT AND ACCESSORIES I ESTABLISHED TO PERPETUATE THE ORIGINAL LOCATION OF THIS CORNER:

At a position determined by survey, I set a 5/8" x 30" iron pin with a 2 1/2" aluminum cap marked as shown 28" in the ground. From which:

- A 6" Ponderosa Pine bears S 52° W, a distance of 40.65 feet, marked CN 1/16 S28 BT.
- A 6" Ponderosa Pine bears N 59° W, a distance of 37.80 feet, marked CN 1/16 S28 BT.

Set a steel fencepost +/- 0.5 foot South of corner monument.

I hereby certify that the corner was monumented on October 28, 2014.

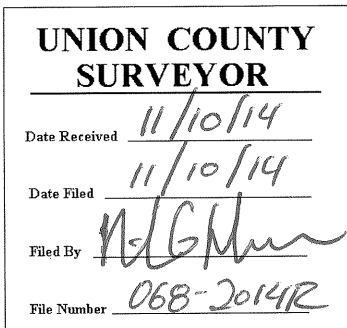
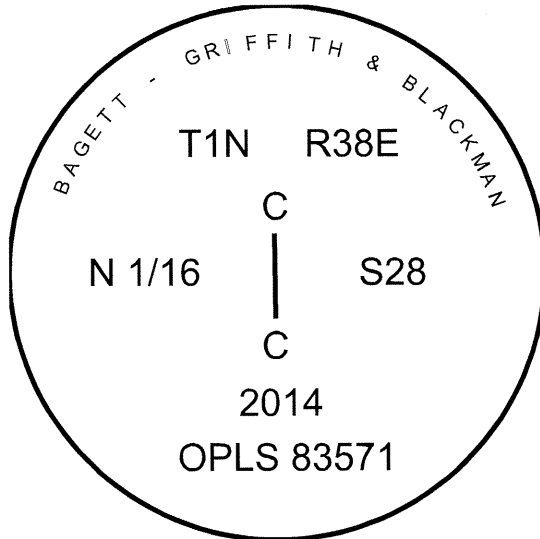

I used a steel tape and magnetic compass in the establishment of the new accessory. I used 16° East declination, the distances are to a 60d spike driven into the right side of the root crown of the new bearing tree. A brass washer marked OPLS 83571 is attached to the BT blaze of the new bearing trees.