

CERTIFIED RECORD OF LAND CORNER MONUMENTATION

HISTORY OF ORIGINAL CORNER ESTABLISHED:

Corner originally established by Joseph Gray under GLO Contract No. 120, dated May 27, 1867. Surveyor General field notes states:

Set 1/4 section cor. post. Deposited marked stone and raised stone mound as per instructions.

T 1 N R 38 E N-23

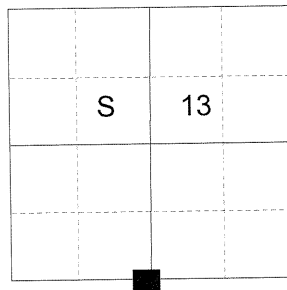

DESCRIPTION OF CORNER EVIDENCE FOUND:

Found a collar of stone, 2 1/2' diameter, firmly set. Though a rocky area falls 200 feet to the West, the area where this collar was found was otherwise devoid of stone. Position is harmonious with a proportionate position.

SEE SURVEY NUMBER 008-2019

DESCRIPTION OF MONUMENT AND ACCESSORIES I ESTABLISHED TO MONUMENT THE ORIGINAL LOCATION OF THIS CORNER:

At the collar of stone position, I set a 2 1/2" x 30" aluminum pipe, 30" in the ground, with 3" aluminum cap marked as shown below, in a collar of stone 2' diam., from which:

NEW BEARING TREES:

- A 12" Ponderosa Pine bears North 60° East, a distance of 26.35 feet, marked 1/4 S13 BT.
- A 12" Ponderosa Pine bears South 2° West, a distance of 33.55 feet, marked 1/4 S24 BT.
- A 6" Ponderosa Pine bears South 82° West, a distance of 48.50 feet, marked 1/4 S24 BT.
- A 7" Ponderosa Pine bears North 37° West, a distance of 21.00 feet, marked 1/4 S13 BT.

Set steel fence post approx. 1' North.

A fence corner from which fences bears North and West falls Northwest approx. 100 feet. Corner falls 30 feet East of a North/South running dirt road.

I hereby certify that the corner was monumented on May 3, 2019.
Witness: Kyle A. Tucker.



Renewal Date: June 30, 2019

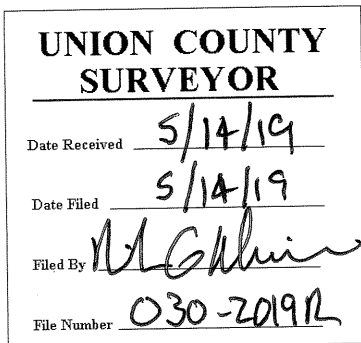
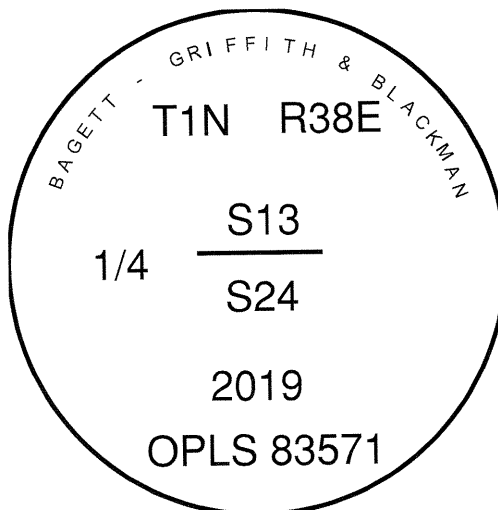

I used a steel tape and magnetic compass in the establishment of the new accessories. I used 13° East declination, the distances are to a 60d spike driven into the right side of the root crown of the bearing trees. The bearings are to a brass washer marked OPLS 83571 attached to the BT blaze of the new bearing trees.