

CERTIFIED RECORD OF LAND CORNER MONUMENTATION

HISTORY OF ORIGINAL CORNER ESTABLISHED:

Not previously Established.

T 1 N R 38 E D-24

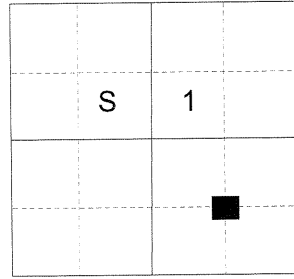

DESCRIPTION OF CORNER EVIDENCE FOUND:

None.

See Survey 015-2020

DESCRIPTION OF MONUMENT AND ACCESSORIES I ESTABLISHED TO MONUMENT THE LOCATION OF THIS CORNER:

At position determined by survey I set a 5/8" x 15" iron pin, 13" drilled into rock, with 2 1/2" aluminum cap marked as shown below, from which:

NEW BEARING OBJECTS:

A 2'x2'x2' rock outcrop bears South 82°44' East a dist. of 2.12 ft., marked X B0.
A 5/8"x30" iron pin bears North 42°36' West a dist. of 17.16 ft., with 1 1/2" aluminum cap marked BGB Survey Marker.

Set fence post approx. 5 ft. South

I hereby certify that the corner was monumented on May 8, 2020.
Witness: Kyle A. Tucker



Renewal Date: June 30, 2021

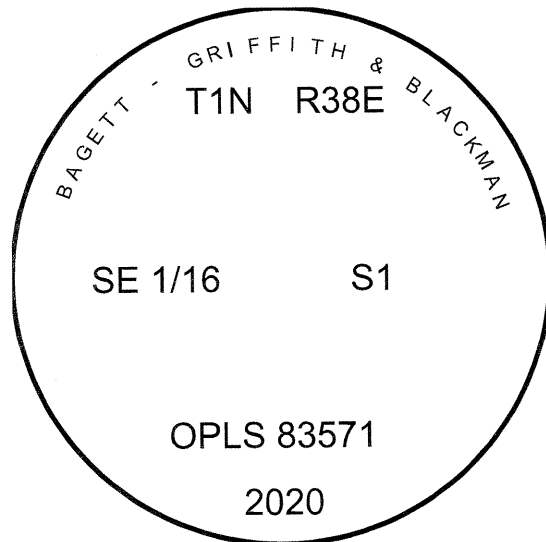
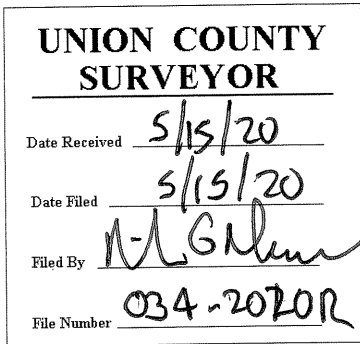

I used a Leica GS18 in the establishment of the new accessories. Basis of Bearing is as per Survey 015-2020. The distances and bearings are to the center of the X or to the center of the aluminum cap.