



# Minor Partition Number 20090022T

Microfilm Number 20094600T  
Plat Cabinet Number D088-D089

Situated in East half of the Northwest quarter and the West half of the Northeast quarter of Section 9 Township 3 South, Range 38 East of the Willamette Meridian, Union County, Oregon

## SURVEYOR'S CERTIFICATE

I, Rick G. Robinson, Registered Professional Land Surveyor, hereby certify that I have surveyed and platted Parcels 1 and 2 and platted UNSURVEYED Parcel 3 of this partition, being situated in the East half of the Northwest quarter and the West half of the Northeast quarter of Section 9 Township 3 South, Range 38 East of the Willamette Meridian, City of La Grande, Oregon, the exterior of which being more particularly described as follows;

Beginning at a point on the East right of way line of 25th Street, said point being the Southwest corner of Minam View Addition,

Thence: South 89°49'39" East, along the South line of said Minam View Addition, a distance of 445.04 feet, to the Southeast corner of said addition,

Thence: North 0°06'40" East, along the East line of said Minam View Addition and Northerly prolongation thereof, a distance of 633.92 feet, more or less to the South line of land conveyed to State of Oregon, by and through its State Highway Commission by deed recorded in Book 158, Page 505, records of the Union County Clerk, said line being the Southwesterly right of way line of Highway 84,

Thence: South 35°40'35" East, along said Southwesterly line, a distance of 2533.65 feet, more or less, to the East line of the West half of the Northeast quarter of said Section 9,

Thence: South 0°06'12" West, along said East line, a distance of 286.39 feet, more or less, to the Southeast corner of land conveyed to Frederick H. Hill et al by deed recorded in Book 148, Page 213, as filed in the Office of the Union County Clerk,

Thence: North 89°53'33" West, a distance of 1042.65 feet, more or less, to the Southeast corner of land conveyed to Alonzo C. Gillham and wife by deed recorded in Book 144, Page 547, as filed in the Office of the Union County Clerk,

Thence: North 0°06'27" East, along the exterior of said Gillham tract, a distance of 567.00 feet, more or less,

Thence: North 89°53'33" West, along the exterior of said Gillham tract, a distance of 806.66 feet, more or less,

Thence: North 0°06'27" East, along the exterior of said Gillham tract, a distance of 567.00 feet, more or less, to the South line of tract of land conveyed to Larry W. and Karen T. Purdy by deed recorded as Microfilm Document Number 148657, as filed in the Union County Clerk,

Thence: South 89°53'33" East, along said South line, a distance of 17.64 feet, more or less, to the Southeast corner of said Purdy tract,

Thence: North 0°05'20" East, along the East line of said Purdy tract and the East line of tract conveyed to Reed R. Weber by deed recorded as Microfilm Document Number 20084270, as filed in the office of the Union County Clerk, a distance of 150.00 feet, more or less, to the Northeast corner of said Weber tract,

Thence: North 89°54'40" West, along the North line of said Weber tract, a distance of 95.23 feet, more or less to the East right of way line of 25th Street,

Thence: North 0°08'57" East, along said East line, a distance of 213.20 feet, more or less, to the South line of tract conveyed to Carl C. Peterson et al by deed recorded as Microfilm Document Number 113386, as filed in the office of the Union County Clerk,

Thence: South 89°52'09" East, along the South line of said Peterson tract, a distance of 87.13 feet,

Thence: North 0°07'51" East, along the East line of said Peterson tract, a distance of 77.98 feet,

Thence: North 89°52'09" West, along the North line of said Peterson tract, a distance of 87.10 feet, to the East right of way line of 25th Street,

Thence: North 0°08'57" East, along said East line, a distance of 130.54 feet, to the Point of Beginning of this description.

Containing 49± acres, more or less.

I further certify that I made this plat by order of and under the direction of owners thereof, and that Parcel 1 and 2 are marked with monuments as indicated on the annexed plat in accordance with O.R.S. 92.050 and 92.060.

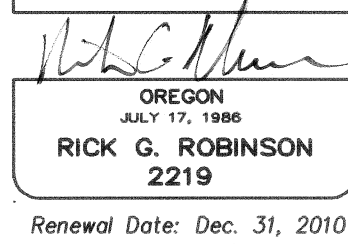
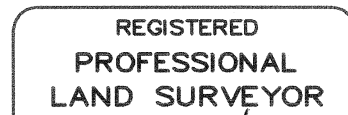

Rick G. Robinson, OPLS 2219  
Bagett, Griffith and Blackman  
La Grande OR 97850

## DECLARATION

Know all People by these presents that TESIA MARIE ESTATES, LLC., an Oregon Limited Liability Company, duly organized and existing under and by virtue of the laws of the State of Oregon, pursuant to the provisions of the Oregon Uniform Limited Partnership Act ( ORS Chapter 70 ), is the owner of the land within this partition, being more particularly described in the accompanying Surveyor's Certificate, and has caused Parcels 1 and 2 to be surveyed and Parcel 3 to be platted as shown on the annexed plat, in accordance with the provisions of ORS Chapter 92. In witness where of, TESIA MARIE ESTATES, LLC., pursuant to its' operating agreement, duly and legally adopted, has caused these presents to be signed by ALAN FISHBACK.

Alan Fishback, MEMBER  
ALAN FISHBACK  
TESIA MARIE ESTATES, LLC

## ACKNOWLEDGMENTS

State of OREGON  
County of UNION SS

Know all people by these presents, on this 21 day of DECEMBER, 2009, before me a Notary Public in and for said State and County, personally appeared ALAN FISHBACK who are known to me to be the identical person named in the foregoing instrument, and who being duly sworn, did say that he executed the same freely and voluntarily.

Jeffrey Scott Hsu  
Notary Public for  
the State of OREGON

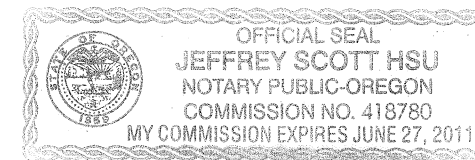

Notarial seal

## SURVEYOR'S EXACT COPY STATEMENT

I, Rick G. Robinson, registered Oregon Surveyor No. 2219, do hereby certify that I am the Surveyor who prepared the Partition Plat No. 20090022T and that the annexed tracing is an exact copy of said Partition Plat as the same is on file in UNION COUNTY Cabinet Number D088-D089 of the Plat Records of UNION COUNTY, and said exact copy is submitted as per O.R.S. 92.120.

Rick G. Robinson  
Rick G. Robinson, OPLS 2219

## APPROVALS

### City of La Grande Planner

Approved this 21<sup>st</sup> day of December, 2009.

Michael J. Bognist  
Michael J. Bognist  
City Planner

### City of La Grande Surveyor

Approved this 21<sup>st</sup> day of December, 2009.

Norman J. Paulus  
Norman J. Paulus  
City of La Grande Surveyor

### Union County Assessor / Tax Collector

I hereby certify that pursuant to O.R.S. 92.095, all ad valorem taxes and all special assessments, fees and other charges required by law to be placed upon the 2009-2010 tax roll which became a lien on the land within this partition, or will become a lien during the tax year but not certified to the tax collector for collection have been paid.

by Ellen Wilhelm, Chief Deputy Date: 12/22/09  
for Linda L. Hill, Union County Assessor/Tax Collector

## FILING STATEMENT

### Union County Clerk

State of Oregon SS  
County of Union

I do hereby certify that the attached partition plat was received for record on the 22<sup>nd</sup> day of DECEMBER, 2009, at 2:30 o'clock P.M., and recorded in Plat Cabinet No. D088-D089 Union County records. Microfilm Number 20094600T

Union County Clerk by Willetta Kenworthy, Deputy