

Minor Partition Number 2002-0019

Situated in the North half of Block 15,
Swackhamer's Addition to North Union,
Union County, Oregon

BASIS OF BEARING

Solar observation taken at the Southwest corner of Section 18, Township 4 South, Range 40 East of the Willamette Meridian.

SCALE: 1"=50'

REFERENCE MATERIAL

Plat of Swackhamer's Addition to North Union
Survey Number 72-77
Survey Number 22-83
Survey Number 054-1998
Minor Partition Plat Number 1992-09

DEED REFERENCES

Microfilm Number 1474934
Partition Plat report Number 41656
prepared by Abstract and Title Company

LEGEND

- Found 5/8" iron pin with plastic cap marked BGA SURVEY MARKER set by survey no. 22-83
- ▲ Position of 5/8" iron pin set by survey no. 22-83 (Destroyed by reconstruction of Main Street)
- Position of 5/8" iron pin set by survey no. 72-77 (Destroyed by reconstruction of Main Street)
- Found 5/8"x30" iron pin with plastic cap marked "BGB SURVEY MARKER" set by Minor Partition Plat Number 1992-09
- Set 5/8"x30" iron pin with plastic cap marked "BGB SURVEY MARKER"
- () Record distance of the original plat of Swackhamer's Addition.
- [] Record information of survey number 054-1998
- Centerline
- Existing fence line
- Easement line

NARRATIVE

This partition was done at the request of Gary Haefer, on behalf of the owner of the land within this partition. The location of this partition is based on Union County survey number 22-83, which located Swackhamer's Addition in its entirety. Minor Partition Plat Number 1992-09 then located the South half of Block 15 on that basis. I recovered the monuments from that survey and partition as shown. I place the North half of Block 15 from that information. The exterior of the partition is described as the North half of Block 15 by deed. I place the dividing line between the two parcels at the direction of Mr. Haefer. I place the triangular portion granted to ODOT on the West side of the block by rotating the positions given by state plane coordinate on survey number 054-1998 from the intersections of Main and Grape and Main and Delta. These are the two intersections shown on the 1998 survey that directly relate to survey number 22-83. I then place the centerline of the highway alignment (not coincidental to the platted right of way) at the record position of survey number 054-1998 rotated to this basis of bearing. I find the existing fence line to be away from the true deed line as shown. I also find a barn to encroach at the Northeast corner of this partition. I find no other unusual conditions on this partition.

REGISTERED
PROFESSIONAL
LAND SURVEYOR

Rick G. Robinson

OREGON
JULY 17, 1998
RICK G. ROBINSON
2219

Renewal Date: Dec. 31, 2002

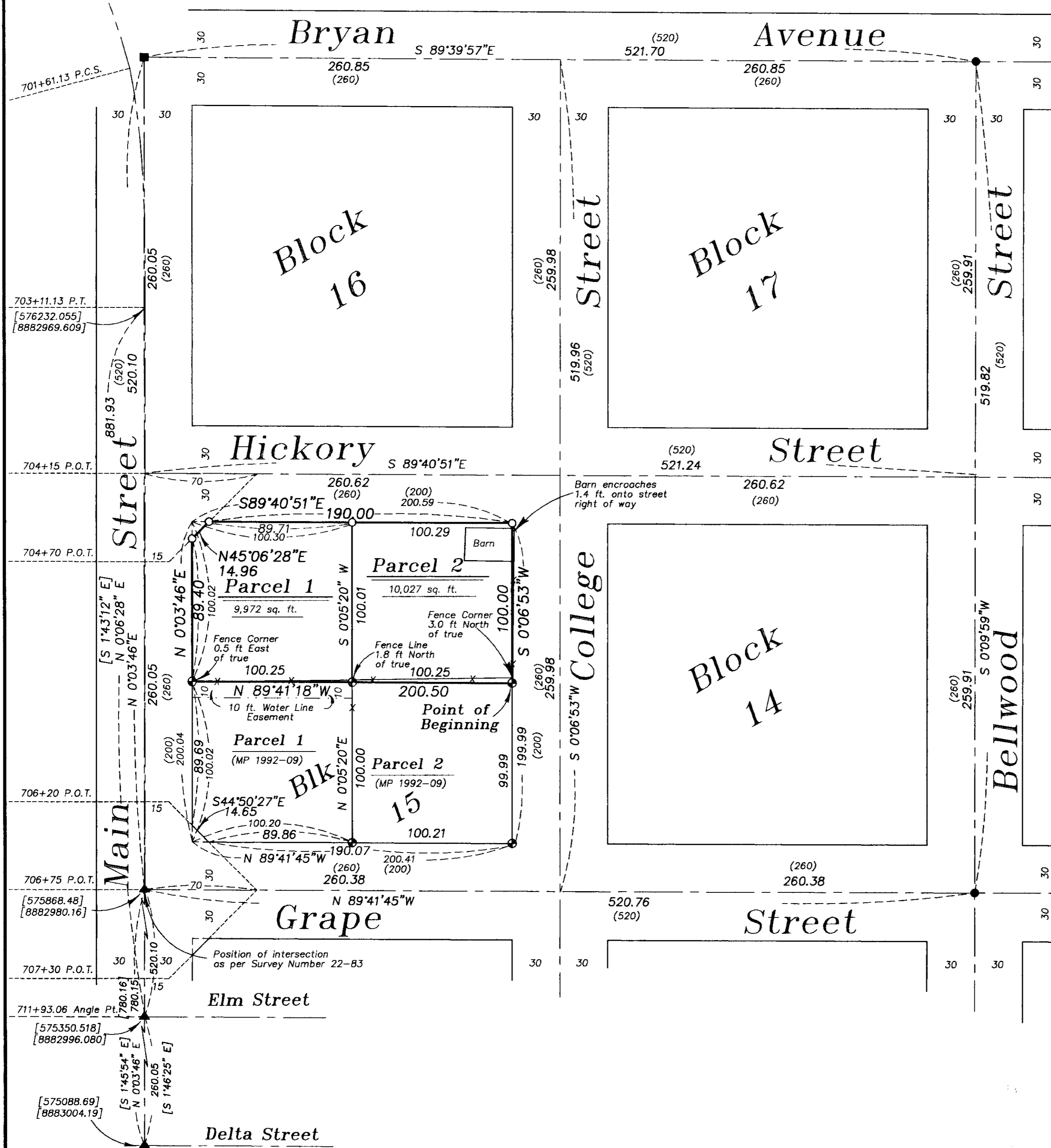

Minor Partition Number 2002-0019

Microfilm No. 20026513
Plat Cabinet No. C675-676

Situated in the North half of Block 15,
Swackhamer's Addition to North Union,
Union County, Oregon

SURVEYOR'S CERTIFICATE

I, Rick G. Robinson, Registered Professional Land Surveyor, hereby certify that I have surveyed and platted the land within this partition, said land being situated in the North half of Block 15 of Swackhamer's Addition to North Union, Union County, Oregon,

Beginning at the Northeast corner of Parcel 2 of Minor Partition Plat Number 1992-09, said point being the Southeast corner of the North half of said Block 15,

Thence; North 89°41'18" West, along the South line of the North half of said Block 15, said line also being the North line of Minor Partition Plat Number 1992-09, a distance of 200.50 feet, to the West line of said Block 15, said point being the Northwest corner of Parcel 1 of Minor Partition Plat Number 1992-09,

Thence; North 0°03'46" East, along the West line of said Block 15, a distance of 89.40 feet, to the Southerly corner of that tract of land granted to the State of Oregon, by and through its department of transportation, Highway Division, by deed microfilm number 147493 of the Union County Deed records,

Thence; North 45°06'28" East, along the Southeasterly line of said State of Oregon tract, a distance of 14.96 feet, to the North line of said Block 15,

Thence; South 89°40'51" East, along said North line, a distance of 190.00 feet, to the Northeast corner of said Block 15,

Thence; South 0°06'53" West, along the East line of said Block 15, a distance of 100.00 feet, to the Point of Beginning of this description.

Said tract containing 19,999 Square Feet (0.46 Acres)

I further certify that I made this survey and plat by order of and under the direction of the owner thereof, and that all parcel corners and boundary corners are marked with monuments as indicated on the annexed plat in accordance with O.R.S. 92.050 and 92.060.

Rick G. Robinson
Rick G. Robinson, OPLS 2219
Baggett, Griffith and Blackman, Inc.
2006 Adams Avenue
LaGrande, OR 97850

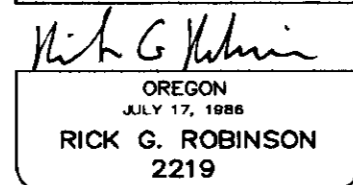
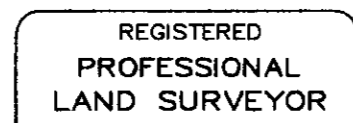

Renewal Date: Dec. 31, 2002

DECLARATION

Know all people by these presents that RITA MAE SARMAN is the sole owner of the land within this partition, said land being more particularly described in the accompanying Surveyor's Certificate, and have caused the same to be surveyed and platted as shown on the annexed plat, in accordance with the provisions of O.R.S. Chapter 92.

Rita Mae Sarman
RITA MAE SARMAN

ACKNOWLEDGMENTS

State of Oregon^{SS}
County of Union

Know all people by these presents, on this 4 day of NOVEMBER, 2002, before me a Notary Public in and for said State and County, personally appeared RITA MAE SARMAN, who is known to me to be the identical person named in the foregoing instrument, and who being duly sworn did say that she executed the same freely and voluntarily.

Dennis L. Watterson
Notary Public for
the State of Oregon

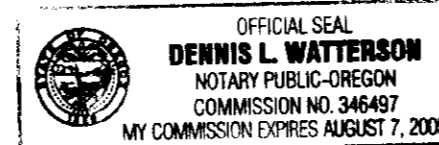

Notarial seal

APPROVALS

Union County Assessor / Tax Collector

I hereby certify that pursuant to O.R.S. 92.095, all ad valorem taxes and all special assessments, fees and other charges required by law to be placed upon the 2002-2003 tax roll which became a lien on the land within this partition, or will become a lien during the tax year but not certified to the tax collector for collection have been paid.

by Patty Gooderham Date: 11/18/02
Patty Gooderham, Union County Assessor/Tax Collector

City of Union

Approved this 4th day of November, 2002.

Bill Seabres
Bill Seabres
City Administrator

Union County Surveyor

Approved this 31st day of OCTOBER, 2002.

by Wallowa County Surveyor Jack W. Burris
Jack W. Burris

FILING STATEMENT

Union County Clerk

State of Oregon^{SS}
County of Union

I do hereby certify that the attached partition plat was received for record on the 18th day of Nov, 2002, at 2:04 o'clock P.M., and recorded in Plat Cabinet No. C675-676 Union County records. Microfilm Number 20026513

R. Nellie Bogue Hibbert
Union County Clerk
by R. Nellie Bogue Hibbert