

Minor Partition Number 1999-26

Microfilm Number 996152
Plat Cabinet Number B-551

A Partition of Parcel 3 of Minor Partition Number 1998-29
Situating in the Northwest quarter of the Northwest quarter of Section 5,
Township 3 South, Range 38 East of the Willamette Meridian.

SURVEYOR'S CERTIFICATE

I, Rick G. Robinson, Registered Professional Land Surveyor, hereby certify that I have surveyed and platted the land within this partition, being a partition of Parcel 3 of Minor Partition Number 1998-29, situated in the Northwest quarter of the Northwest quarter of Section 5, Township 3 South, Range 38 East of the Willamette Meridian, the exterior of which being more particularly described as follows.

Commencing at the Southwest corner of Parcel 3 of Minor Partition Plat number 1998-29, said point being on the East line of Helsom's Addition to LaGrande,

- Thence; North 0°19'26" East, along said East line, a distance of 232.01 feet, to the North right of way line of Benton Avenue,
- Thence; North 89°53'57" East, along said North line, a distance of 70.00 feet,
- Thence; North 0°19'26" East, a distance of 110.69 feet, to the North line of said Section 5,
- Thence; North 89°36'33" East, along said North line, a distance of 110.52 feet, to the West right of way line of Birch Street,
- Thence; South 0°19'26" West, along said West line, and it's Southerly prolongation, a distance of 171.24 feet, to the South right of way line of Benton Avenue,
- Thence; North 89°53'57" East, along said South line, a distance of 144.80 feet, to the Northeast corner of Parcel 3 of said Minor Partition Number 1998-29,
- Thence; South 0°17'40" West, along the East line of Parcel 3 of said partition plat, a distance of 174.50 feet, to the Southeast corner of said Parcel 3,
- Thence; North 89°39'41" West, along the South line of said Parcel 3, a distance of 325.38 feet, to the Point of Beginning of this description.

EXCEPTING THEREFROM the 60 ft. Strip of land conveyed to the City of LaGrande for street rights of way by dedication deed, recorded December 18, 1995, as Microfilm Document number 162425, in the deed records of Union County, Oregon.

Said tract containing 1.82 Acres (79,461 square feet) including right of way
Said tract containing 1.57 Acres (68,630 square feet) excluding right of way

I further certify that I made this survey and plat by order of and under the direction of the owners thereof, and that all parcel corners and boundary corners are marked with monuments as indicated on the annexed plat in accordance with O.R.S. 92.050 and 92.060.

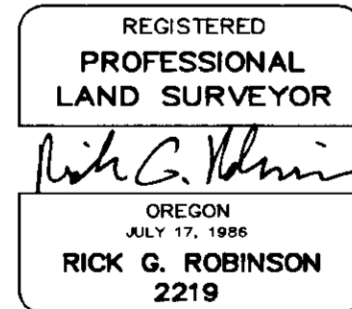

Rick G. Robinson
Rick G. Robinson, OPLS 2219
Baggett, Griffith and Blackman
2006 Adams Avenue
LaGrande, OR 97850

DECLARATION

Know all people by these presents that TIMOTHY W. SUDBRUCK and TINA M. SUDBRUCK are the owners, and WAYNE R. SIMONIS, as trustee for PATRICIA A. SIMONIS, is a lesin holder on the land, within this partition, more particularly described in the accompanying Surveyor's Certificate, and have caused the same to be surveyed and platted as shown on the annexed plat, in accordance with the provisions of O.R.S. Chapter 92.

Timothy W. Sudbruck Tina M. Sudbruck
Timothy W. Sudbruck Tina M. Sudbruck

Wayne R. Simonis, Trustee
Wayne R. Simonis, Trustee for Patricia A. Simonis

ACKNOWLEDGMENTS

State of Oregon
SS
County of Union

Know all people by these presents, on this 11th day of June, 1999, before me a Notary Public in and for said County and State, personally appeared Timothy W. Sudbruck and Tina M. Sudbruck, who stated that they are the identical persons named in the foregoing instrument, and that said instrument was executed freely and voluntarily.

Lonnie Lester
Notary Public for
the State of Oregon



Notarial seal

State of Oregon
SS
County of Union

Know all people by these presents, on this 11th day of June, 1999, before me a Notary Public in and for said County and State, personally appeared Wayne R. Simonis, Trustee for Patricia A. Simonis, who stated that he is the identical person named in the foregoing instrument, and that said instrument was executed freely and voluntarily.

Lonnie Lester
Notary Public for
the State of Oregon



Notarial seal

APPROVALS

City of LaGrande City Surveyor

Examined and recommended for approval as per O.R.S. Chapter 92 this 14th day of June, 1999.

by Norman J. Paulhus, Jr.
Norman J. Paulhus, Jr.
City Surveyor

City of LaGrande Community Development Director/Planner

Approved this 4th day of October, 1999.

David E. Miller, R. Wes Here, II
David E. Miller, R. Wes Here, II
Community Development Director/Planner

Union County Assessor / Tax Collector

I hereby certify that pursuant to O.R.S. 92.095, all ad valorem taxes and all special assessments, fees and other charges required by law to be placed upon the ~~1998-1999~~ ¹⁹⁹⁹⁻²⁰⁰⁰ tax roll which became a lien on the land within this partition, or will become a lien during the tax year but not certified to the tax collector for collection have been paid.

by Patty Gooderham Date: 11/23/99
Patty Gooderham, Union County Assessor

FILING STATEMENT

Union County Clerk

State of Oregon
SS
County of Union

I do hereby certify that the attached partition plat was received for record on the 24 day of Nov, 1999, at 9:45 o'clock A.M., and recorded in Plat Cabinet No. B-551 Union County records. Microfilm Number 996152

Union County Clerk
by Lonnie Lester