

**MINOR LAND PARTITION PLAT NO. 1995-24**

Microfilm # 161791  
 Plat Cab. # B-412

FOUND PROPERLY MARKED BRASS  
 CAP IN MONUMENT BOX  
 WEST 1/4 CORNER SEC. 24  
 PLS 991

BRASS CAPPED IRON PIPE  
 IN CONCRETE MARKED  
 NW CORNER LG/UC AIRPORT  
 SUBDIVISION  
 PLS 1099, 1990

NOTE: PARCEL 1 OF THIS MINOR LAND PARTITION IS A PORTION  
 OF SECTION 24, T3S, R38E, WHICH IS OWNED BY UNION COUNTY. THE PORTION  
 OF SECTION 24 NOT INCLUDED IN PARCEL 1 OF THIS MINOR LAND PARTITION  
 WAS NOT SURVEYED AS PART OF THIS PARTITIONING, AND IS NOT DEPICTED  
 OR DESIGNATED AS A PARCEL OF THIS MINOR LAND PARTITIONING.

**BASIS OF BEARINGS**

BEARINGS ARE BASED UPON THE LINE BETWEEN THE  
 SW COR OF SEC. 24 AND THE SW COR  
 OF THE LA GRANDE/UNION CTY AIRPORT SUBDIVISION  
 BEING N86°49'48"E BETWEEN THE MONUMENTS  
 SHOWN HEREON PER 23 OF SURVEYS, PAGE 90

LINE	BEARING	DISTANCE
L1	N00°02'20"W	30.00'
L2	N89°03'25"E	30.00'
L3	S00°02'20"E	30.00'
L4	S89°03'25"W	30.00'
L5	N00°09'08"W	30.00'
L6	S89°03'25"W	30.00'
L7	N00°02'20"W	26.00'
L8	N44°31'11"E	57.01'

**LEGEND**

- FOUND 2-1/2" BRASS CAP MONUMENT AS PER UNION COUNTY MONUMENTATION RECORDS
- FOUND MONUMENT PER COUNTY SURVEY #23-90
- SET 5/8" x 30" IRON ROD (CONCRETE REINFORCING ROD) WITH YELLOW PLASTIC CAP ATTACHED MARKED "AP&A"
- ( ) RECORD DIMENSION PER CITED RECORD
- △ FOUND 2-1/2" BRASS CAP MONUMENT AS PER UNION COUNTY MONUMENTATION RECORDS

**REFERENCE MATERIAL**

UNION COUNTY RECORDS

SURVEYS: 23-90

PLATS: LAGRANDE/UNION COUNTY AIRPORT COMMERCIAL/  
 INDUSTRIAL PARK SUBDIVISION-MICROFILM NO. 136969

PARTITION PLAT REPORT ORDER #35268  
 BY ABSTRACT & TITLE COMPANY.

Pierce Road (80' R.O.W.) County Road

LAGRANDE/UNION COUNTY AIRPORT COMMERCIAL/INDUSTRIAL PARK SUBDIVISION

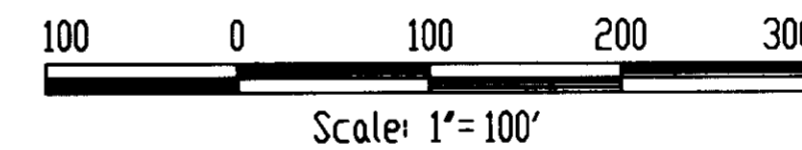

WATER RIGHTS MAY BE APPURTENANT  
 TO THIS MINOR PARTITION UNDER  
 THE FOLLOWING CERTIFICATE:  
 CERTIFICATE NO. 3323

SE COR SEC 24  
 NOT VISITED THIS SURVEY

FOUND PROPERLY MARKED BRASS  
 CAP IN MONUMENT BOX  
 SEE SURVEY NARRATIVE

Airport Lane (80' R.O.W.) County Road

NOTE: REFER TO THE PLAT OF THE LAGRANDE/UNION COUNTY  
 AIRPORT COMMERCIAL/INDUSTRIAL PARK SUBDIVISION FOR TIES TO  
 NEARBY GEODETIC SURVEY MONUMENTS.

REGISTERED  
 PROFESSIONAL  
 LAND SURVEYOR

HARMON E. MCLENDON  
 2537

12/31/96

<b>MINOR LAND PARTITION</b>		
LOCATED IN SW 1/4 AND SE 1/4, SECTION 24, T.38., R.38E., W.M., UNION CO.		
UNION COUNTY		1108 "K" AVENUE LA GRANDE, OR 97850
SCALE: 1" = 100'		SHEET
DATE: APR, 1995		<b>1/2</b>
JOB NO. 688-61		

**SURVEYOR'S CERTIFICATE**

**MINOR LAND PARTITION**

PLAT NO. 1995-26  
 microfilm # 161791  
 Plat Cab. # B-412  
**DECLARATION**

I, HARMON E. MCLENDON, OREGON REGISTERED LAND SURVEYOR NO. 2537, DO HEREBY STATE THAT I HAVE PREPARED THIS MINOR LAND PARTITION IN ACCORDANCE WITH THE DESIRES OF THE PARTITIONER AND IN ACCORDANCE WITH OREGON REVISED STATUTES, CHAPTER 92, AND THAT THE FOLLOWING DESCRIPTION IS TRUE AND CORRECT:

A PARCEL OF LAND LOCATED IN THE SOUTHWEST ONE-QUARTER AND IN THE SOUTHEAST ONE-QUARTER OF SECTION 24, TOWNSHIP 3 SOUTH, RANGE 38 EAST, WILLAMETTE MERIDIAN, UNION COUNTY, OREGON, SAID PARCEL BEING MORE PARTICULARLY DESCRIBED AS FOLLOWS:

Commencing at the Southwest corner of said Section 24, a brass cap marked PLS 1099, 1990, found as described on the Union County Survey Number 23-90, Union County Records;  
 thence N44°31'11"E a distance of 57.01 feet to the intersection of the northerly right-of-way of Airport Lane and the easterly right-of-way of Pierce Road, a 5/8" rebar with yellow plastic cap marked "AP&A", the True Point of Beginning of the parcel being described;  
 thence N00°02'20"W along said easterly right-of-way of Pierce Road and parallel to the west line of said Section 24 a distance of 1027.33 feet to a 5/8" rebar with yellow plastic cap marked "AP&A";  
 thence leaving said right-of-way, N89°03'25"E, parallel with the south line of said Section 24, a distance of 295.83 feet to a 5/8" rebar with yellow plastic cap marked "AP&A";  
 thence 500°09'08"E, parallel with and 94 feet westerly of the centerline of the existing north-south taxiway, a distance of 1027.30 feet to an intersection with the northerly right-of-way of Airport Lane, a 5/8" rebar with yellow plastic cap marked "AP&A";  
 thence along said right-of-way and parallel with the south line of said Section 24, S89°03'25"W a distance of 297.86 feet to the Point of Beginning, containing 7.00 acres.

KNOW ALL PEOPLE BY THESE PRESENTS THAT WE, STEVE MCCLURE, CHAIRMAN, JOHN J. HOWARD, AND LORENCE D. SAVAGE, THE DULY ELECTED BOARD OF COMMISSIONERS OF UNION COUNTY, A POLITICAL SUBDIVISION OF THE STATE OF OREGON AND OWNER OF THE LAND DEPICTED AND DESCRIBED ON THE ANNEXED SURVEYOR'S CERTIFICATE, BEING DULY SWORN, DEPOSE AND SAY THAT, ON BEHALF OF UNION COUNTY, WE DID CAUSE SAID LAND TO BE SURVEYED AND PARTITIONED AS SHOWN.

Steve McClure STEVE MCCLURE, CHAIRMAN  
John J. Howard JOHN J. HOWARD, COMMISSIONER  
Lorence D. Savage LORENCE D. SAVAGE, COMMISSIONER

**ACKNOWLEDGEMENT**

STATE OF OREGON SS  
 COUNTY OF UNION

BE IT REMEMBERED THAT ON THIS 18th DAY OF October, 1995, PERSONALLY APPEARED BEFORE ME, A NOTARY PUBLIC IN AND FOR SAID STATE AND COUNTY, STEVE MCCLURE, JOHN J. HOWARD, AND LORENCE D. SAVAGE, WHO ARE KNOWN TO BE TO BE THE IDENTICAL PERSONS DESCRIBED IN AND WHO EXECUTED THE ABOVE INSTRUMENT AND WHO ACKNOWLEDGED THAT THEY EXECUTED THE SAME FREELY AND VOLUNTARILY AS THE OFFICIAL MEMBERS OF THE BOARD OF COMMISSIONERS OF UNION COUNTY, OREGON.

Shelley A. Burgess  
 NOTARY PUBLIC OF THE STATE OF OREGON

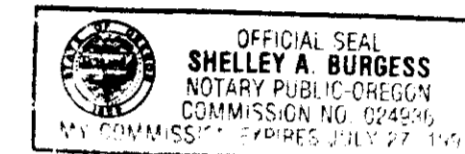

**APPROVALS**

APPROVED THIS 3rd DAY OF Oct, 1995  
Gregory T. Blackman  
 CHAIRPERSON  
 UNION COUNTY PLANNING COMMISSION

APPROVED THIS 27th DAY OF September, 1995  
Gregory T. Blackman  
 GREGORY T. BLACKMAN  
 UNION COUNTY SURVEYOR

I HEREBY CERTIFY THAT PURSUANT TO O.R.S. 92.095, ALL AD VALOREM TAXES AND ALL SPECIAL ASSESSMENTS, FEES AND OTHER CHARGES REQUIRED BY LAW TO BE PLACED UPON THE 1995-1996 TAX ROLL WHICH BECAME A LIEN DURING THE TAX YEAR BUT NOT CERTIFIED TO THE TAX COLLECTOR FOR COLLECTION HAVE BEEN PAID.

BY Donna Lewis, Chief Deputy DATE 10/4/95  
 PATTY GOODERHAM, UNION COUNTY ASSESSOR

I HEREBY CERTIFY THAT ALL AD VALOREM TAXES AND ALL SPECIAL ASSESSMENTS, FEES AND OTHER CHARGES REQUIRED BY LAW TO BE PLACED UPON THE TAX ROLL WHICH BECAME A LIEN ON THE LAND WITHIN THIS PARTITION AND THAT ARE NOW DUE AND PAYABLE HAVE BEEN PAID TO ME.

BY Peggy Sutton DATE 10/4/95  
 PEGGY SUTTON, UNION COUNTY TREASURER

**FILING STATEMENT**

STATE OF OREGON (SS)  
 COUNTY OF UNION

I DO HEREBY CERTIFY THAT THE ATTACHED PARTITION PLAT WAS PRESENTED FOR RECORDING ON THE 31 DAY OF October, 1995, AT 10:00 O'CLOCK A.M., AND RECORDED AS PARTITION PLAT NO. 1995-26 UNION COUNTY RECORDS.

BY Pat Quinn Bogue Hilbert  
 UNION COUNTY CLERK

9/22/95  
 DATE  
H. E. McLendon  
 HARMON E. MCLENDON, PLS 2537

**SURVEY NARRATIVE**

This survey was performed on behalf on Union County for the purpose of defining a 7.00 acre lease parcel to be partitioned from the Union County Airport.

The South and West lines of this parcel were established by the right-of-way lines of Airport Lane and Pierce Road as determined by the monuments shown hereon. Users of this map should be aware that a double set of corners exist at both the Southwest and Southeast corners of Section 24. In the interest of harmony with existing improvements this map did not accept the monuments as shown on County Survey No. 1-74 and uses instead those shown on County Survey No. 23-90.

The East line of this parcel was placed 94.0' westerly of the existing centerline of the north-south taxiway.

The North line of this parcel was made parallel to the South line of Section 24 as determined from the monuments shown and placed so as to contain an area of 7.00 acres.

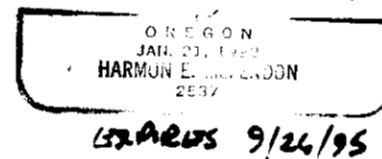
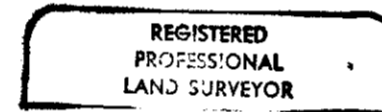

**MINOR LAND PARTITION**  
 LOCATED IN SW 1/4 AND SE 1/4, SECTION 24,  
 T.3S., R.38E., W.M., UNION CO.

FOR: UNION COUNTY 1105 "K" AVENUE LA GRANDE, OR 97850

SCALE: NO SCALE	 anderson & associates, inc. ENGINEERING - SURVEYING - MATERIALS TESTING LA GRANDE, OR. WALLA WALLA, WA. LEWISTON, ID.	SHEET
DATE: APR 1995		2/2
JOB NO. 689-30		