

19120003

TOWNSHIP 4 SOUTH RANGE 41 EAST W.M.

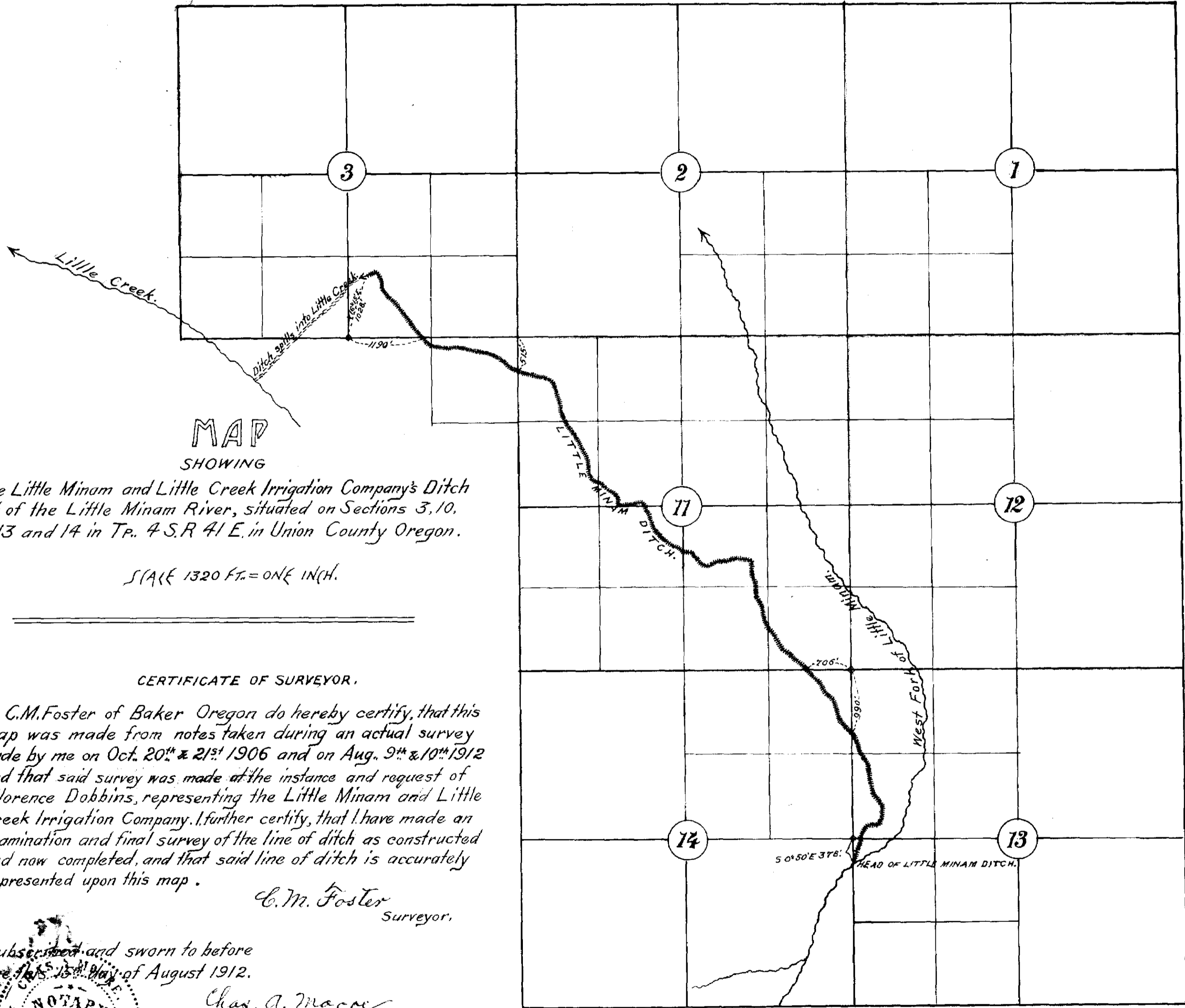

MAP  
SHOWING

The Little Minam and Little Creek Irrigation Company's Ditch  
out of the Little Minam River, situated on Sections 3, 10,  
11, 13 and 14 in T.P. 4 S.R. 41 E. in Union County Oregon.

SCALE 1320 FT. = ONE INCH.

CERTIFICATE OF SURVEYOR.

I, C.M. Foster of Baker Oregon do hereby certify, that this  
map was made from notes taken during an actual survey  
made by me on Oct. 20<sup>th</sup> & 21<sup>st</sup> 1906 and on Aug. 9<sup>th</sup> & 10<sup>th</sup> 1912  
and that said survey was made at the instance and request of  
Florence Dobbins, representing the Little Minam and Little  
Creek Irrigation Company. I further certify, that I have made an  
examination and final survey of the line of ditch as constructed  
and now completed, and that said line of ditch is accurately  
represented upon this map.

C. M. Foster  
Surveyor.

Subscribed and sworn to before  
me this 15<sup>th</sup> Day of August 1912.

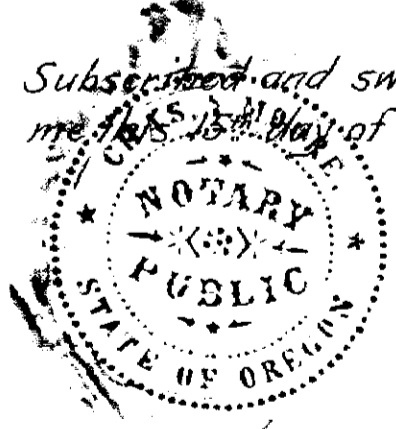

Chas. A. Macroe  
Notary Public for Oregon.