

BE IT REMEMBERED, that at a regular term of the Union County Board of Commissioners, for the County of Union, sitting for the transaction of County business, begun and held at the Joseph Building Annex in the City of La Grande, in said County and State, on Wednesday of said month and the time fixed by law for holding a regular term of said Court, when were present:

The Honorable	MARK DAVIDSON	Chairman
	STEVE MCCLURE	Commissioner
	WILLIAM ROSHOLT	Commissioner

WHEN, on Wednesday, the 15th day of May, 2013, among others the following proceedings were had to-wit:

IN THE MATTER OF)	COURT ORDER
VACATING A PORTION)	2013-25
OF AIRPORT LANE)	

WHEREAS, Union County submitted a petition to vacate the segment of Airport Lane described in the attached Exhibit A and shown in the attached map (Exhibit B);

WHEREAS, Doug Wright, Union County Public Works Director, submitted a letter dated February 28, 2013 stating that this segment of Airport Lane is no longer in use because of the Airport Runway Shift Project and should not be part of the Union County Road System;

WHEREAS, the Board of Commissioners advertised and held a public hearing on April 3, 2013 to accept testimony, deliberate and potentially make a decision.

NOW THEREFORE, BE IT ORDAINED BY THE UNION COUNTY BOARD OF COMMISSIONERS, STATE OF OREGON:

SECTION 1: ROAD VACATION

The road segment described in the attached Exhibit A and shown in the attached map (Exhibit B) is vacated to the adjacent properties per ORS 368.366 (1)(d).

PASSED AND ADOPTED this 15th day of May, 2013 by a vote of the following members of the Board of Commissioners voting therefore.

	_____
Mark Davidson, Chairman	
	_____
Steve McClure, Commissioner	
	_____
William Rosholt, Commissioner	

EXHIBIT A
LEGAL DESCRIPTION

VACATION-AIRPORT LANE

A parcel of land located in the Southeast one-quarter of Section 24 and in the Northeast one-quarter of Section 25, Township 3 South, Range 38 East, and in the Southwest one-quarter of Section 19 and in the Northwest one-quarter of Section 30, Township 3 South, Range 39 East, Willamette Meridian, Union County, Oregon, said parcel being that portion of those tracts of land described in Union County Book 103 of Deeds at Page 323, and Union County Book 104 of Deeds at Page 72 lying within the Object Free Area for Runway 12-30 of the La Grande/Union County Airport as depicted on Exhibit B, titled "Area of Roadway Vacation" said Exhibit B is attached hereto and made a part hereof.

Said parcel of land contains 2.05 acres, more or less.

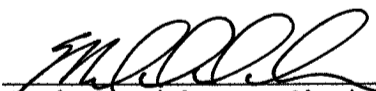
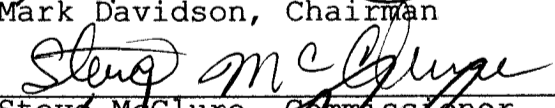
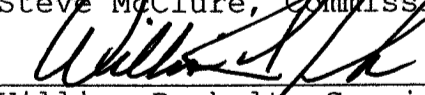
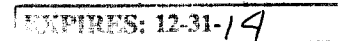
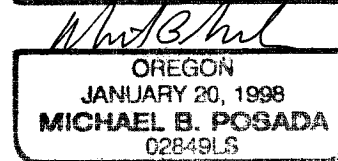
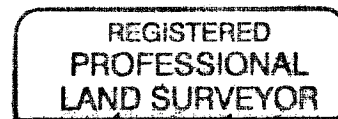

DATEO: 12-06-12

S:\Unionco\Airport\694-46_LGUC_AIRPORT\LN 2010\dwg\MOS-2011-GLL.dwg, 12/6/2012 9:56:19 AM, \\gprint64\Canon IR2270 UFR II Survey

100 0 100 200

SCALE: 1" = 100'

LEGEND

OFA LA GRANDE/UNION COUNTY AIRPORT
RUNWAY 12-30 OBJECT FREE AREA

BASIS OF BEARINGS

REFER TO UNION COUNTY SURVEY
NO. 002-2012

R38E R39E
T3S

S 44°58'29" W
OFA

S 45°01'31" E
1,000'-TO SE
LIMIT OF OFA

CENTERLINE OF RUNWAY 12-30 AND THE
SOUTHEASTERLY END OF THE RUNWAY
EXTENSION TO BE CONSTRUCTED DURING
2012/2013. THIS INTERSECTION POINT BEARS
N 31°28'50" W 464.10 FEET FROM THE
SOUTHEAST CORNER OF SECTION 24, T3S,
R38E.



400'

400'

AIRPORT LANE

24 19
25 30

(TO BE VACATED)

AREA TO BE VACATED
89,300 SQ. FT.
2.05 ACRES

S 45°01'31" E
OFA

OFA
S 44°58'29" W

REGISTERED
PROFESSIONAL
LAND SURVEYOR

OREGON
JAN. 20, 1998
MICHAEL B. POSADA
02849 LS

RENEWS 12/31/14

DATED: 12-06-12

**anderson
perry**
& associates, inc.

AREA OF ROADWAY VACATION
AIRPORT LANE (UNION COUNTY ROAD NO. 029)

LOCATED IN THE SE1/4 OF SEC. 24 AND THE NE1/4 OF SEC. 25, T3S,
R38E, AND IN THE SW1/4 OF SEC. 19 AND THE NW1/4 OF SEC. 30, T3S,
R39E, WM, UNION COUNTY, OREGON

EXHIBIT

B